

Site Layout as Existing

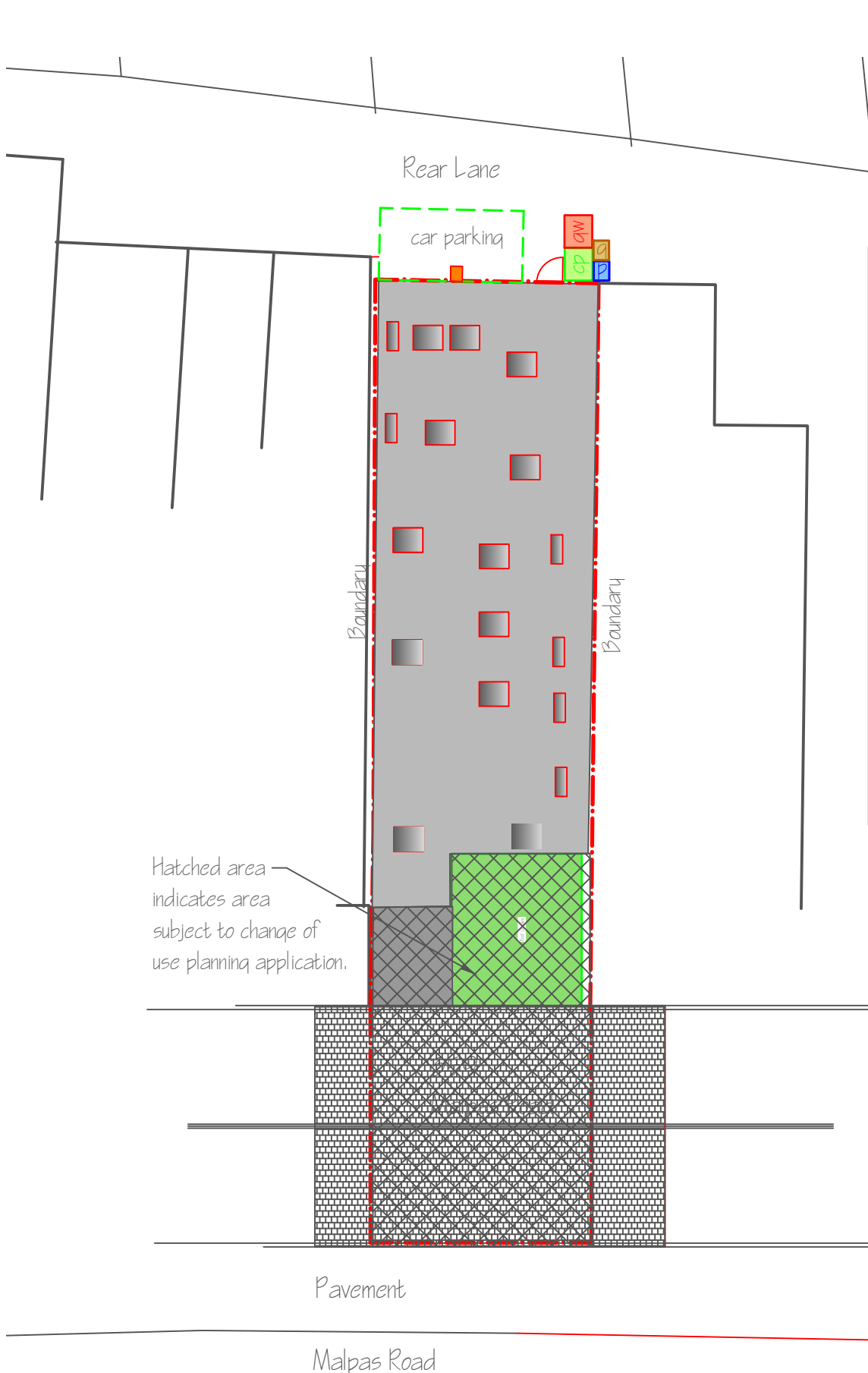

Site Layout as Proposed

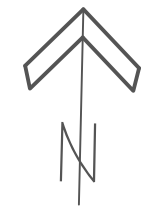

Location Plan scale
1:1250

KEY	
	Plastic/ Tins recycling bins
	General waste
	Plastic/ Tin cans
	Glass bottles/ Jars
	Pharmacy car park space with charging point.

Description	Date
A Position of existing car parking space and bin storage area added	17.09.25

Project Client Mr G. Thomas Malpas Pharmacy	Project Title Change of Use First Floor, Flat 1 359 Malpas Road, Newport	Drawing Title Site Layouts as Existing and Proposed.	THIS DRAWING IS COVERED BY COPYRIGHT WHICH REMAINS WITH HOWARD HICKS DESIGN AND MUST NOT BE REPRODUCED IN ANY FORM WITHOUT THEIR EXPRESS PERMISSION.	Scale 1:200 & 1:1250 @ A3	Date	Drawing No. PLO6	Job No. 2219	 Architectural Designers, Technologists, Building Surveyors . Project Management 21 East Road, Oakfield, Torfaen, Cwmbran, Torfaen, Wales NP44 3DW Tel 01633 521159, Mob 07984 971763
				Drawn by HH	Checked	Status Planning	Rev.No. A	