

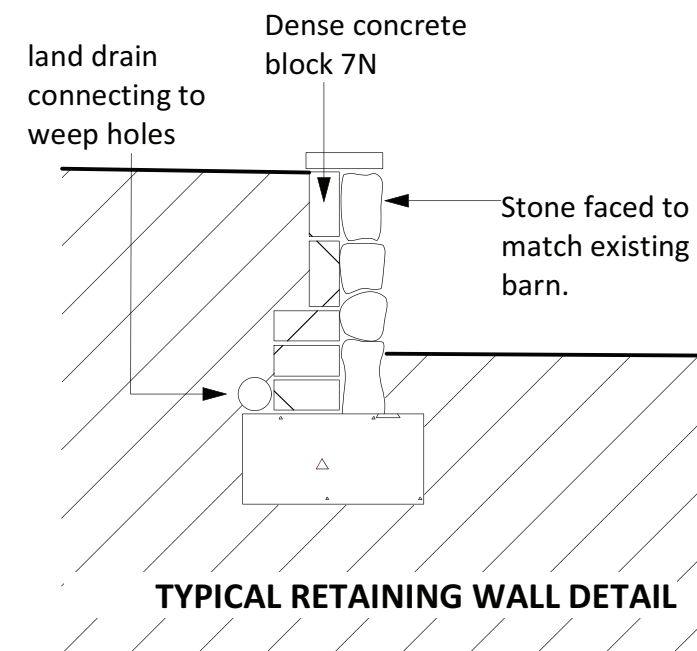

As recommended in the structural engineer's report, the raised ground at the rear of the building will be removed. This will involve constructing a low-level retaining wall, finished in stone to match the building's appearance. The wall will not be visible from the front, as the building itself obscures it. Removing this earth will reduce structural load on the building and prevent moisture ingress, both of which are essential to preserving the building's longevity. Regardless of the outcome of the application, this work is necessary for the building's protection. Due to the slope levels, there is insufficient space to grade the earth gradually without encroaching on the Ash tree's root protection zone, making the stone retaining wall the best solution.

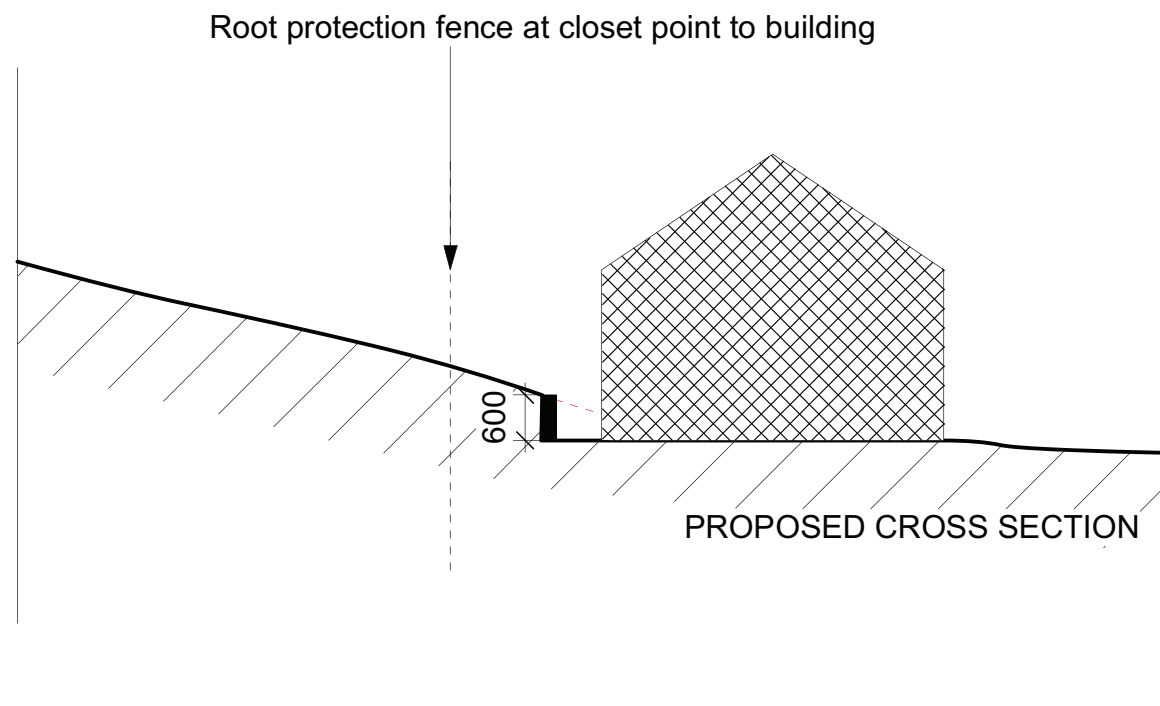

Site: Land North of Rock Cottage	Drawing No. TG2203-33	Project No. TG2203	Drawn. SG		Tý Green Ltd. Tel: 07427657573 spence@tygreen.co.uk www.tygreen.co.uk Cefn Llogell Farm, Newport, NP10 8TR	
Title: Structural enhancement strategy 2	Scale at A3 1:100 / 1:25	Date Oct 2024	Revision. -			