

- GENERAL NOTES**
1. Do Not Scale
  2. The contractor is to check and verify all buildings and site dimensions and levels, including sewer invert levels, before works start on site. The contractor is to comply in all aspects with the current building legislation, British Standards, building regulations etc.
  3. Positions of existing services/statutory undertakers apparatus adjacent to or crossing proposed excavations are to be checked by the contractor prior to starting work
  4. This drawing is to be read in conjunction with and checked against all other drawings, Engineering Details, Specification and any structural, geotechnical or other specialist document provided.
  5. Any anomaly or contradiction between any of the above is to be reported to the Engineer.
  6. This drawing is schematic for clarity only, positions of pipe runs and manholes may vary on site due to site conditions.
- ROAD AND SEWER ADOPTION NOTES**
1. All works for adoption under a Section 38 agreement shall be carried out to the approval of the Newport City Council.
  2. All works for adoption under a section 104 agreement shall be carried out to the national water council guide "sewers for adoption" 7th edition (SIA7) and the requirements of Dwr Cymru Welsh Water as the statutory sewerage undertaker and the Welsh Ministers build standard.
  3. A Section 106 application to connect must be made to DCWW, the developer shall give 21 days notice prior to connection, the works may only be undertaken by a DCWW health & safety approved contractor.
  4. An accredited contractor by the British Plastics Federation will be used to lay any adoptable plastics pipes, a copy of the accreditation certificate to be supply to DCWW before any order is placed or work commences on site.
  5. Streetlighting positions to be pegged on site and agreed by the Local Authority PRIOR to erection commencing.

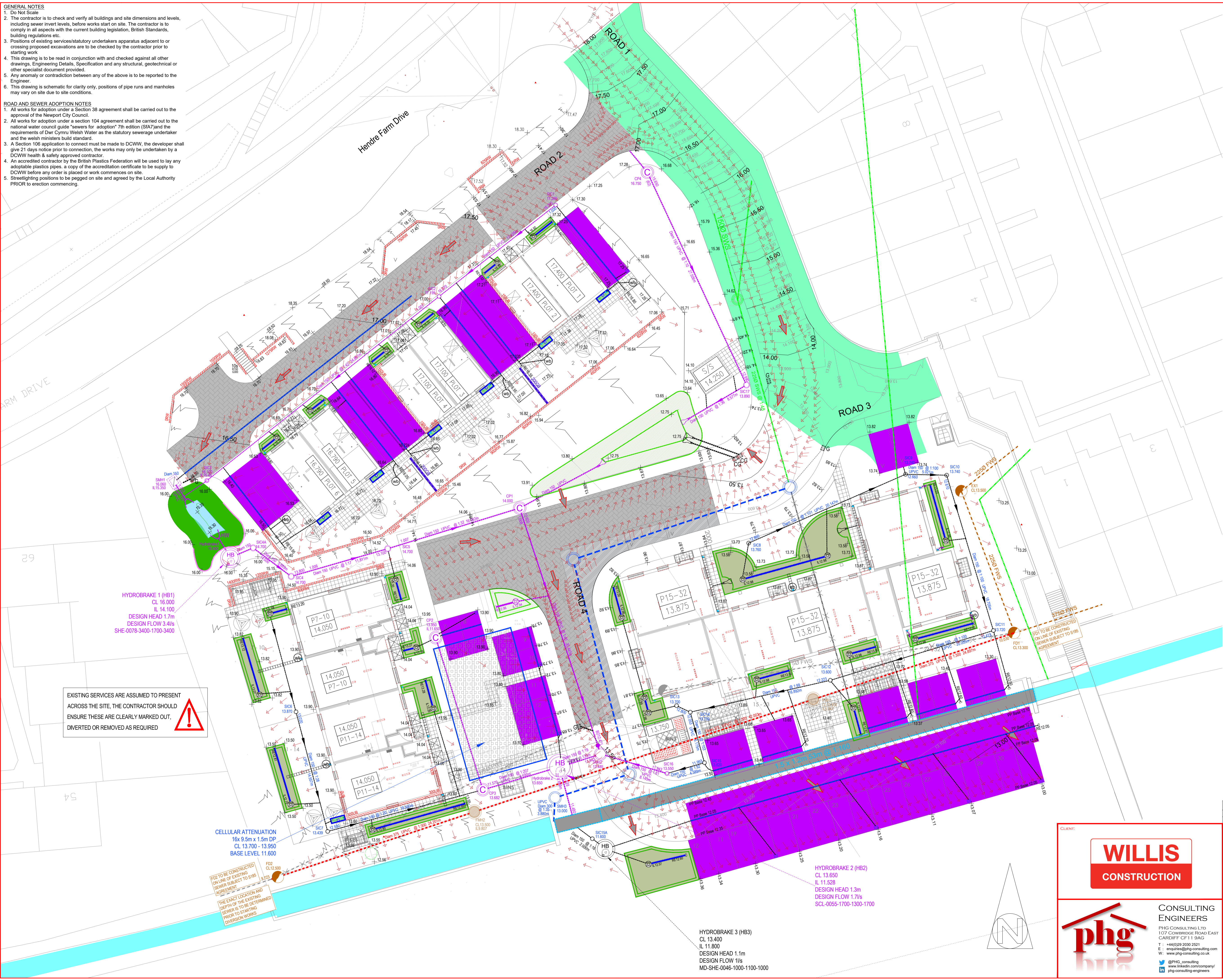

HYDROBRAKE 1 (HB1)  
 CL 16.000  
 IL 14.100  
 DESIGN HEAD 1.7m  
 DESIGN FLOW 3.4l/s  
 SHE-0078-3400-1700-3400

EXISTING SERVICES ARE ASSUMED TO PRESENT  
 ACROSS THE SITE, THE CONTRACTOR SHOULD  
 ENSURE THESE ARE CLEARLY MARKED OUT,  
 DIVERTED OR REMOVED AS REQUIRED

CELLULAR ATTENUATION  
 16x 9.5m x 1.5m DP  
 CL 13.700 - 13.950  
 BASE LEVEL 11.600

HYDROBRAKE 2 (HB2)  
 CL 13.650  
 IL 11.528  
 DESIGN HEAD 1.3m  
 DESIGN FLOW 1.7l/s  
 SCL-0055-1700-1300-1700

HYDROBRAKE 3 (HB3)  
 CL 13.400  
 IL 11.800  
 DESIGN HEAD 1.1m  
 DESIGN FLOW 1l/s  
 MD-SHE-0046-1000-1100-1000

FOI TO BE CONSTRUCTED  
 ON LINE OF EXISTING  
 SEWER SUBJECT TO S185  
 AGREEMENT

THE EXACT LOCATION AND  
 DEPTH OF THE EXISTING  
 SEWER IS TO BE DETERMINED  
 PRIOR TO STARTING  
 DIVERSION WORKS

CLIENT:

**WILLIS CONSTRUCTION**

**phg CONSULTING ENGINEERS**

PHG CONSULTING LTD  
 107 COMMERCE ROAD EAST  
 CARDIFF CF 11 9AG  
 T: +44(0)29 2030 2521  
 E: enquiries@phg-consulting.com  
 W: www.phg-consulting.co.uk

@PHG\_consulting  
 www.linkedin.com/company/  
 phg-consulting-engineers

A	14/10/2025	Additional arrows added	TOR	SID
REV	DATE	DETAILS	BY	CHK

PROJECT:				
Willis Construction Open Hearth Hendre Farm Drive, Newport				
DRAWING TITLE:				
Exceedance Flows				
DRAWN:	CHK:	STATUS:	SCALE:	
TOR	SJD	Information	1:250 @ A1	
DATE:	JOB NO.:	DWG. NO.:	REV.:	
Aug 2025	2307	111	A	