

SCHEDULE OF ACCOMMODATION:
HOUSES 1 & 2 - 5 bed dwelling houses
CAR PARKING:
- 3 resident spaces per house
PLOT SIZE: 564m²
NOTES:
All hardstandings to be permeable

DRAINAGE LEGEND:
- - - FOUL DRAINAGE RUN - EXISTING
- - - FOUL DRAINAGE RUN - PROPOSED
- - - SURFACE WATER DRAINAGE RUN

NOTES:
Refer to speed survey for reduced vision play distance

NOTE:
For Landscaping Design refer to Landarb Solutions design proposals

DRAINAGE NOTE:
Refer to Bear Structures Information for SAB & Drainage

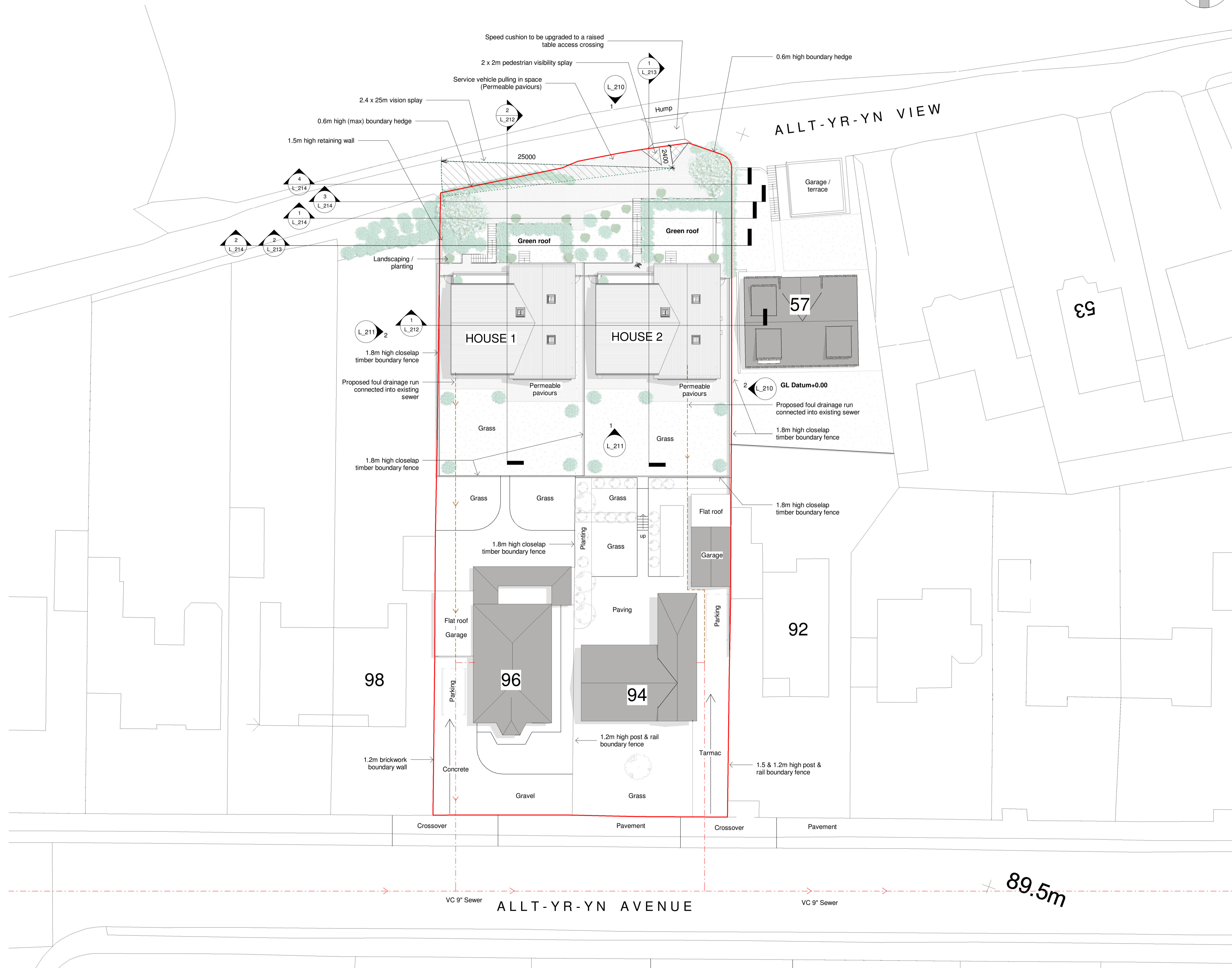

Site Plan as Proposed
1:200

Planning Issue

date	rev	name	chk	note
14/12/23	A	PL	AJ	Access, bin & cycle stores revised



Systems House 89 Heol Don Cardiff CF14 2AT
T 02920316857 M 07785582007 info@dperchitecture.co.uk

PROJECT:
Subdivision of curtilage & erection of two detached dwelling houses
94 & 96 Allt-yr-yn Avenue, Newport NP20 5DE
DRAWING TITLE:
Site Plan as Proposed

SCALE	DATE	DRAWN BY	CHECKED BY
As indicated	06/09/23	PL	NW
DRAWING NUMBER	REVISION		
P592d_L_003	A		