

46 Corporation Road – Waste Storage & Collection

Introduction

This document outlines the location of the waste and recycling storage for the proposed development. It outlines the collection day process to be adhered to by the occupiers.

Storage Location

Council provided wheelie bin, recycle bags and food bin will be stored in the front garden. The size of the wheelie bin will be determined by the council. As per the marked area on the front garden floorplan below.

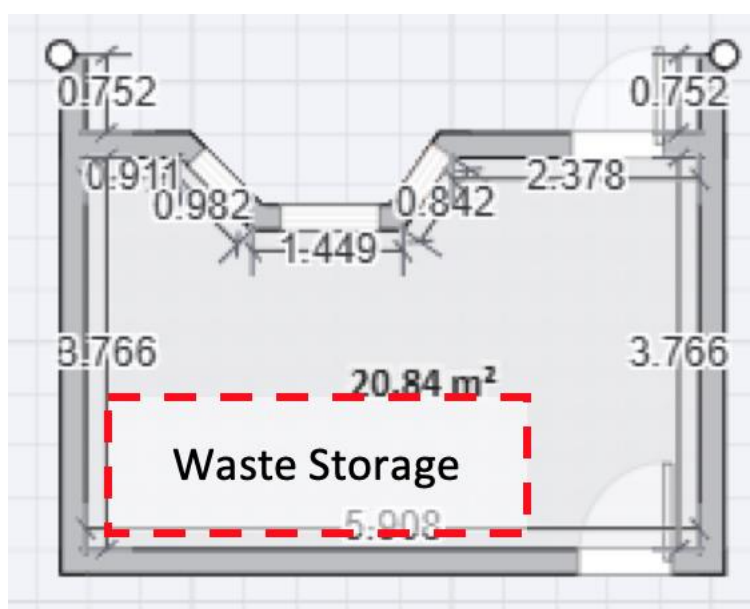

Collection Day Process

On or before collection day, when waste is allowed to be positioned on the pavement, occupiers will move all eligible waste to the kerbside for collection. Following collection, all waste storage items will be returned to the front garden storage location.

Replenishing Bin Liners

Tenants will be responsible for replenishing bin liners. Tenants will be verbally and electronically notified of the process to order new bin lines, which is to email collections@newport.gov.uk to arrange collection.

Sharing the Process to Tenants

All information contained in this document related to waste storage, replenishing bin liners, and collection day process will be verbally and electronically communicated to the tenants as part of the onboarding process.

Reference

<https://www.newport.gov.uk/documents/Planning-Documents/Supplementary-Planning-Guidance/2020/Waste-Storage-and-Collection-SPG-Adopted-Jan-2020.pdf>