

9.0m Long Rigid - Left In

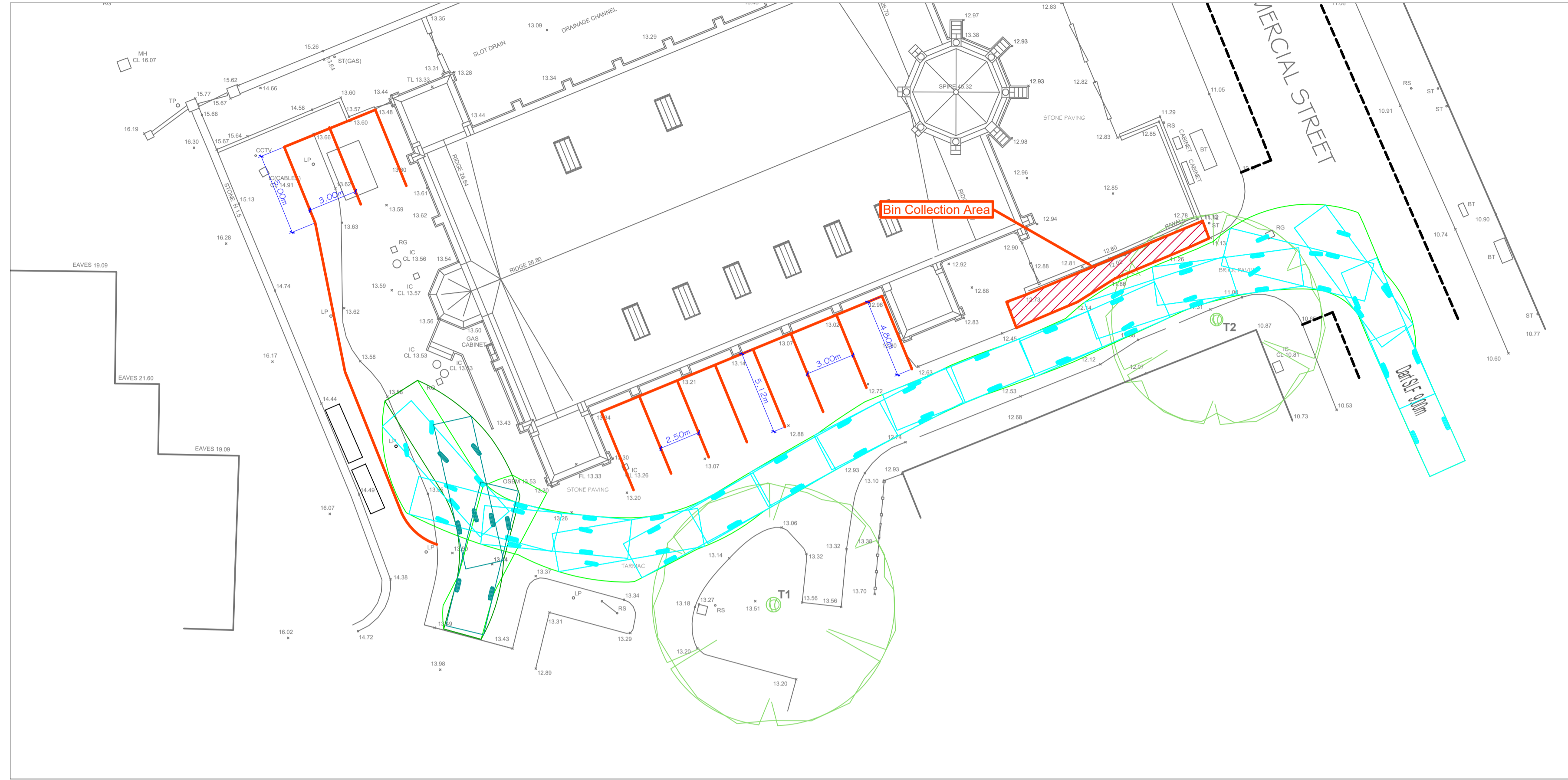

9.0m Long Rigid - Right In



Notes
Based on topographical survey and proposed layout details provided by applicant.
Refuse vehicle specification taken from Newport City Council's Waste Storage and Collection Supplementary Planning Guidance; January 2020

Vehicle details:

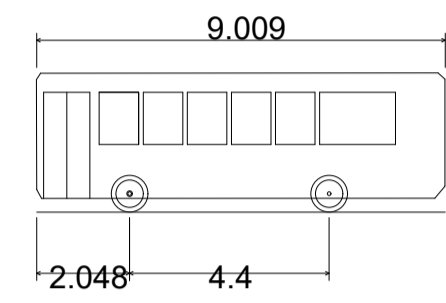

Dart SLF 9.00m
Overall Length 9.009m
Overall Width 2.048m
Overall Body Height 3.067m
Min Body Ground Clearance 0.302m
Track Width 2.300m
Lock to lock time 4.00s
Kerb to kerb Turning Radius 7.383m

9.0m Long Rigid - Turn & Left Out

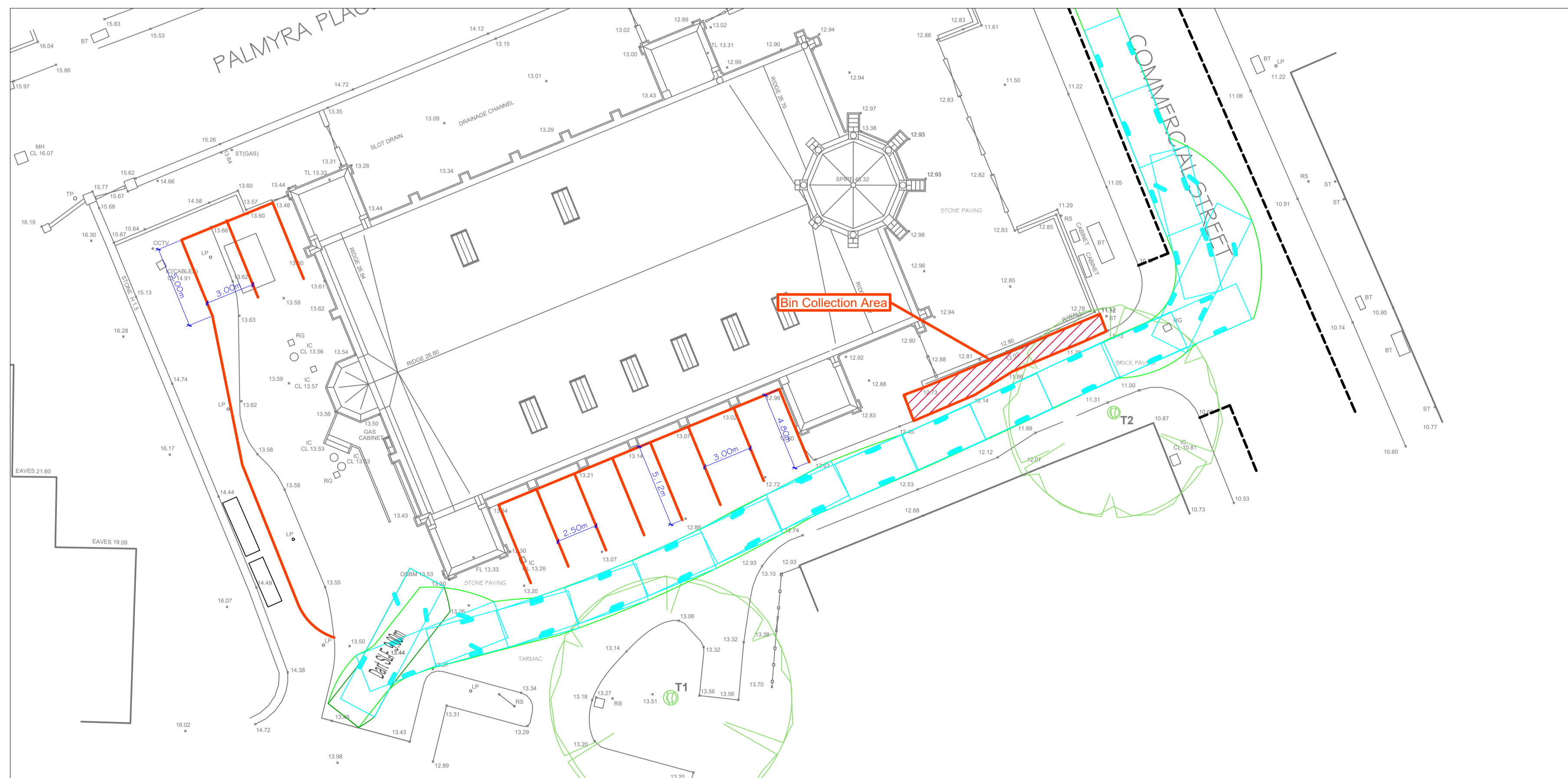

9.0m Long Rigid - Right Out

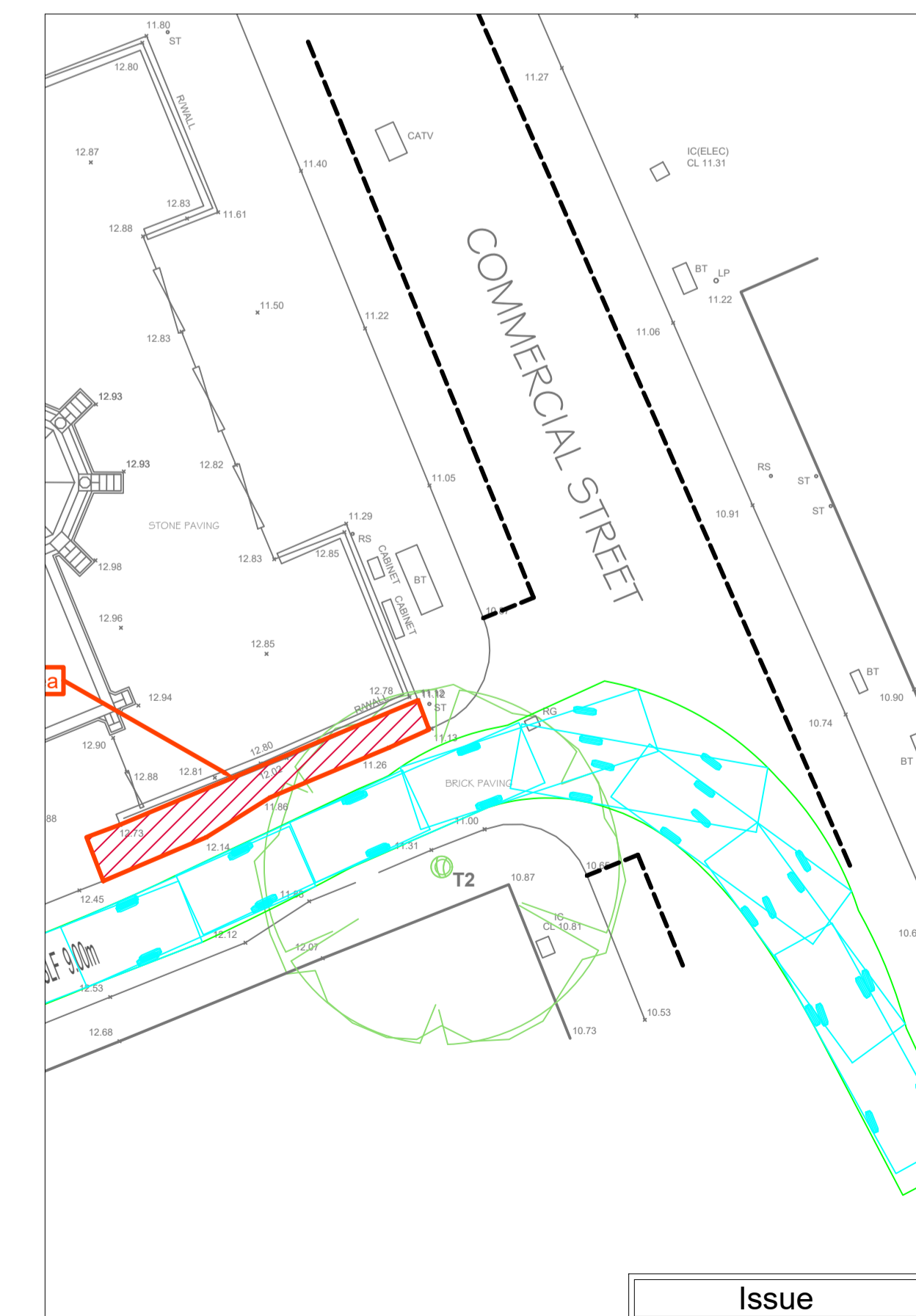

Rev	By	Chkd	Apprvd	Date	Description

Client
Mr A Brown

Project
St Paul's Church
Commercial Street, Newport

Drawing
**9.0m Long Rigid
Vehicle Tracking**

Drawn by: JH Date: 18.03.2025
Checked by: JH Date: 18.03.2025
Approved by: JH Date: 18.03.2025

Drawing No. 2501DWG03 Revision

Drawing Scale: 1:200 @ A1