

- GENERAL NOTES**
1. Do Not Scale
 2. The contractor is to check and verify all buildings and site dimensions and levels, including sewer invert levels, before works start on site. The contractor is to comply in all aspects with the current building legislation, British Standards, building regulations etc.
 3. Positions of existing services/statutory undertakers apparatus adjacent to or crossing proposed excavations are to be checked by the contractor prior to starting work
 4. This drawing is to be read in conjunction with and checked against all other drawings, Engineering Details, Specification and any structural, geotechnical or other specialist document provided.
 5. Any anomaly or contradiction between any of the above is to be reported to the Client.
 6. This drawing is schematic for clarity only, positions of pipe runs and manholes may vary on site due to site conditions.

- ROAD AND SEWER ADOPTION NOTES**
1. All works for adoption under a Section 38 agreement shall be carried out to the approval of the Newport Council.
 2. All works for adoption under a section 104 agreement shall be carried out to the national water council guide "sewers for adoption" 7th edition (S/A7) and the requirements of Dwr Cymru Welsh Water as the statutory sewerage undertaker and the Welsh ministers build standard.
 3. A Section 106 application to connect must be made to DCWW, the developer shall give 21 days notice prior to connection, the works may only be undertaken by a DCWW health & safety approved contractor.
 4. An accredited contractor by the British Plastics Federation will be used to lay any adoptable plastics pipes, a copy of the accreditation certificate to be supplied to DCWW before any order is placed or work commences on site.
 5. Streetlighting positions to be pegged on site and agreed by the Local Authority PRIOR to erection commencing.

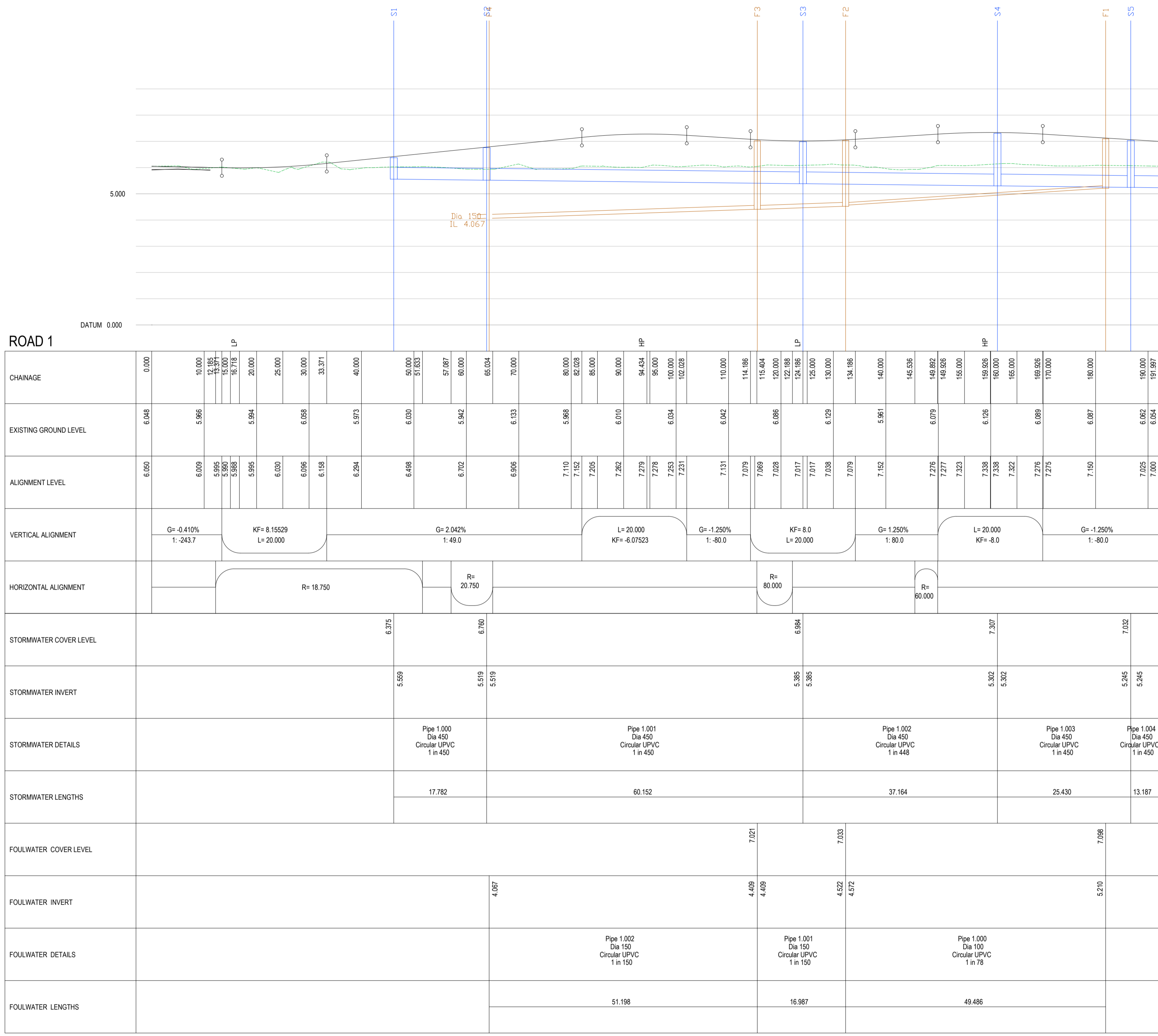

ROAD 1 AND DRAINAGE LONGITUDINAL SECTION
SCALE 1:500 Horizontal 1:100 Vertical

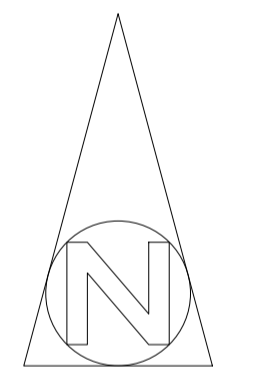

REV.	DATE	DETAILS	BY	CHK
P02	08.04.25	Road levels amended	TOR	SJD
7	05.12.24	First Issue	TOR	SJD

CLIENT:



phg CONSULTING ENGINEERS

PHG CONSULTING LTD
107 COWBRIDGE ROAD EAST
CARDIFF CF11 9AG

T: +44(0)29 200 2101
E: enquiries@phg-consulting.com
W: www.phg-consulting.com

X @PHG_consulting
www.linkedin.com/company/phg-consulting-engineers

PROJECT: **Traston Road, Newport**

DRAWING TITLE: **Longitudinal Section**

DRG NO: PROJECT ORIGIN VOLUME LEVEL TYPE ROLE NUMBER
2595-PHG-XX-XX-DR-C-0003

DRAWN	CHK	PHG JOB NO.	SCALED AT 1:
TOR	SJD	2595	1:200
DATE:	SUITABILITY:	REV:	STATUS:
05.12.24	Planning	P02	S1