

Notes:

1. THE COPYRIGHT OF THIS DRAWING BELONGS TO CMB DESIGN AND BUILD LTD. IT SHOULD NOT BE REPRODUCED OR DISCLOSED TO THIRD PARTIES WITHOUT PERMISSION OF CMB DESIGN AND BUILD LTD.
2. DO NOT SCALE THIS DRAWING
3. MEASUREMENTS IN MM UNLESS STATED. ANY DISCREPANCIES TO BE BROUGHT TO ATTENTION OF CMB DESIGN AND BUILD IMMEDIATELY.

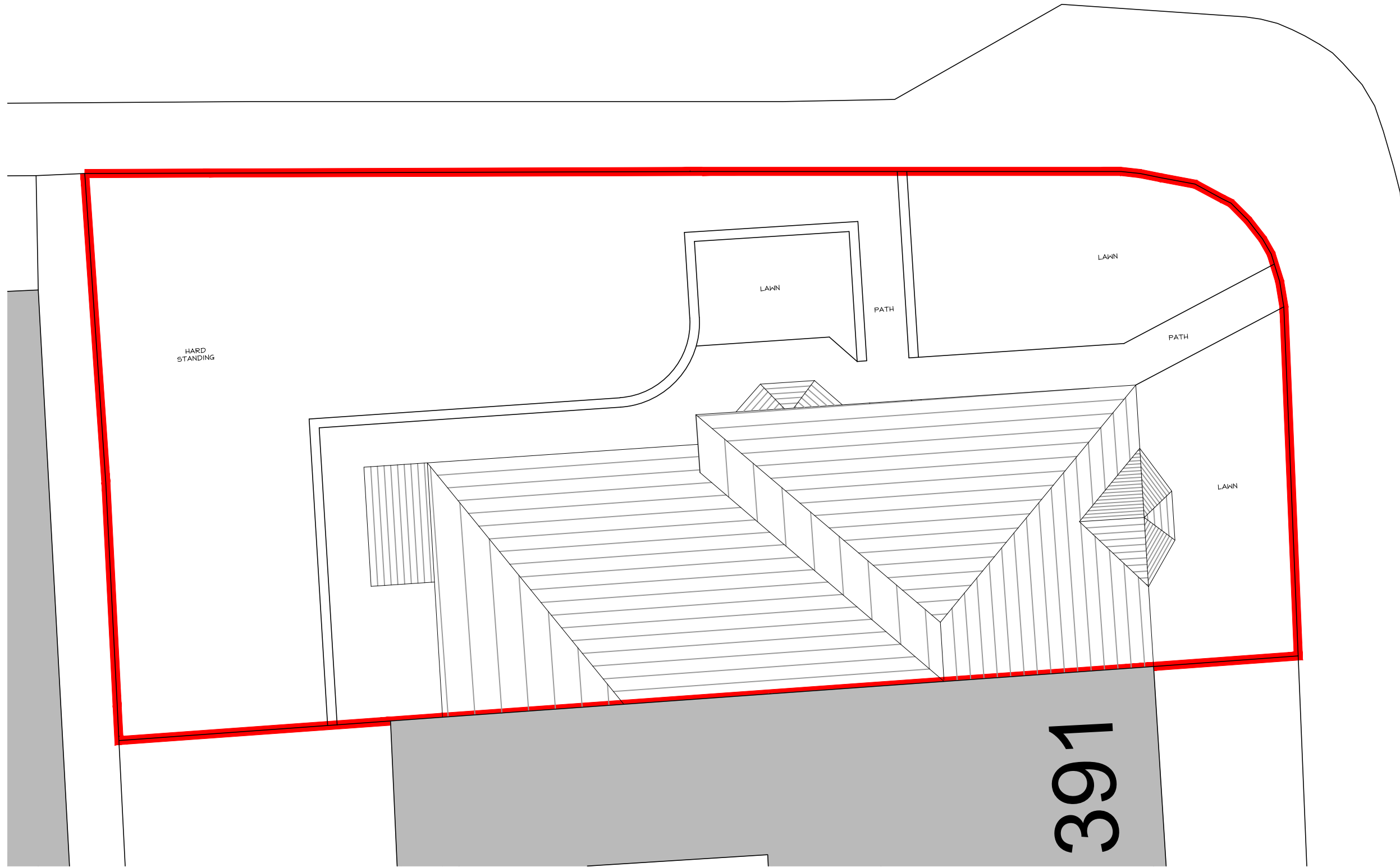

EXISTING SITE PLAN  
1:100 @ A3

|      |              |     |       |
|------|--------------|-----|-------|
| REV: | DESCRIPTION: | BY: | DATE: |
|------|--------------|-----|-------|

|         |                     |
|---------|---------------------|
| STATUS: | PLANNING SUBMISSION |
|---------|---------------------|



CLIENT:  
MIDPOINT PROPERTIES  
KINGSHILL HOUSE  
NEWPORT  
NP20 5EA

AGENT:  
CMB DESIGN & BUILD  
info@cmbdesignandbuild.co.uk  
www.cmbdesignandbuild.co.uk  
07512 520 833

SITE:  
391 CHEPSTOW ROAD  
NEWPORT, NP19 8HL

TITLE:  
EXISTING SITE PLAN

|                            |                     |                |                 |
|----------------------------|---------------------|----------------|-----------------|
| SCALE AT A3:<br>1:100 @ A3 | DATE:<br>JAN 26'    | DRAWN:<br>CMB  | CHECKED:<br>CMB |
| PROJECT NO:<br>26_0474     | DRAWING NO:<br>0503 | REVISION:<br>* |                 |