

Longitudinal Site Section 1-1
1 : 125

FINISHES KEY:

- A : BROWN CONCRETE ROOFING TILES
- B : ANTHRACITE GREY WINDOWS & DOORS
- C : TIMBER CLADDING
- D : OFF WHITE SMOOTH FACED RENDERED EXTERNAL WALLS
- E : STONEMWORK EXTERNAL WALLS
- F : BLACK RAINWATER GOODS ON BLACK FASCIA

NOTE:
For Landscaping Design refer to Landarb Solutions design proposals

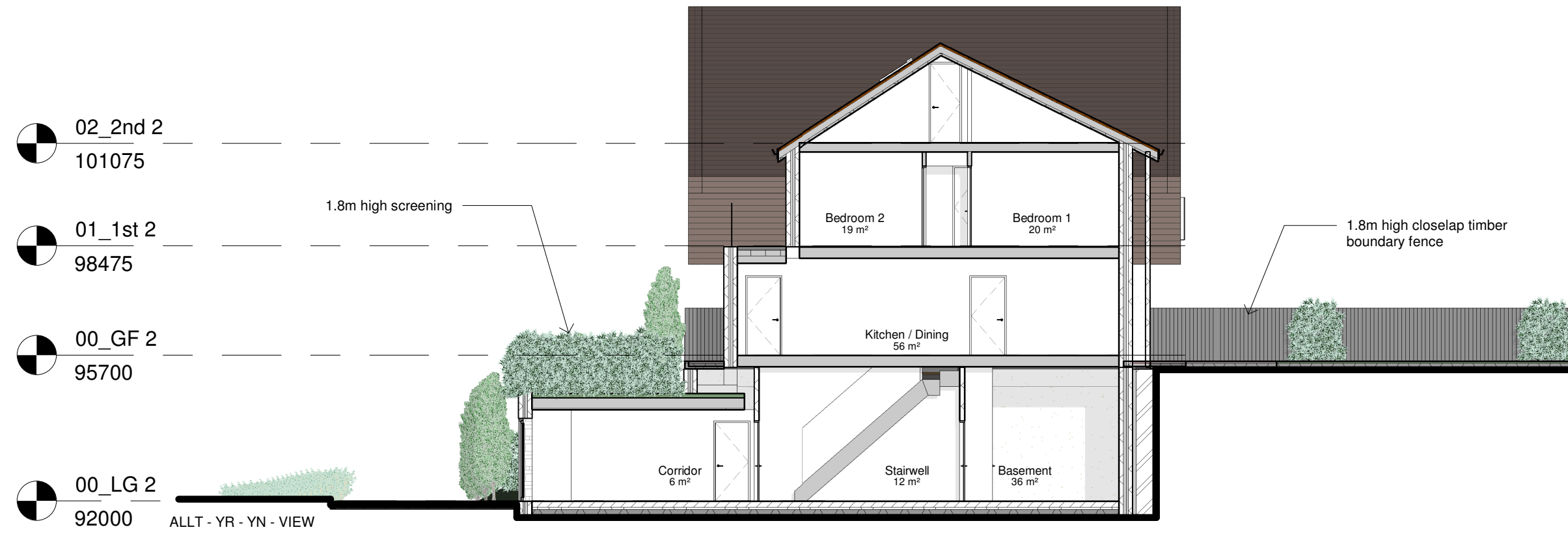

Section A-A
1 : 125

Planning Issue

date	rev	name	chk	note



Architectural Design - Feasibility - Planning - Building Control - Construction Details - Sustainable Design
Systems House 89 Heol Don Cardiff CF14 2AT
T 02920316857 M 07785582007 info@dlparchitecture.co.uk

PROJECT
Subdivision of curtilage & erection of two detached dwelling houses
94 & 96 Allt-yr-yn Avenue, Newport NP20 5DE
DRAWING TITLE
Site Sections 1 of 2 as Proposed

SCALE	DATE	DRAWN BY	CHECKED BY
As indicated	06/09/23	PL	AJ
DRAWING NUMBER	REVISION		
P592d L_212			