

Responsibility is not accepted for errors made by others in scaling from this drawing. All construction information should be taken from figured dimensions only.

0mm 50mm

A3 Original Sheet Size

**FINISHES KEY:**

- A : BROWN CONCRETE ROOFING TILES
- B : ANTHRACITE GREY WINDOWS & DOORS
- C : TIMBER CLADDING
- D : OFF WHITE SMOOTH FACED RENDERED EXTERNAL WALLS
- E : STONEMWORK EXTERNAL WALLS
- F : BLACK RAINWATER GOODS ON BLACK FASCIA

**NOTE:**

For Landscaping Design refer to Landarb Solutions design proposals

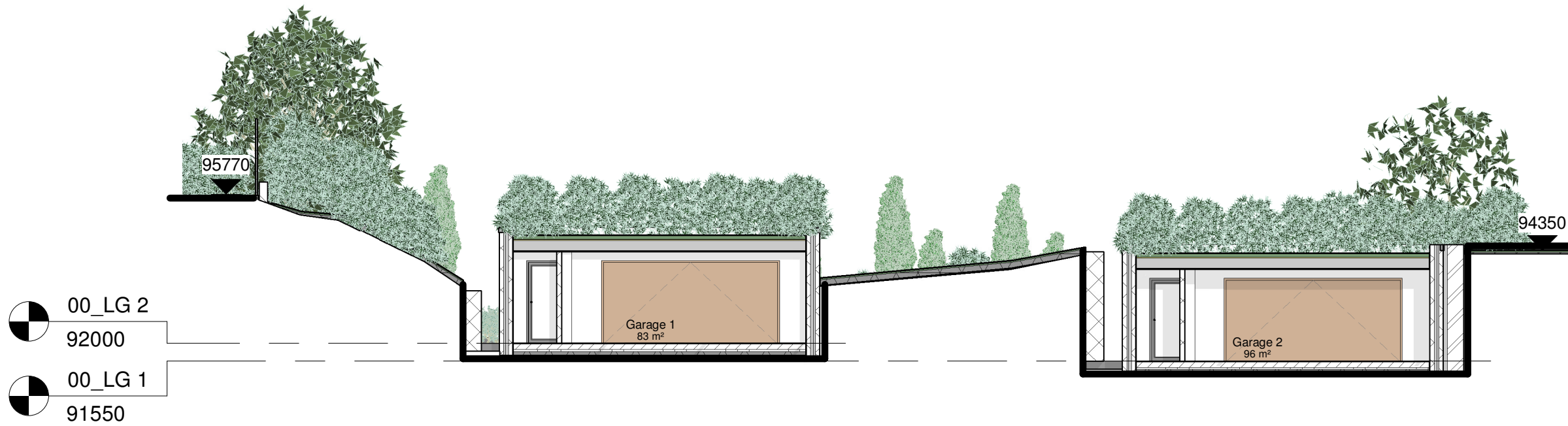

Longitudinal Site Section 2-2  
1 : 125

Planning Issue

date	rev	name	chk	note



Architectural Design - Feasibility - Planning - Building Control - Construction Details - Sustainable Design  
Systems House 89 Heol Don Cardiff CF14 2AT  
T 02920316857 M 07785582007 info@dlparchitecture.co.uk

PROJECT  
Subdivision of curtilage & erection of two detached dwelling houses  
94 & 96 Allt-yr-yn Avenue, Newport NP20 5DE

DRAWING TITLE  
Site Sections 2 of 2 as Proposed

SCALE	DATE	DRAWN BY	CHECKED BY
As indicated	06/09/23	PL	AJ

DRAWING NUMBER	REVISION
P592d L_213	

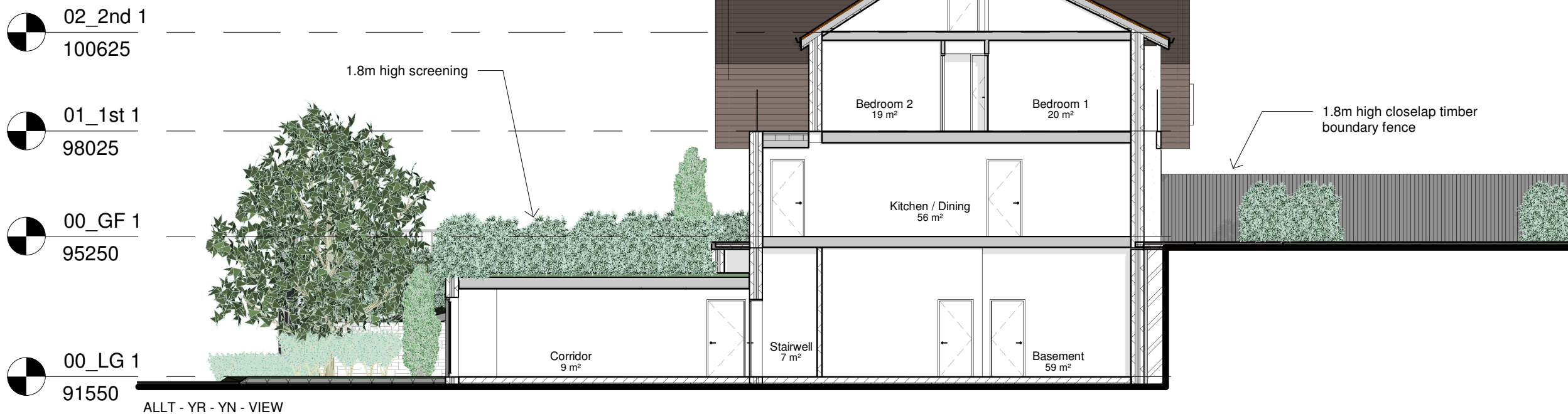

ALLT - YR - YN - VIEW

Section B-B  
1 : 125