



Geotechnical & Geoenvironmental Specialists

Newport

Published 1983

Source map scale - 1:10,000

These maps were produced by the Russian military during the Cold War between 1950 and 1997, and cover 103 towns and cities throughout the U.K. The maps are produced at 1:25,000, 1:10,000 and 1:5,000 scale, and show detailed land use, with colour-coded areas for development, green areas, and non-developed areas. Buildings are coloured black and important building uses (such as hospitals, post offices, factories etc.) are numbered, with a numbered key describing their use. They were produced by the Russians for the benefit of navigation, as well as strategic military sites and transport hubs, for use if they were to have invaded the U.K. The detailed information provided indicates that the areas were surveyed using land-based personnel, on the ground, in the cities that are mapped.

Map Name(s) and Date(s)

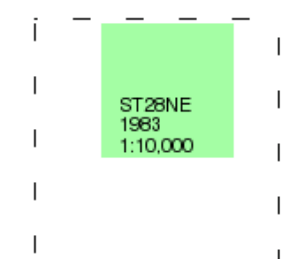

Russian Map - Slice A

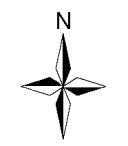
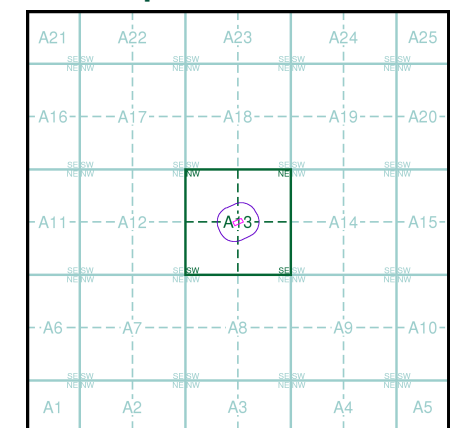

Order Details

Order Number: 362873452_1_1
 Customer Ref: TF-24-614-CA
 National Grid Reference: 327710, 188520
 Slice: A
 Site Area (Ha): 0.16
 Search Buffer (m): 1000

Site Details

Site at 327700, 188530



Tel: 0844 844 9952
 Fax: 0844 844 9951
 Web: www.envirocheck.co.uk

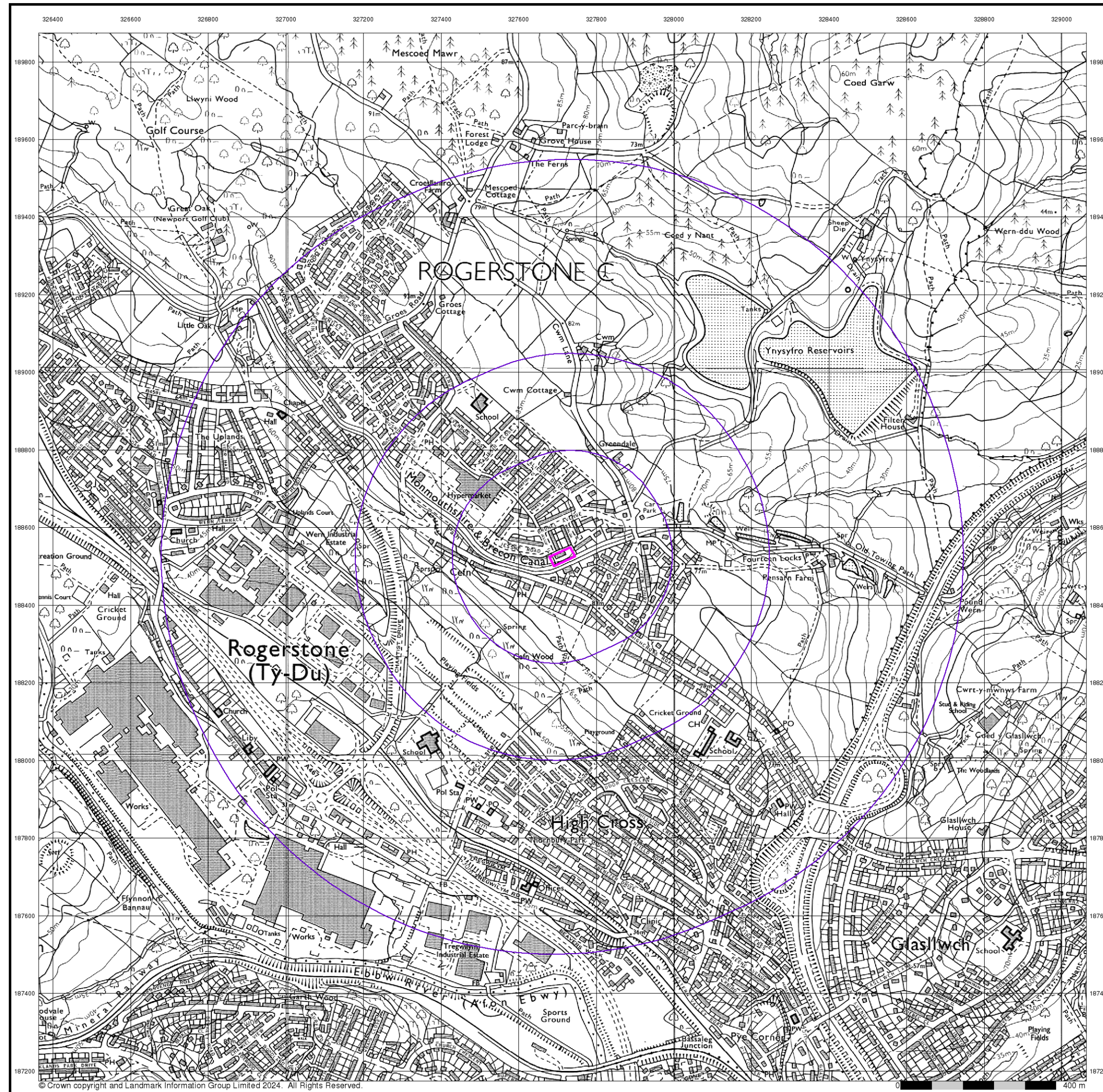

Geotechnical & Geoenvironmental Specialists

Ordnance Survey Plan

Published 1992

Source map scale - 1:10,000

The historical maps shown were reproduced from maps predominantly held at the scale adopted for England, Wales and Scotland in the 1840's. In 1854 the 1:2,500 scale was adopted for mapping urban areas; these maps were used to update the 1:10,560 maps. The published date given therefore is often some years later than the surveyed date. Before 1938, all OS maps were based on the Cassini Projection, with independent surveys of a single county or group of counties, giving rise to significant inaccuracies in outlying areas. In the late 1940's, a Provisional Edition was produced, which updated the 1:10,560 mapping from a number of sources. The maps appear unfinished - with all military camps and other strategic sites removed. These maps were initially overprinted with the National Grid. In 1970, the first 1:10,000 maps were produced using the Transverse Mercator Projection. The revision process continued until recently, with new editions appearing every 10 years or so for urban areas.

Map Name(s) and Date(s)

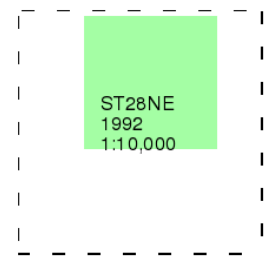

Historical Map - Slice A

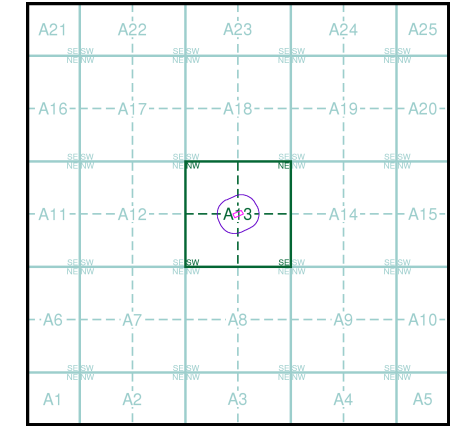

Order Details

Order Number: 362873452_1_1
 Customer Ref: TF-24-614-CA
 National Grid Reference: 327710, 188520
 Slice: A
 Site Area (Ha): 0.16
 Search Buffer (m): 1000

Site Details

Site at 327700, 188530



Tel: 0844 844 9952
 Fax: 0844 844 9951
 Web: www.envirocheck.co.uk

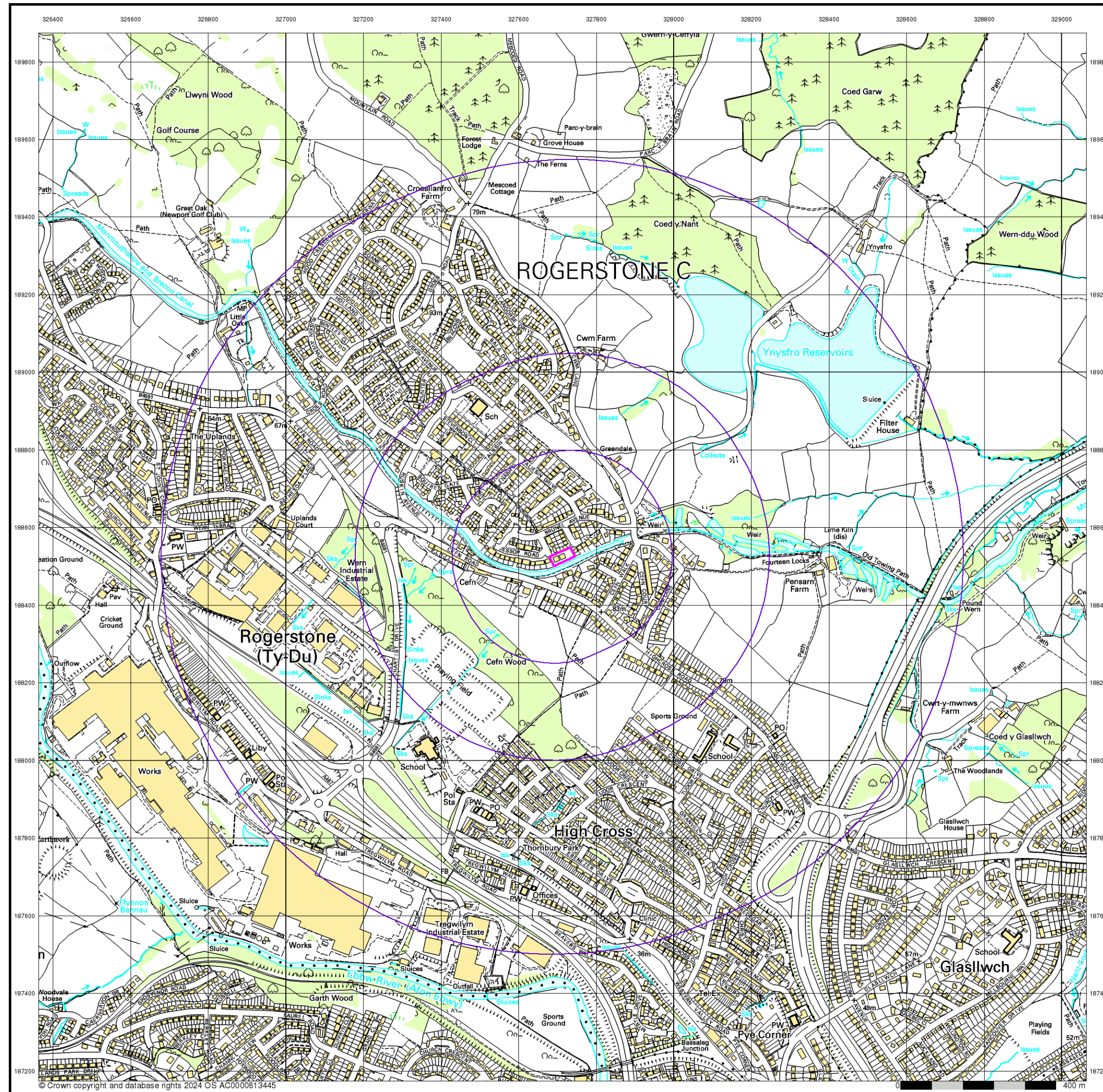

Geotechnical & Geoenvironmental Specialists

10k Raster Mapping

Published 1999

Source map scale - 1:10,000

The historical maps shown were produced from the Ordnance Survey's 1:10,000 colour raster mapping. These maps are derived from Landplan which replaced the old 1:10,000 maps originally published in 1970. The data is highly detailed showing buildings, fences and field boundaries as well as all roads, tracks and paths. Road names are also included together with the relevant road number and classification. Boundary information depiction includes county, unitary authority, district, civil parish and constituency.

Map Name(s) and Date(s)

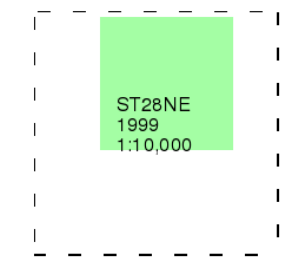

Historical Map - Slice A

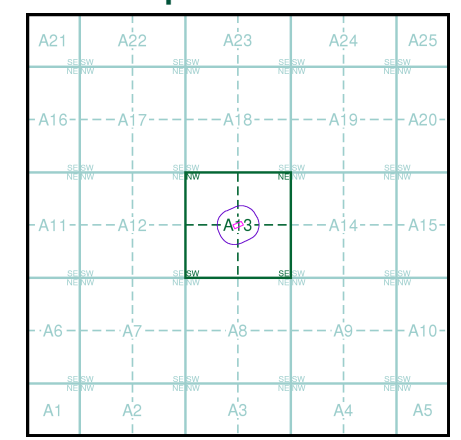

Order Details

Order Number: 362873452_1_1
 Customer Ref: TF-24-614-CA
 National Grid Reference: 327710, 188520
 Slice: A
 Site Area (Ha): 0.16
 Search Buffer (m): 1000

Site Details

Site at 327700, 188530



Tel: 0844 844 9952
 Fax: 0844 844 9951
 Web: www.envirocheck.co.uk



Geotechnical & Geoenvironmental Specialists

10k Raster Mapping

Published 2006

Source map scale - 1:10,000

The historical maps shown were produced from the Ordnance Survey's 1:10,000 colour raster mapping. These maps are derived from Landplan which replaced the old 1:10,000 maps originally published in 1970. The data is highly detailed showing buildings, fences and field boundaries as well as all roads, tracks and paths. Road names are also included together with the relevant road number and classification. Boundary information depiction includes county, unitary authority, district, civil parish and constituency.

Map Name(s) and Date(s)

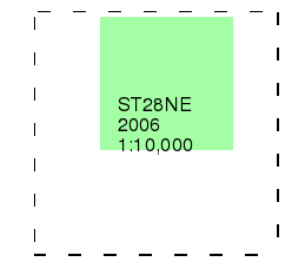

Historical Map - Slice A

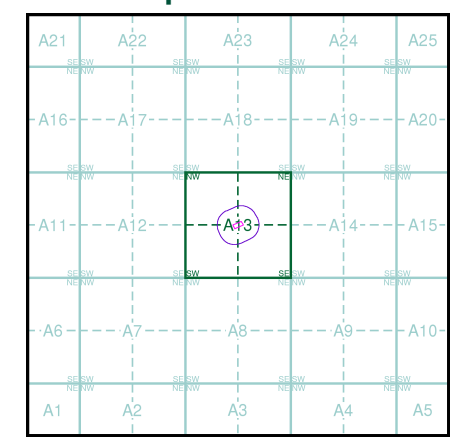

Order Details

Order Number: 362873452_1_1
 Customer Ref: TF-24-614-CA
 National Grid Reference: 327710, 188520
 Slice: A
 Site Area (Ha): 0.16
 Search Buffer (m): 1000

Site Details

Site at 327700, 188530



Tel: 0844 844 9952
 Fax: 0844 844 9951
 Web: www.envirocheck.co.uk

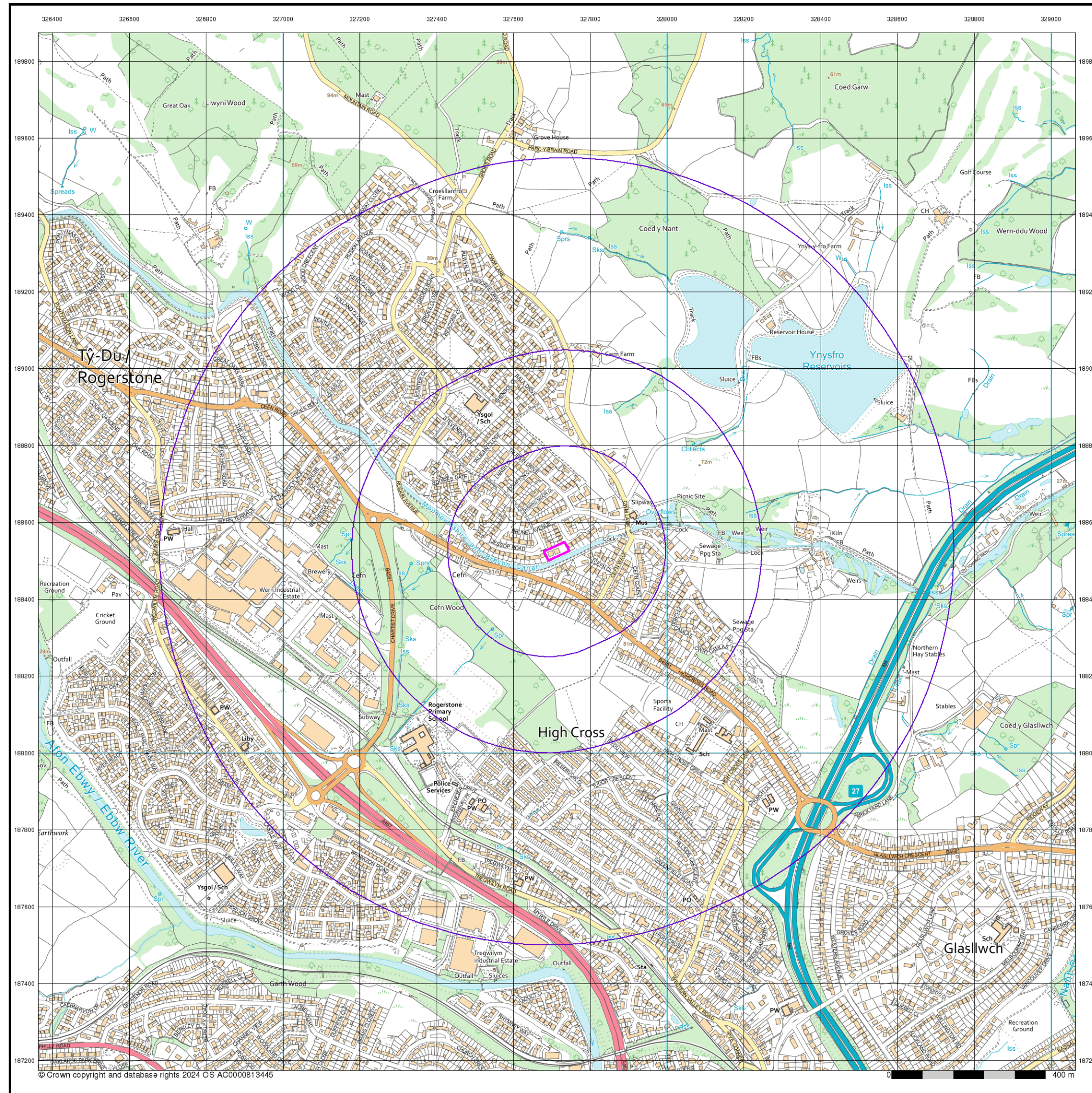

Geotechnical & Geoenvironmental Specialists

VectorMap Local

Published 2024

Source map scale - 1:10,000

VectorMap Local (Raster) is Ordnance Survey's highest detailed 'backdrop' mapping product. These maps are produced from OS's VectorMap Local, a simple vector dataset at a nominal scale of 1:10,000, covering the whole of Great Britain, that has been designed for creating graphical mapping. OS VectorMap Local is derived from large-scale information surveyed at 1:1250 scale (covering major towns and cities), 1:2500 scale (smaller towns, villages and developed rural areas), and 1:10 000 scale (mountain, moorland and river estuary areas).

Map Name(s) and Date(s)

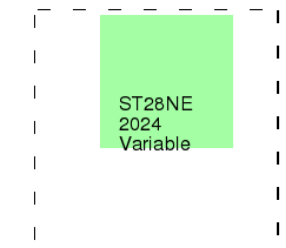

Historical Map - Slice A

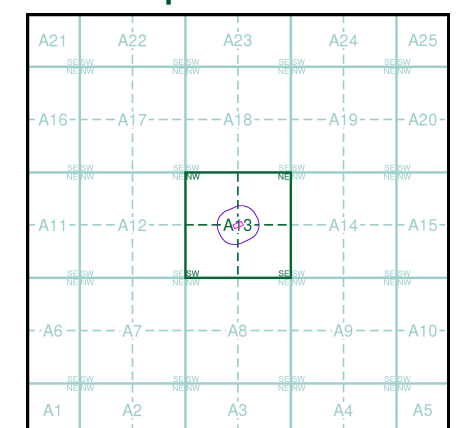

Order Details

Order Number: 362873452_1_1
 Customer Ref: TF-24-614-CA
 National Grid Reference: 327710, 188520
 Slice: A
 Site Area (Ha): 0.16
 Search Buffer (m): 1000

Site Details

Site at 327700, 188530



Tel: 0844 844 9952
 Fax: 0844 844 9951
 Web: www.envirocheck.co.uk