

Green Infrastructure Statement

16-18 Cambrian Road, Newport. NP20 4AB

David Palmer 5th August 2025

The proposed development site is a three-storey commercial property on Cambrian Road, Newport. The front of the property opens directly on to the street. There is a small courtyard at the rear of the property. There is no existing planting or green infrastructure assets associated with the property.

The location is within the Town Centre Conservation Area of Newport, on a principal thoroughfare running parallel with High Street. The rear area of the two streets is characterised by a network of commercial extensions and small courtyards. There are no gardens nor green infrastructure assets. The nearest green infrastructure assets to the proposed development site are street trees over 100m away the railway station and on neighbouring streets. The River Usk is over 250m away.

The development proposal will not affect any existing green infrastructure assets. The proposal will provide net benefit for biodiversity by including 2No swift boxes in the top LH corner of the East Courtyard elevation, where an existing window will be bricked up, as shown on the submitted plan Drawing No **1618CR-SN-PROPSECA** - Titled **PROPOSED SECTION 'A' - EAST ELEVATION**

Extract below v

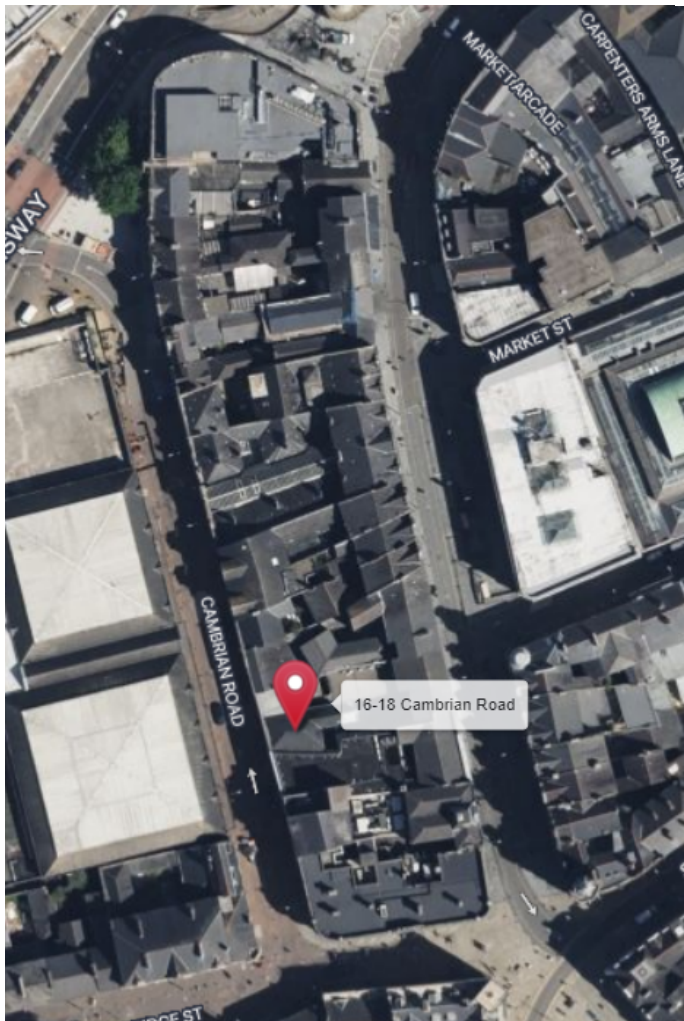
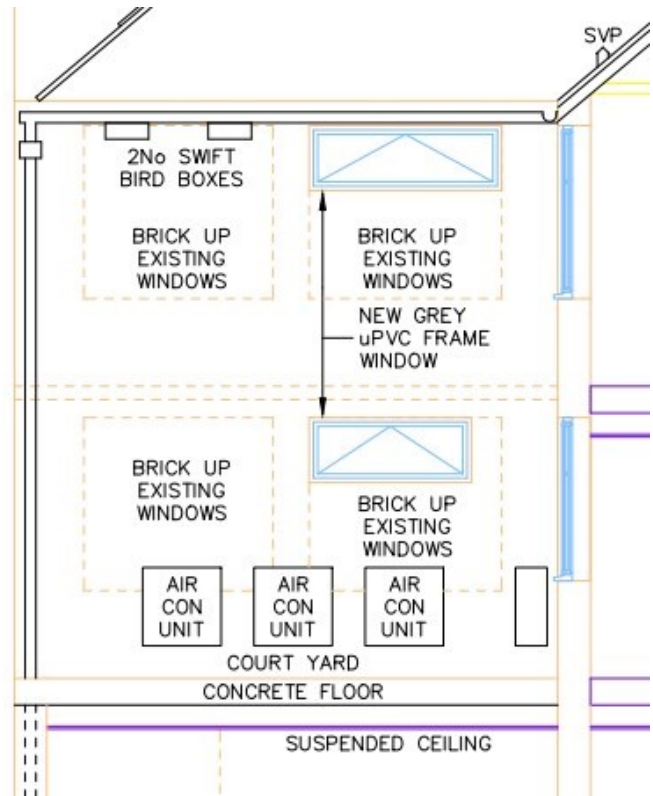

Site Location



Front Elevation – Photo.



Rear Courtyard photo showing where existing window will be blocked up and 2No swift boxes provided. (Top left hand corner.)



- **SLATE ROOF:** Slate-effect roof overhang to protect entrance
- **HEAVY DUTY:** Heavy duty reformed slate roof manufactured by SIG Roofing
- **MADE IN BRITAIN:** Hand built in the UK from sustainable sourced timber
- **ADAPTABLE ENTRANCE:** Entrance panel can be installed vertically or horizontally
- **SOLID DESIGN:** Solid white wood construction with zero ply or plastic
- **REMOVABLE ROOF:** Roof unscrews for yearly cleaning
- **SECURE FITTING:** Steel brackets for secure fixing
- **FLAT-PACK:** Arrives in a compact package ready for assembly

Dimensions

- Width: 300mm
- Depth: 200mm (inc. roof overhang) | 160mm (exc. roof overhang)
- Height: 120mm

Home and Roost Swift nest box x 2.