

- GENERAL NOTES**
1. Do not scale for construction purposes. Work to figured dimensions only.
 2. All dimensions are in millimeters unless otherwise stated.
 3. All dimensions shall be verified on site before proceeding with works.
 4. The designer must be notified in writing of any discrepancies.
 5. Any areas indicated on this sheet are approximate and indicative only.
 6. This information includes mapping data licensed from Ordnance Survey and is strictly for use in preparation of information for this project. The Ordnance Survey copyright acknowledgement must be displayed on any document containing this data. At the end of its use any Ordnance Survey data supplied by the designer must be deleted and all paper copies destroyed.

DRAWING NOTES

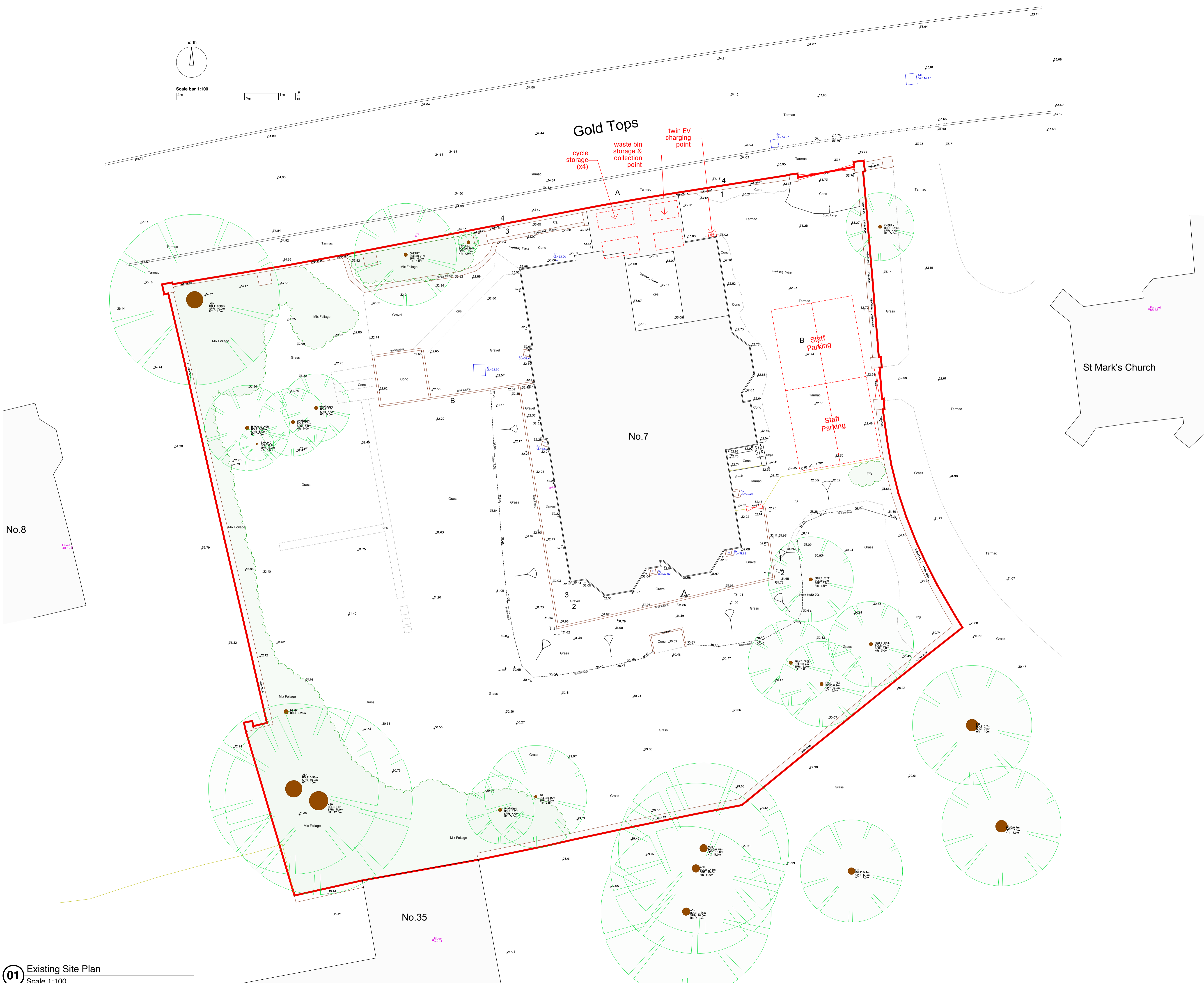
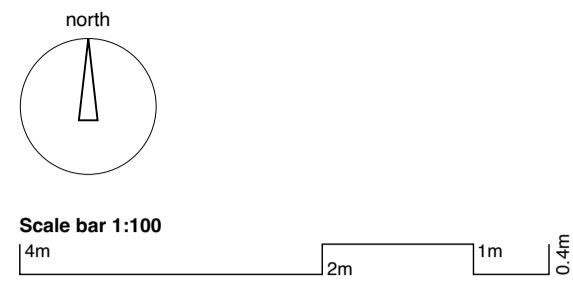

No.8

Gold Tops

cycle storage (x4)

waste bin storage & collection point

twin EV charging point

St Mark's Church

No.7

00	14.03.25	FIRST ISSUE	NA
Rev	Date	Reason For Issue	Chk'd

AYRES HAYNES ARCHITECTS
Ground Floor | 3 Sandy Court | Ashleigh Way | Plymouth | PL9 9SJ

Client
Modus Care Ltd

Project Title
**Ty Albero,
7 Gold Tops,
Newport,
NP20 4PH.**

Drawing Title
Existing Site Plan

Drawing Status
Planning submission

Scale @ A1	Date	Drawn by
1:100	29.04.25	JB

Drawing reference	2518	2	PL 03	00
Project Number	RIBA Stage	Drawing number	Revision	