

Abbey Sanders Ecology

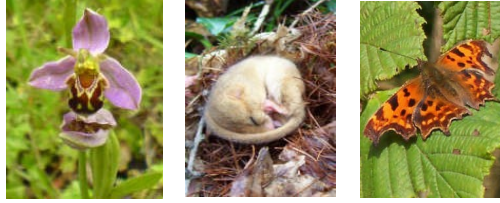

GREENMOOR KENNELS ST BRIDES WENTLOOGE

PROPOSED DWELLING

ECOLOGICAL APPRAISAL 2022-2025

Abbey Sanders CEcol CEnv MCIEEM

For

Helen Thomas

Issue Details:

Author:	Abbey Sanders MCIEEM CEcol CEnv, Principal Ecologist	9 th December 2022
Review:	Andrew Sanders CMLI, Associate	12 th December 2022
Issue: DRAFT	Abbey Sanders	12 th December 2022
Issue: Complete	Abbey Sanders	12 th December 2022
Author: Amended scheme and update assessment	Abbey Sanders MCIEEM CEcol CEnv, Principal Ecologist	20 th November 2025
Review:	Andrew Sanders CMLI, Associate	8 th December 2025
Issue: Complete	Abbey Sanders	12 th December 2025

<u>LIST OF CONTENTS</u>	<u>Page No.</u>
SUMMARY	4
1.0 INTRODUCTION	5
2.0 SPECIES ECOLOGY, LEGISLATION & POLICY	7
3.0 METHODS	12
4.0 RESULTS	13
5.0 ASSESSMENT & CONCLUSIONS	22
7.0 REFERENCES	31
APPENDIX A: DETAILED RECORDS SEARCH RESULTS.....	33

SUMMARY

- The owner of Greenmoor Kennels, St Brides Wentlooge, proposed to construct a new dwelling at the site, associated with the kennels business. A planning application to Newport City Council and associated ecology assessment were made in 2022 with an updated scheme, ecology survey and assessment in 2025.
- Abbey Sanders Ecology have been commissioned to carry out a Preliminary Ecological Appraisal (PEA) and Ecological Impact Assessment. This has included a desk study with review of local records centre data search results and a daytime survey carried out in August 2022 with update survey and assessment in September to November 2025.
- The site is occupied by disturbed grassland and tall herb habitats, with bare ground, debris piles and vegetable growing raised planting beds and is bordered by reens and associated scrub to the north and east and by the kennels, yard and access track to the south and west. The wider surroundings are predominantly agricultural pasture with a network of reens, and scattered farm and residential buildings. Habitats were broadly similar across the 2022 and 2025 survey visits.
- Whilst the site is located within the Gwent Levels – St Brides Site of Special Scientific Interest (SSSI) with a series of reens and associated high wildlife value, the application site is of poorer, well disturbed habitat quality and does not contain any reens or habitats likely to be of significant value to protected species. Two reens border the site, one to the north, which is set away from the development area and a lower habitat quality reen to the east. Both shall be retained and buffered through the development, to the 12.5m buffer required by Natural Resources Wales.
- There would be a low potential for impacts to protected species during construction works and through external lighting in the longer term.
- Precautionary working methods are therefore proposed to minimise the risk of impacts.
- Biodiversity enhancements are also proposed, to include planting to benefit the locally occurring and nationally scarce Shril Carder Bee, in line with Natural Resources Wales advice this will be in accordance with guidance for the Gwent

Levels, using specified tree planting and wildflower seeding lists or locally sourced green hay from the Levels.

- Any new external lighting will need to be approved in writing with the local planning authority in advance of installation.

1.0 INTRODUCTION

The site of the proposed new dwelling at Greenmoor Kennels, St Brides Wentlooge, is on the edge of the existing business area, bordering an agricultural field. The site is located in a rural area to the south-west of Newport, on the Gwent Levels.

Abbey Sanders Ecology have been commissioned to carry out a Preliminary Ecological Appraisal (PRA) and Ecological Impact Assessment (EcIA) of the proposed development in 2022, by Andrew Bates MRTPI of Sincerus Planning Consultancy, acting as agents for the site owners, to inform the relevant planning application to Newport City Council. An update survey and assessment by Abbey Sanders Ecology were commissioned in 2025 by Kieron Lediard of GJP Planning Consultancy, in relation to the revised scheme. This ecology assessment takes into account comments from Natural Resources Wales on the previous application.



Location of proposed new dwelling at Greenmoor Kennels – extract from 2025 plan provided by Stephen Quin Architects



Site of proposed dwelling viewed from the north 2022



Site of proposed dwelling viewed from the south 2025

Abbey Sanders, who has carried out this survey and assessment, is a qualified professional consultant ecologist (BSc and MSc degrees) a Chartered Ecologist and full Member of the Chartered Institute of Ecology and Environmental Management (CIEEM) and Chartered Environmentalist. Abbey Sanders is experienced in ecological survey and assessment, for over 20 years, holding survey licences in England and Wales, and has carried out the initial survey and all stages of assessment and produced this report. Rebecca Sheahan-East BSc, who has undertaken the update site visit, is a full member of CIEEM and a Chartered Environmentalist and is also experienced in ecological survey and assessment over more than 20 years.

2.0 SPECIES ECOLOGY, LEGISLATION & POLICY

2.1 Bats

UK bat species are nocturnal, roosting by day and foraging during the night, particularly at dusk and dawn during the main active months, March to October. Summer roost sites include cavities and crevices within buildings or trees with bats relocating to winter roosts to hibernate,

during which they can wake and emerge to feed for short periods. Winter roost sites are in more sheltered sites with relatively constant cool temperatures, such as disused mines or caves. When commuting to feeding sites or foraging, bats tend to follow linear features within the landscape such as hedgerows or rivers and feed on insects where these are readily found. Some bats commute through open areas and some feed over open habitat such as water bodies. All bat species occurring in the UK are afforded full legal protection under the Wildlife and Countryside Act 1981 (as amended) and are included in Schedule 2 of the Conservation (Natural Habitats, &c.) Regulations 1994, amendments to which have been consolidated by the Conservation of Habitats and Species Regulations 2010, consolidated and updated by the Conservation of Habitats and Species Regulations 2017, as amended, which gives them protection under European law. Through this protection it is illegal, among other offences to;

- Capture, kill or injure a bat
- Disturb bats
- Obstruct, damage or destroy the places where they breed or rest

unless a licence has been obtained to do so, for reasons of conservation, scientific research or through development (licences from Natural Resources Wales). Licences are only granted for these purposes where works are necessary and measures to adequately protect the bats are in place. A number of species are also listed under Section 74 of the CROW Act 2000 as being species of principal importance for the conservation of biological diversity and many species are also Priority BAP species on the UKBAP (United Kingdom Biodiversity Action Plan).

2.2 Otters

The European Otter *Lutra lutra* is mammal strongly associated with wetland habitats; rivers, coastal areas, streams and marshes as well as ponds and canals. Having declined greatly in the late 20th Century largely due to pollution and to some degree persecution, the species has been successfully growing in population numbers and recolonizing former habitats, as their environment becomes less polluted and more suitable habitat is therefore available, although they have not reached their former status. Otters have had a stronghold in some rural parts of Wales and the south-west of England and are now known to inhabit rivers throughout South Wales, also visiting and in some cases regularly using urban areas. Otters are largely active from the evening through to early morning away from the coast in the UK, and can cover large areas over several km in a night, searching for food, which is often fish, amphibians and also can include small mammals and birds. Daytime resting sites include cavities in trees roots and

areas of dense vegetation, males tend to have a large range incorporating the range of more than one female, the females seeking out quieter less disturbed areas for breeding.

The Otter in the UK is afforded full legal protection under the Wildlife and Countryside Act 1981 (as amended) and is included in Schedule 2 of the Conservation (Natural Habitats, &c.) Regulations 1994, amendments to which have been consolidated by the Conservation of Habitats and Species Regulations 2010, which gives them protection under European law. Through this protection it is illegal to;

- Kill, injure or handle an Otter
- Disturb an Otter
- Obstruct, damage or destroy the places where they live
- Keep, transport, sell or exchange an Otter whether alive or dead or to

keep Otters in captivity unless a licence has been obtained to do so, for reasons of conservation, scientific research or sometimes through development (licences from Natural England).

Licences are only granted for these purposes where works are necessary and measures to adequately protect the Otters are in place.

2.3 Non-native Invasive Plant Species

Several non-native plant species which are easily spread and known to cause problems through dominant growth are listed on the Schedule 9 of the Wildlife and Countryside Act 1981, as amended, in respect of Wales and England. This means that it is an offence to plant or otherwise cause them to grow in the wild.

2.4 Fish

The River Ebbw is noted for its breeding Brown Trout *Salmo trutta*, a Priority Species (Listed on Section 7 of the Environment Wales Act 2016. It is also noted as being important for migratory anadrous species including Sea Trout (the migratory form of Brown Trout) and Atlantic Salmon *Salmo salar*. These species may live in any part of the river, breeding in upper reaches in gravel beds with egg laying taking place between November and February and migration taking place either side of this, so that there is an embargo on fishing and works that may harm or disturb migratory fish between October and April each year.

2.5 Nesting Birds

The main bird breeding season is between March and August inclusive although breeding

activity can also often take place in February and September. Whilst the specific requirements of different bird species are varied, any buildings and areas of vegetative cover including trees, hedgerow, scrub and tussocky grassland can provide potential nesting areas for birds. Under the Wildlife and Countryside Act, 1981, as amended, it is an offence to kill injure or take any wild bird, to take, damage or destroy the nest of a bird whilst it is being built or in use and to take or destroy eggs, or to possess or control a bird or eggs (unless done so legally). Some species have further protection including barn owls *Tyto alba* which are also listed on Schedule 1 of the Wildlife and Countryside Act, which gives them further special protection.

2.6 Reptiles

Species of reptile which may be expected to potentially occur in the wider area include four species of reptile; common or viviparous lizard *Lacerta vivipara*, slow-worm *Anguis fragilis*, grass snake *Natrix natrix* and adder *Vipera berus*. From the habitats present on site it is considered that grass snake, slow-worm and possibly common lizard would be the most likely to occur within the site, although the site is quite exposed and isolated from surrounding similar habitats reducing the likelihood of their presence. All of these reptile species are afforded some protection, including against killing or injury, under the Wildlife and Countryside Act (1981, as amended). Reptiles are active during the summer months, emerging from hibernation from April to breed in the spring and early summer before returning to hibernation from around October. grass snakes are often found in association with water due to their preference for amphibian prey. Reptile species, including notably adders, often hibernate together and mate on emergence before migrating potentially several hundred metres to habitat where they will spend the rest of the summer. Reptiles require shelter and foraging habitat during the summer months and hibernate in well sheltered areas offering relatively constant temperatures, such as log or rock piles, stone walls, or underground cavities such as around tree roots.

2.7 Great Crested Newt

The Great Crested Newt is the largest of three native newt species, being approximately twice the size as an adult in comparison, reaching a total length of 110 to 170mm. Whilst breeding in ponds, which are therefore essential to the survival of populations, the majority of the lifecycle is spent in suitable terrestrial areas, including preferably mixed habitats of rough tussocky grassland, scrub, woodland and hedgerow with underground shelters such as rock crevices or mammal burrows also used. Great Crested Newts are

usually active on land between mid-February and early November, and egg-laying in ponds is typically between late March and early July although adults can be present in ponds throughout the year. Foraging for invertebrate prey including earthworms, insects, spiders and slugs, takes place mainly at night.

Great Crested Newts are protected under the Wildlife and Countryside Act, 1981, as amended, and are a European Protected Species through inclusion in Schedule 2 of the Conservation (Natural Habitats, &c.) Regulations 1994, amendments to which have been consolidated by the Conservation of Habitats and Species Regulations 2010, updated 2017 (as amended). Through this protection it is illegal, among other offences to;

- Capture, kill or injure a Great Crested Newt
- Disturb Great Crested Newts
- Obstruct, damage or destroy the places where they breed or rest

unless a licence has been obtained to do so, for reasons of conservation, scientific research or through development (licences from Natural England or Natural Resources Wales as appropriate). Licences are only granted for these purposes where works are necessary and measures to adequately protect the Great Crested Newts are in place.

2.8 Planning Policy

The Welsh government has identified a list of priority species and habitats in Wales, under Section 7 of the Environment (Wales) Act 2016. The priority species in Newport are: dormouse, (some species of) bats, otter, water vole, (some species of) fungi, small ranunculus moth and shrill carder bee. The priority habitats in Newport are: woodland, freshwater, wetlands, farmland, lowland grassland, open greenspace, marine and coastal.

Planning Policy Wales (12, 2024) sets out that planning authorities must seek to maintain and enhance biodiversity in the exercise of their functions. This means that development should not cause any significant loss of habitats or populations of species, locally or nationally. Development is required to follow the 'step-wise' or mitigation hierarchy approach, whereby impacts should be avoided where possible, or moving down the hierarchy, minimised, or mitigated / restored, or compensated on site, or offsite. Development must also provide a net benefit for biodiversity" (reference para 6.4.5) at any stage of the 'step-wise' approach. Enhancement measures to provide this net benefit can include on site habitat creation or form

part of the proposals (development) (para 6.4.12).

Natural Resources Wales (NRW) has developed a framework for evaluating ecosystem resilience based on five attributes and properties specified in the Environment (Wales) Act. This is referred to as DECCA: Diversity, Extent, Condition, Connectivity and Aspects of ecosystem resilience. These requirements are also addressed in NRW's Terrestrial and freshwater Resilient Ecological Networks: a guide for practitioners in Wales.

Newport City Council has published a Biodiversity Duty Forward Plan (2023 – 25) with a Biodiversity Interim Report (December 2023) on initial progress.

Note that under the EU exit process, these legal obligations and requirements remain in place.

3.0 METHODS

The following methodology for the ecological survey was followed;

- A **desk study** was undertaken with a review of available pre-existing information. This included a review of local data provided by the South East Wales Biodiversity Records Centre (SEWBReC) in 2022 for the wider area including pre-existing records of protected and priority species and designated sites. In 2025 a review of mapping, aerial photography and the comments and information relating to the previous planning decision and the new application have been reviewed.
- A **daytime survey and inspection of the site and surrounding area** was undertaken during the daylight hours, on 1st August 2022, during which conditions were dry and warm with a light breeze, being within a typical range for the time of year. An **update walkover survey** was made on 24th September 2025, during similarly dry clear conditions.
- This survey broadly followed the methodology for Phase 1 Habitat Survey described within the JNCC '*Handbook for Phase 1 Habitat Survey*' (2003 rev.) together with the methodology for Extended Phase 1 Habitat Survey described within Spon & Spon's '*Guidelines for Baseline Habitat Assessment*' (1995). Following this methodology,

existing habitats were recorded and mapped with any notable flora and fauna identified also being recorded (note that the scope of this survey does not include a full detailed list of all species present). This was then used to assess the potential of the site to support any further features of interest which had not been recorded.

- **Constraints** – none were encountered,

The results of the desk study and site survey are described in **4.0 Results** below.

4.0 RESULTS

4.1 Data search and desk study

A data search was conducted via the Aderyn biodiversity database for records of Priority Species, Species of Conservation Concern and Locally Important Species within 2km of Greenmoor Nurseries, St Brides Wentlooge.

Various records were present in the surrounding area, including some close to the site. The results are summarised in **Tables 1, 2 and 3** with ‘distance’ reflecting the proximity of the closest record for each species, and ‘date’ the most recent record for each species.

The search also returned records of Invasive Non-Native Species within 1km of the site. These are summarised in **Table 4**.

Refer to APPENDIX A for Tables 1 to 4.

Designated sites within 2km

Greenmoor Nurseries is located within the Gwent levels, an extensive area of reclaimed wet pasture along the Severn Estuary between Chepstow and Cardiff. The area is drained by a network of reens which support a diverse range of plant and invertebrate species.

Internationally important sites within 2km

- **Severn Estuary**– One of the largest estuaries in Britain with the second largest tidal range in the world, the Severn Estuary is of international importance to nature conservation, and is protected through the following designations:
 - **Special Area of Conservation (SAC)** – designated in 2009 under the EU Habitats Directive due to the range of habitats it provides and the wildlife they support.

These habitats include extensive intertidal mudflats and sandflats, subtidal sandbanks, reefs and Atlantic salt meadows.

- **Special Protection Area (SPA)** – designated in 1995 under the EU Birds Directive due to its international importance for the breeding, feeding, wintering and migration of rare species of birds, in particular wildfowl and waders such as Bewick’s swan *Cygnus columbianus bewickii*, Greater white-fronted goose *Anser albifrons albifrons*, Dunlin *Calidris alpina alpina*, Common redshank *Tringa totanus*, Common shelduck *Tadorna tadorna* and Gadwall *Anas strepera*. The mudflats include high densities of lugworms, ragworms and other invertebrates which means the area can support large numbers of birds, with records of over 70,000 regularly overwintering and stopping off on the way to other migration sites.
- **Ramsar Site** – designated in 1995 as a wetland of international importance due to features covered by the SAC and SPA designations, and also due to the estuary’s importance to migratory fish species such as sea lamprey *Petromyzon marinus*, river lamprey *Lampetra fluviatilis*, twaite shad *Alosa fallax*, allis shad *Alosa alosa*, salmon *Salmo salar*, sea trout *Salmo trutta* and eel *Anguilla anguilla*.
- **Site of Special Scientific Interest** – this designation covers a large area of the estuarine habitat due to its importance to invertebrates, wintering and passage wading birds and migratory fish

Nationally important sites within 2km

- **Gwent Levels: St Brides SSSI** - one of six Sites of Special Scientific Interest covering the whole of the Gwent Levels. The site is primarily designated for its reed and ditch habitat which hosts rare aquatic plants and diverse and extensive invertebrate communities. It is also designated for the presence of the rare shrill carder bee *Bombus sylvarum*. **The application site lies within the SSSI boundary** and the local planning authority will therefore need to consult Natural Resources Wales regarding the planning application.



Natural Resources Wales interactive map extract showing SSSI coverage over proposed construction site

Natural Resources Wales (NRW) comments on the previous application, dated 03/02/2023, advise that the special interests of the SSSI are the range of aquatic plants and invertebrates and are therefore dependent on the existence and management of the drainage system, the water quality and water quantity. Details on the proposed sewage treatment system were requested.

Buffer zones between the development were advised to be required at least 7m from the top of the ditch bank and 12.5m from the top of the reens bank, within the Gwent Levels. Within this buffer there should be no physical development, no storage of materials, no refueling of machinery and where possible no trafficking of vehicles, to avoid contamination of the reens and impacts to the SSSI interest features.

A specific condition for a **Construction Environmental Management Plan (CEMP)** is requested by NRW, to include details of site management, pollution prevention measures, details of responsible persons and bodies and details of buffer zones to comply with the requirements set out above.

Shrill Carder Bee – NRW welcomed enhancement measures aimed at conserving this locally occurring scarce species and specified that local green hay should be used in the 12.5m buffer strip to cater for the species, or otherwise use of the locally developed Gwent Levels specific

seed mix. Habitat management should avoid cutting between April and September/ October to provide habitat for the bee, with an annual autumn cut and collection of arisings.

SSSI Consent would be required for application of any pesticides, herbicides and destruction, removal or pruning of any plant or plant remains. **Planting within the SSSI** should be at a sufficient distance to avoid shading of the ditches with any trees selected from the Gwent Levels tree list, with plants of UK native provenance.

Guidance on use of Sustainable Drainage Systems (SUDS) is provided.

Locally important sites

- **B-Lines** - the site is within a B-lines area, a Buglife initiative designed to create a network of ‘insect pathways’ to link existing wildlife areas together by providing corridors of suitable pollinator habitat
- **Peterstone Wentlooge Wildlife Trust Reserve** (approximately 976m from site) – marsh and tidal mudflat habitats with plant, invertebrate and wading bird interest.

Habitats at and around the site

- The site is located within the following Natural Resources Wales priority habitats:
 - **NRW Priority Area (Lowland Wetland)**
 - **NRW Priority Area (Coastal Saltmarsh)**

The site and its surroundings are predominantly agricultural pasture with a network of reens, and scattered farm and residential buildings.

4.3 Habitat Survey

The site is occupied by disturbed grassland and tall herb habitats, with bare ground, debris piles, stored items and vegetable growing raised planting beds (2022) and is bordered by reens and associated scrub to the north and east and by the kennels, yard and access track to the south and west.

The following habitat details were recorded within the footprint of the proposed development;

- **Bare ground with debris piles**

- Raised **soil planting beds** with pumpkin planting (2022)
- **Tall herbs and modified (improved neutral) grassland** typical of regularly disturbed ground. Species recorded include Tall Fescue *Festuca arundinacea*, Cocksfoot *Dactylis glomerata*, Sweet-vernal grass *Anthoxanthum odoratum*, Common Bent *Agrostis capillaris*, Common Vetch *Vicia sativa*, Red Fescue *Festuca rubra*, scattered Bramble *Rubus fruticosus* ag. and Buddleia *Buddleia davidii*, Stinging Nettle *Urtica dioica*, Creeping Buttercup *Ranunculus repens*, Meadow Buttercup *Ranunculus acris*, Spear Thistle *Cirsium vulgare*, Field Bindweed *Convolvulus arvensis*, Hedge Bindweed *Calystegia sepium*, Deadly Nightshade *Atropa belladonna*, Hard Rush *Juncus inflexus*, Cleavers *Galium aparine*, Yarrow *Achillea millefolium*, Teasel *Dipsacus fullonum*, Broadleaved Dock *Rumex obtusifolius*, White Clover *Trifolium repens*, Red Clover *Trifolium pratense*, Common Bird's-foot Trefoil *Lotus corniculatus*, Lesser Trefoil *Trifolium dubium*, Red Bartsia *Odontites verna*, Dovesfoot Cranesbill *Geranium molle*, Common Poppy *Papaver rhoeas*, Pineappleweed *Matricaria discoidea*, Fat Hen *Chenopodium album*, Greater Plantain *Plantago major*, Ribwort Plantain *Plantago lanceolata*, Prickly Sowthistle *Sonchus asper*, Prickly Lettuce *Lactuca serriola*, Great Willowherb *Epilobium hirsutum*, Redshank *Persicaria maculosa*, Broadleaved Willowherb *Epilobium montanum*, Scented Mayweed *Matricaria chamomilla*, Round-leaved Cranesbill *Geranium rotundifolia*, Common Ragwort *Senecio jacobea*, Hairy Sedge, *Carex hirta* and Greater Pond Sedge *Carex riparia*. These habitats extend beyond the site boundary to the north and west, beyond which the field, to which the site is currently open, is of more typical undisturbed semi-improved grassland and tall herb.
- **Scrub with reën** - along the **east boundary**, raised up on a bank / bund with a reën to the east of this. Dominated by Hawthorn *Crataegus monogyna*, Blackthorn *Prunus spinosa*, Elder *Sambucus nigra* and Willow *Salix fragilis*. The reën here is of sub-optimal quality being bordered to the east by a close boarded fence and the access track and to the west by scrub and a raised bank. The reën, of which this is the southern end, is shaded and shallow here with no apparent emergent plants or associated typical riparian habitat.
- **Reedbed with reën** – along the **north boundary** of the site, dominated by Common Reed *Phragmites australis*. This reën is of more optimal habitat quality with no evidence of recent habitat disturbance and no evidence of recent management activities

(2022 and 2025).

Fauna – Blackbird *Turdus merula*, House Sparrows *Passer domesticus*, Swallows *Hirundo rustica*, Small Tortoiseshell *Aglais urticae*, Gatekeeper *Pyronia tithonus* butterfly were all observed within or flying over the site during the 2022 survey.

Magpie *Pica pica*, Goldfinch *Carduelis carduelis*, House Sparrow, Robin *Erithacus rubecula*, Wood Pigeon *Columba palumbus*, House Martin *Delicon urbica*, Dunnock *Prunella modularis*, Blue Tit *Cyanistes caeruleus*, Goldcrest *Regulus regulus*, Jackdaw *Corvus monedula*, Redshank *Tringa tetanus*, Rabbit *Orcytolagus cuniculus*, Large White Butterfly *Pieris brassicae*, Seven Spot Ladybird *Coccinella septempunctata* and Crane fly *Tipula* species were observed within or over the site during the 2025 survey.

No structures or trees with any potential to support roosting bats were recorded within the application site.



Debris piles and bare ground at the south part of the site 2022



Brash pile 2025



Central and southern parts of the site looking to the kennels site to the south



Scrub on raised bank to the east of the proposed development area 2022



Scrub 2025



East boundary viewed from access road outside site



Field unit to the west of the proposed development area



Reedbed at edge of ree to the north of the proposed development site (outside site)



Scrub at edge of ree to the north-east of the proposed development site (outside site)

4.0 ASSESSMENT AND CONCLUSIONS

The **proposed development** will involve the construction of a new dwelling. in the centre of the site with associated garden and vehicle parking. Some tree planting in

degradation of habitat, reduced habitat connectivity (to species potentially including foraging and commuting bats) or pollution of the reën. There would be some potential for indirect impacts to the adjacent retained reën with associated reedbed and scrub habitat to the north, such as from vehicle movements and storage of materials during works, and runoff of site materials.

The remaining, main development area would affect the tall herbs and modified grassland typical of disturbed ground, raised planting beds, bare ground and debris piles.

Species – the debris piles, being set close to the scrub, reens and grassland in the wider area, may potentially support low numbers of **reptiles**, with slow-worm and grass snake having been recorded within 400m and 650m of the site. The potential of the development site area itself, to support these species, is considered to be reduced by the prevalence of bare ground and regular disturbance to this area which is relatively small, compared to the extensive, retained, more suitable habitat in the immediate surroundings. It is therefore considered appropriate to put in place precautionary working methods to protect reptiles and other species that may enter the site during works, such as **Hedgehog, Water Vole and Otter**, which are present in the wider area as identified within the records search and may move through the site, or along adjacent reën habitats. The lack of connectivity of the reën to the east of the site with habitats to the south reduces this likelihood, however, with connectivity and likely movement of animals being to the north and west of the site along higher quality reens. This is not likely to be significantly affected by the proposals. **Nesting birds** associated with the scrub to the east and north of the site may potentially be affected during works.

Introduction of **artificial lighting** to the site could potentially affect bats and other nocturnal lighting, in the absence of suitable controls.

Great Crested Newt – may potentially use the reën to the north of the site, although the reën to the east is not considered suitable due to the reduced habitat value of this as described above. The reën and associated riparian habitat to the north will be retained and buffered. The species has been recorded within 900m approx. of the site. Whilst this species and other amphibians that may also use the reën can cross land and use terrestrial features to forage and shelter, the site contains limited opportunities for this

due to the disturbed nature and prevalence of bare ground, there is also no connectivity with other water features to the east or south, also reducing the potential for movement through the site. General good practice precautionary working measures will benefit amphibians.

Shrill Carder Bee – the site was not considered to currently offer significant potential for this species.

There would also be **opportunities to introduce habitat enhancements** to benefit species associated with the surrounding SSSI grassland and reed habitat, including Shrill Carder Bee as well as mobile species such as birds and bats.

The following general **ecological protection, mitigation and enhancement measures**, incorporating the comments from NRW on the previous scheme are proposed;

- There shall be **no development within 12.5m of any reed** and no landscaping works within this area unless through on site induction, agreement of working methods on site and oversight by a suitably qualified ecologist.
- The proposed scheme shall be **offset from the eastern scrub line by a minimum of 12.5m**. This buffer area shall be planted with ecologically beneficial planting -see Biodiversity Enhancements below.
- **All development works, vehicle movement and storage of equipment or materials shall be restricted to the redline boundary area** and areas of existing bare ground, hard-standing and access tracks.
- At the start of works a careful inspection of all work areas shall be made. **Clearance of existing piles of debris, vegetation and planting areas** shall be undertaken by hand where possible and with due care and attention making visual checks. Such clearance shall take place between March and September inclusive, when reptiles etc. are likely to be active and so less vulnerable to disturbance. If any clearance works outside these times are required, advice shall be sought from an ecologist, and followed, before proceeding. If any **protected wildlife species** are found at this or at any other point, works to that area shall cease until suitable advice by a wildlife specialist has been sought and followed. Note that in the case of Great Crested Newt, Otter, or Water Vole, a development licence may be required before any works affecting these species or their resting places can commence. Where necessary the ecologist shall remove

any animals present to a suitable retained habitat area, well away from the area of works.

- Should any **nesting birds** be found during works, works to the relevant area will need to be delayed until the young birds have left the nest, as nesting birds are protected under the Wildlife and Countryside Act, 1981 (as amended)
- **During works, no excavations** shall be left open overnight, or, if this is unavoidable, a ramp, such as a plank of wood, will be left at a maximum angle of 45 degrees, to allow any animals that may crawl or fall in to escape. Any open excavations will be checked each morning before works commence.
- Any **materials** stored on site such as gravel, concrete, timber posts, sand etc. will be stored off the ground on pallets or similar or in bags to avoid creation of potential new habitat piles within the working site.
- During works and in the longer term, there shall be no **external lighting** installed unless agreed in advance in writing with the local planning authority in order to protect nocturnal wildlife including bats.
- The above measures shall be incorporated into a **Construction Environmental Management Plan (CEMP)** as requested by NRW.
- Any new **landscape planting** proposed will be of native, locally typical species of tree, shrub or wildflower grassland seeding in line with the Gwent Levels lists as recommended by Natural Resources Wales or will utilise a local source of species rich green hay from the levels - see also Biodiversity Enhancement details below.

Should there be any changes to these works such that may affect the roof and / or roosting bats, advice shall be sought and followed, from a suitably qualified ecologist.

Biodiversity enhancement measures to meet best practice and planning authority requirements, are proposed, with the following details, or similar suitable alternatives as agreed with an ecologist, to be installed;

PROPOSED BIODIVERSITY ENHANCEMENT DETAILS:

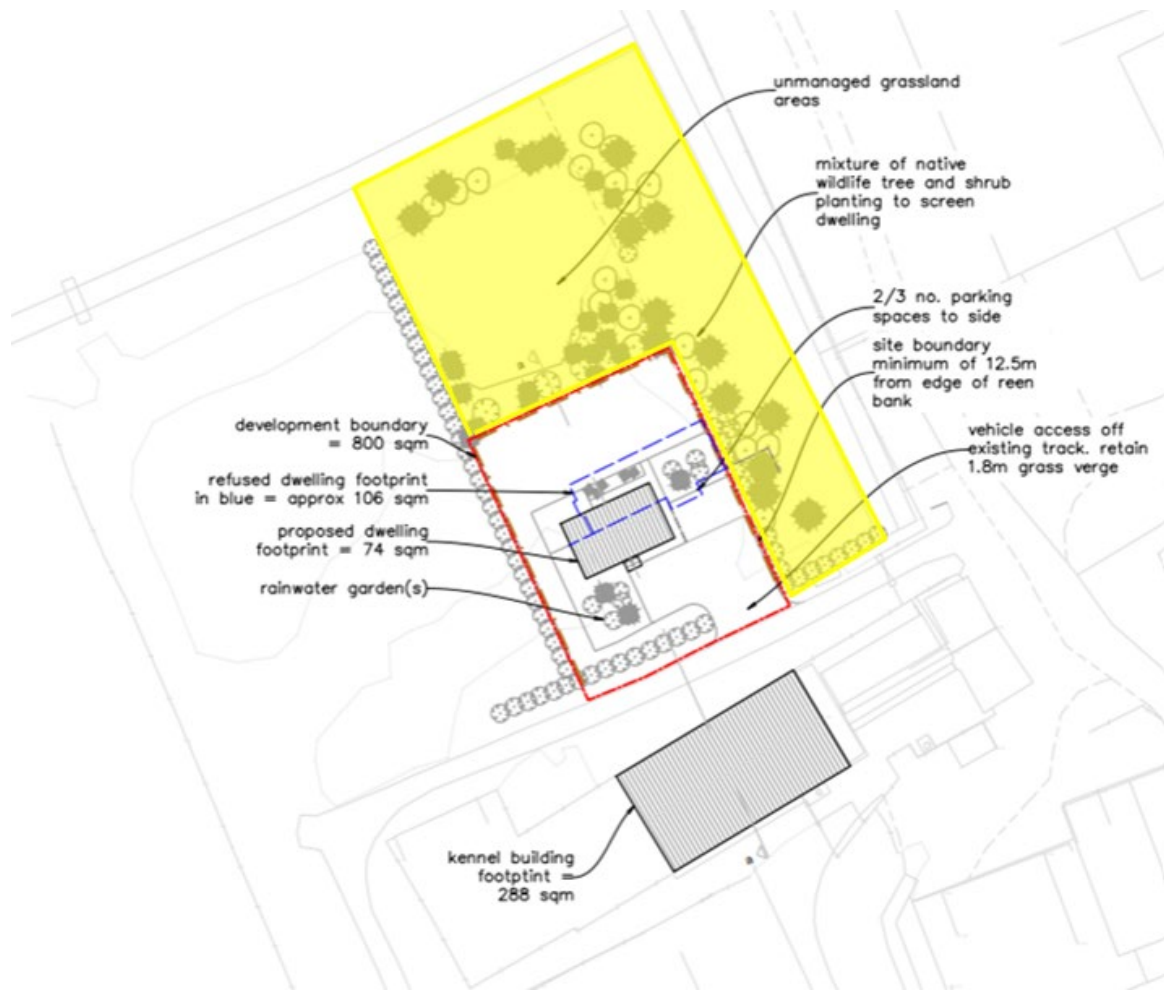



KEY:

 Bird box to be installed

 Bat box to be installed

 Native Tree & Shrub & Wildflower Planting to NRW Specification



Woodstone Sparrow Nest Box – can be externally mounted or built-in with only front face showing beyond finished wall or cladding



Segovia Woodstone Build-in Bat Box – can be built into wall with entrance only showing at level of finish / surrounding external cladding

Wildflower Grassland and Tree Planting, in line with the Gwent Levels lists as recommended by Natural Resources Wales or will utilise a local source of species rich green hay from the levels shall be installed on the retained existing ground with no topsoil added. This will provide a potential food source for the locally occurring and nationally scarce Shril Carder Bee.

Lifetime of the ecology survey and report: It should be noted that, whilst it is understood

Abbey Sanders Ecology

that the planning application and proposed works are due to take place in the near future, ecology surveys are generally considered up to date for a maximum of one and a half to 2 years, so if there is any significant delay it is recommended that update advice is sought from an ecologist before commencing.

7.0 REFERENCES

BCT '**Bat Surveys for Professional Ecologists; Good Practice Guidelines – 4th Edition**' 2023 Bat Conservation Trust

CIEEM '**Guidelines for Ecological Impact Assessment in the UK and Ireland, Terrestrial, Freshwater, Coastal and Marine**' Version 1.2 Updated April 2022

CIEEM '**Guidelines for Preliminary Ecological Appraisal**' 2nd Edition, December 2017

Gent, T., Gibosn, S; '**Herpetofauna Workers' Manual**' 2003, JNCC (Joint Nature Conservation Committee).

JNCC (Joint Nature Conservation Committee) '**Handbook for Phase 1 Habitat Survey – A technique for environmental audit**' 1990, 2003 (rev).

Living Levels website [Land Management Advice — Living Levels](#) accessed December 2025

Mitchell-Jones, A. J. & McLeish, A. P. (Eds.) '**Bat Workers' Manual**' Joint Nature Conservation Committee (JNCC) 2004.

Newport City Council '**Wildlife and Development Supplementary Planning Guidance**' August 2015

Newton, J., Thackray, C. and Nicholson, B. '**Working With Wildlife Site Guide**' CIRIA 2005

Reason, P.F. & Wray, S '**UK Bat Mitigation Guidelines: a guide to impact assessment, mitigation and compensation for developments affecting bats**' Chartered Institute of Ecology and Environmental Management, Ampfield, 2023

Spon (E) & Spon (F N) '**Guidelines for Baseline Ecological Assessment**' Institute of Environmental Assessment, 1995

APPENDIX A: DATA SEARCH RESULTS

TABLE 1: Summary of Aderyn Data Search Results: Priority species within 2km of the site at Greenmoor Nurseries

Scientific Name	Common Name	No. of Records	Distance of Closest Record (m) (Bat Roost)	Date of most Recent Record (Bat Roost)	Conservation Status	Notes
<i>Alcedo atthis</i>	Kingfisher	5	341	2019	CAT1, BDir1, WCA1.1, Bern, WBAm(RSPB), UKBAm(RSPB)	-
<i>Anguis fragilis</i>	Slow-worm	4	341	2018	CAT1, WCA5, S7, Bern	-
<i>Boloria selene</i>	Small Pearl-bordered Fritillary	2	341	2017	CAT1, S7, RDB1 (UK) - NT, LBAP(NEW), LI(SEWBRcC), LI(VC43)	-
<i>Cettia cetti</i>	Cetti's Warbler	11	341	2020	CAT1, WCA1.1,	-
<i>Chiasmia clathrata</i>	Latticed Heath	3	341	2014	CAT1, S7	adults
<i>Coenonympha pamphilus</i>	Small Heath	41	341	2018	CAT1, S7, RDB1 (UK) - NT	-
<i>Cuculus canorus</i>	Cuckoo	17	341	2019	CAT1, S7, WBR(RSPB), UKBR(RSPB)	-
<i>Cupido minimus</i>	Small Blue	4	341	2015	CAT1, WCA5, S7, RDB1 (UK) - NT, LI(SEWBRcC)	-
<i>Emberiza schoeniclus</i>	Reed Bunting	56	341	2020	CAT1, S7, Bern, WBAm(RSPB), UKBAm(RSPB)	-
<i>Erinaceus europaeus</i>	West European Hedgehog	14	341	2022	CAT1, S7, Bern, LBAP (NEW)	live sightings
<i>Falco columbarius</i>	Merlin	5	341	2009	CAT1, BDir1, WCA1.1, Bern, CITES, WBR(RSPB), LI(VC43), UKBR(RSPB)	-
<i>Falco peregrinus</i>	Peregrine	10	341	2019	CAT1, BDir1, WCA1.1, Bern, CITES, LI(VC43)	-
<i>Falco tinnunculus</i>	Kestrel	118	341	2019	CAT1, S7, Bern, CITES, WBR(RSPB), LI(VC43), UKBAm(RSPB)	includes one historic record (1976)
<i>Hyacinthoides non-scripta</i>	Bluebell	3	341	2016	CAT1, WCA8,	-
<i>Larus argentatus</i>	Herring Gull	31	341	2020	CAT1, BDir22, S7, WBR(RSPB), UKBR(RSPB)	includes one historic record (1989)
<i>Leptidea sinapis</i>	Wood White	1	341	2016	CAT1, WCA5, S7, RDB1 (UK) - EN, LI(SEWBRcC)	-
<i>Lutra lutra</i>	Eurasian Otter	5	341	2019	CAT1, EPS, HDir, WCA5, S7, Bern, CITES, RDB2 (UK),	2 live sightings; 3 spraints
<i>Mustela nivalis</i>	Weasel	1	341	2013	CAT1, NRW, Bern, LBAP (NEW)	-
<i>Numenius arquata</i>	Curlew	73	341	2020	CAT1, BDir22, S7, WBR(RSPB), VOG), LI(VC43), UKBR(RSPB)	-
<i>Passer domesticus</i>	House Sparrow	18	341	2020	CAT1, S7, WBAm(RSPB), UKBR(RSPB)	-
<i>Perdix perdix</i>	Grey Partridge	1	341	1985	CAT1, BDir21, S7, WBR(RSPB), LI(VC43), UKBR(RSPB)	historic record (1985)
<i>Pyrrhula pyrrhula</i>	Bullfinch	5	341	2019	CAT1, S7, WBR(RSPB), - UKBAm(RSPB)	-

<i>Sturnus vulgaris</i>	Starling	126	341	2019	CAT1, BDir22, S7, Bern, WBR(RSPB), - UKBR(RSPB)	includes one historic record (1976)
<i>Timandra comae</i>	Blood-vein	4	341	2014	CAT1, S7	-
<i>Turdus iliacus</i>	Redwing	28	341	2020	CAT1, BDir22, WCA1.1, WBAm(RSPB), UKBR(RSPB)	-
<i>Turdus philomelos</i>	Song Thrush	12	341	2020	CAT1, BDir22, S7, BernWBAm(RSPB), UKBR(RSPB)	-
<i>Turdus pilaris</i>	Fieldfare	15	341	2019	CAT1, BDir22, WCA1.1, WBAm(RSPB), UKBR(RSPB)	
<i>Tyria jacobaeae</i>	Cinnabar	33	341	2019	CAT1, S7	adults and caterpillars
<i>Vanellus vanellus</i>	Lapwing	89	341	2019	CAT1, BDir22, S7, WBR(RSPB), LI(VC43), UKBR(RSPB)	includes breeding records; nearest 571m away; most recent confirmed breeding 1996
<i>Erynnis tages</i>	Dingy Skipper	2	425	2020	CAT1, S7, RDB1 (UK) - VULI(SEWBRc)	-
<i>Bombus sylvarum</i>	Shrill Carder Bee	20	460	2022	CAT1, S7, RDB2 (UK) - NB	-
<i>Arvicola amphibius</i>	European Water Vole	8	514	2015	CAT1, WCA5, S7	3 live sightings; 5 field signs (burrow/feeding remains)
<i>Natrix helvetica</i>	Grass Snake	2	618	2015	CAT1, WCA5, S7, Bern	1 record dead in road
<i>Oenanthe fistulosa</i>	Tubular Water-dropwort	4	626	2014	CAT1, S7, RDB1 (UK) - VU, LI(SEWBRc), LI(VC43), LI(VC47), LI(VC48, LR), LI(VC49, LS), LI(VC50, LS), LI(VC51, LS), LI(VC52, LS)	includes 2 historic records (1976 and 1981)
<i>Chroicocephalus ridibundus</i>	Black-headed Gull	48	649	2020	CAT1, BDir22, S7, WBR(RSPB), UKBAm(RSPB)	-
<i>Linaria cannabina</i>	Linnet	14	649	2019	CAT1, S7, Bern, WBR(RSPB), UKBR(RSPB)	-
<i>Circus aeruginosus</i>	Marsh Harrier	4	695	2019	CAT1, BDir1, WCA1.1, CITES, WBAm(RSPB), UKBR(RSPB), UKBAm(RSPB)	-
<i>Euphydryas aurinia</i>	Marsh Fritillary	1	695	1947	CAT1, HDir, WCA5, S7, Bern, RDB1 (UK) - VU, LI(SEWBRc)	historic record (1947)
<i>Tyto alba</i>	Barn Owl	9	712	2021	CAT1, WCA1.1, WCA9, Bern, CITES, LI(VC43)	includes one historic record (1973); 1 record of a dead owl; 1 breeding record 2km from site (2007)

<i>Bufo bufo</i>	Common Toad	4	714	2019	CAT1, WCA5, S7, Bern	-
<i>Lissotriton vulgaris</i>	Smooth Newt	1	738	2009	CAT1, WCA5, Bern, LI(BIS)	-
<i>Acronicta psi</i>	Grey Dagger	11	787	2005	CAT1, S7	Includes 1 historic record (1987); larvae and adults
<i>Acronicta rumicis</i>	Knot Grass	10	787	2005	CAT1, S7	adult and larva
<i>Apamea remissa</i>	Dusky Brocade	1	787	2005	CAT1, S7	adult
<i>Atethmia centrago</i>	Centre-barred Sallow	1	787	2005	CAT1, S7	adult
<i>Caradrina morpheus</i>	Mottled Rustic	8	787	2005	CAT1, S7	adult
<i>Cirrhia icteritia</i>	Sallow	2	787	2005	CAT1, S7	adults
<i>Ennomos fuscantaria</i>	Dusky Thorn	2	787	2005	CAT1, S7	adult
<i>Hemistola chrysoprasaria</i>	Small Emerald	2	787	2005	CAT1, S7	adults
<i>Hepialus humuli</i>	Ghost Moth	13	787	2005	CAT1, S7	adults
<i>Hoplodrina blanda</i>	Rustic	8	787	2005	CAT1, S7	adults
<i>Hydraecia micacea</i>	Rosy Rustic	4	787	2005	CAT1, S7	adults
<i>Litologia literosa</i>	Rosy Minor	4	787	2005	CAT1, S7	adults
<i>Lycia hirtaria</i>	Brindled Beauty	2	787	2005	CAT1, S7	adults
<i>Malacosoma neustria</i>	Lackey	2	787	2005	CAT1, S7	adults
<i>Melanchra persicariae</i>	Dot Moth	6	787	2005	CAT1, S7	adults
<i>Orthosia gracilis</i>	Powdered Quaker	2	787	2005	CAT1, S7	adults
<i>Prunella modularis</i>	Dunnock	10	787	2019	CAT1, S7, Bern, UKBAm(RSPB)	-
<i>Rhizedra lutosa</i>	Large Wainscot	2	787	2005	CAT1, S7	adult
<i>Spilosoma lubricipeda</i>	White Ermine	2	787	2005	CAT1, S7	adult
<i>Spilosoma lutea</i>	Buff Ermine	5	787	2005	CAT1, S7	adult
<i>Xanthorhoe ferrugata</i>	Dark-barred Twin-spot Carpet	1	787	2005	CAT1, S7	adult
<i>Alauda arvensis</i>	Skylark	6	880	2020	CAT1, BDir22, S7, WBAm(RSPB), UKBR(RSPB)	-
<i>Anser albifrons</i>	White-fronted Goose	2	880	2019	CAT1, BDir22, S7, Bern, WBR(RSPB), UKBR(RSPB)	-
<i>Barbastella barbastellus</i>	Western Barbastelle	1	880	2019	CAT1, EPS, HDir, WCA5, S7, Bern, RDB2 (UK)	field record
<i>Bombus humilis</i>	Brown-Banded Carder Bee	2	880	2022	CAT1, S7	-
<i>Emberiza citrinella</i>	Yellowhammer	1	880	2019	CAT1, S7, Bern, WBR(RSPB), UKBR(RSPB)	-

<i>Eptesicus serotinus</i>	Serotine	2	880	2019	CAT1, EPS, HDir, WCA5, Bern, RDB2 (UK)	static detector record
<i>Muscardinus avellanarius</i>	Hazel Dormouse	3	880	2020	CAT1, EPS, HDir, WCA5, S7, Bern, RDB2 (UK)	2 live sightings
<i>Myotis</i>	Myotis Bat species	1	880	2019	CAT1, EPS, HDir, WCA5, Bern	static detector record
<i>Myotis daubentonii</i>	Daubenton's Bat	1	880	2019	CAT1, EPS, HDir, WCA5, Bern, RDB2 (UK)	field record
<i>Myotis mystacinus</i>	Whiskered Bat	1	880	2019	CAT1, EPS, HDir, WCA5, Bern, RDB2 (UK)	field record
<i>Myotis nattereri</i>	Natterer's Bat	1	880	2019	CAT1, EPS, HDir, WCA5, Bern, RDB2 (UK)	field record
<i>Nyctalus</i>	Nyctalus Bat species	1	880	2019	CAT1, EPS, HDir, WCA5, Bern	field record
<i>Nyctalus leisleri</i>	Lesser Noctule	2	880	2019	CAT1, EPS, HDir, WCA5, Bern, RDB2 (UK)	static detector record
<i>Nyctalus noctula</i>	Noctule Bat	1	880	2019	CAT1, EPS, HDir, WCA5, S7, Bern, RDB2 (UK)	static detector record
<i>Pipistrellus</i>	Pipistrelle Bat species	1	880	2019	CAT1, EPS, WCA5	field record
<i>Pipistrellus nathusii</i>	Nathusius's Pipistrelle	1	880	2019	CAT1, EPS, HDir, WCA5, Bern, RDB2 (UK)	field record
<i>Pipistrellus pipistrellus</i>	Common Pipistrelle	1	880	2019	CAT1, EPS, HDir, WCA5, S7, Bern, RDB2 (UK)	static detector record
<i>Pipistrellus pygmaeus</i>	Soprano Pipistrelle	1	880	2019	CAT1, EPS, HDir, WCA5, S7, Bern, RDB2 (UK)	static detector record
<i>Plecotus auritus</i>	Brown Long-eared Bat	1	880	2019	CAT1, EPS, HDir, WCA5, S7, Bern, RDB2 (UK)	static detector record
<i>Pluvialis apricaria</i>	Golden Plover	8	880	2019	CAT1, BDir1, BDir22, S7, WBR(RSPB), LI(VC43)	-
<i>Poecile palustris</i>	Marsh Tit	1	880	2019	CAT1, S7, Bern, WBR(RSPB), UKBR(RSPB)	-
<i>Rhinolophus ferrumequinum</i>	Greater Horseshoe Bat	1	880	2019	CAT1, EPS, HDir, WCA5, S7, Bern, RDB2 (UK)	field record
<i>Triturus cristatus</i>	Great Crested Newt	1	880	2019	CAT1, EPS, HDir, WCA5, S7, Bern, RDB2 (UK)	positive e-Dna; however - found during trapping/ torching/ egg searches etc
<i>Anas acuta</i>	Pintail	24	895	2020	CAT1, BDir21, WCA1.2, CITES, WBAm(RSPB), UKBAm(RSPB)	-
<i>Charadrius hiaticula</i>	Ringed Plover	59	895	2020	CAT1, S7, Bern, WBR(RSPB), - UKBR(RSPB)	includes records of nesting 1105m from site
<i>Limosa lapponica</i>	Bar-tailed Godwit	19	895	2018	CAT1, BDir1, BDir22, S7, WBR(RSPB), UKBAm(RSPB)	-
<i>Limosa limosa</i>	Black-tailed Godwit	17	895	2018	CAT1, BDir22, WCA1.1, WBAm(RSPB), UKBR(RSPB)	-
<i>Numenius phaeopus</i>	Whimbrel	37	895	2020	CAT1, BDir22, WCA1.1, WBAm(RSPB), UKBR(RSPB)	-
<i>Tringa nebularia</i>	Greenshank	3	895	2015	CAT1, BDir22, WCA1.1UKBAm(RSPB)	-

<i>Phoenicurus ochruros</i>	Black Redstart	1	924	2007	CAT1, WCA1.1, Bern, LBAP (GWY, VOG), WBAm(RSPB), UKBR(RSPB)	-
<i>Anguilla anguilla</i>	European Eel	1	984	1978	CAT1, S7, RDB1 (UK) - CR,	Historic record (1978)
<i>Vipera berus</i>	Adder	2	1041	2013	CAT1, WCA5, S7, Bern,	1 live sighting during refugia survey.
<i>Acanthis cabaret</i>	Lesser Redpoll	3	1105	2015	CAT1, S7, WBAm(RSPB), UKBR(RSPB)	-
<i>Charadrius alexandrinus</i>	Kentish Plover	1	1105	1983	CAT1, WCA1.1, Bern	Historic record (1983)
<i>Curruca undata</i>	Dartford Warbler	1	1105	2009	CAT1, BDir1, WCA1.1, WBAm(RSPB), UKBAm(RSPB)	-
<i>Cygnus columbianus</i>	Tundra Swan	2	1105	2010	CAT1, BDir1, WCA1.1, S7, Bern, WBR(RSPB), UKBAm(RSPB)	-
<i>Hordeum marinum</i>	Sea Barley	1	1105	2004	CAT1, S7, RDB1 (UK) - VU, RDB2 (UK) - S, LI(VC51, LR)	-
<i>Ichthyaetus melanocephalus</i>	Mediterranean Gull	5	1105	2020	CAT1, BDir1, WCA1.1, Bern, WBAm(RSPB), UKBAm(RSPB)	-
<i>Loxia curvirostra</i>	Crossbill	1	1105	2016	CAT1, WCA1.1, Bern, LI(VC43)	-
<i>Melanitta nigra</i>	Common Scoter	4	1105	2015	CAT1, BDir22, WCA1.1, S7, WBAm(RSPB), UKBR(RSPB)	-
<i>Milvus milvus</i>	Red Kite	1	1105	2008	CAT1, BDir1, WCA1.1, WCA9, CITES, WBAm(RSPB)	-
<i>Motacilla flava</i>	Yellow Wagtail	4	1105	2020	CAT1, S7, Bern, WBR(RSPB), LI(VC43), UKBR(RSPB)	-
<i>Passer montanus</i>	Tree Sparrow	1	1105	1979	CAT1, S7, WBR(RSPB), LI(VC43), UKBR(RSPB)	historic record (1979)
<i>Recurvirostra avosetta</i>	Avocet	1	1105	2009	CAT1, BDir1, WCA1.1, Bern, WBAm(RSPB), UKBAm(RSPB)	-
<i>Streptopelia turtur</i>	Turtle Dove	1	1105	2003	CAT1, BDir22, S7, CITES, WBR(RSPB), UKBR(RSPB)	-
<i>Tringa ochropus</i>	Green Sandpiper	10	1105	2020	CAT1, WCA1.1, Bern, LBAP (CON, VOG), WBAm(RSPB), UKBAm(RSPB)	-
<i>Cossus cossus</i>	Goat Moth	2	1322	2011	CAT1, S7, LBAP (NEW)	-
<i>Locustella naevia</i>	Grasshopper Warbler	1	1322	2011	CAT1, S7, WBR(RSPB), UKBR(RSPB)	-
<i>Pyrgus malvae</i>	Grizzled Skipper	1	1322	2011	CAT1, S7, RDB1 (UK) - VU, LI(SEWBRc)	-
<i>Falco subbuteo</i>	Hobby	1	1822	2018	CAT1, WCA1.1, Bern, CITES, LI(VC43)	-
<i>Hydrocoloeus minutus</i>	Little Gull	1	1822	2020	CAT1, BDir1, WCA1.1, Bern, WBAm(RSPB)	-

TABLE 2: Summary of Aderyn Data Search Results: Species of Conservation Concern within 2km of the site at Greenmoor Nurseries.

Scientific Name	Common Name	No of Records	Distance of Closest Record (m)	Date of Most Recent record	Conservation Status	Notes
<i>Aegithalos caudatus</i>	Long-tailed Tit	79	341	2020	CAT2, WBAm(RSPB)	-
<i>Anas platyrhynchos</i>	Mallard	122	341	2020	CAT2, BDir21, WBAm(RSPB), UKBAm(RSPB)	includes 1 historic record (1983)
<i>Apus apus</i>	Swift	15	341	2019	CAT2, WBAm(RSPB), UKBAm(RSPB)	-
<i>Ardea cinerea</i>	Grey Heron	272	341	2020	CAT2, WBAm(RSPB)	includes historic records (back to 1976)
<i>Aythya fuligula</i>	Tufted Duck	22	341	2019	CAT2, BDir21, WBAm(RSPB)	-
<i>Butomus umbellatus</i>	Flowering-rush	5	341	2019	CAT2, RDB1 (Wales) - VU, LI(SEWBRc), LI(VC43), LI(VC51, LR), LI(VC52)	-
<i>Chenopodium glaucum</i>	Oak-leaved Goosefoot	3	341	2020	CAT2, RDB1 (Wales) - VU, RDB1 (UK) - VU, RDB2 (UK) - S	-
<i>Chloris chloris</i>	Greenfinch	12	341	2020	CAT2, Bern, WBAm(RSPB)	-
<i>Cynodon dactylon</i>	Bermuda-grass	1	341	2018	CAT2, RDB2 (UK) - R	-
<i>Fulica atra</i>	Coot	12	341	2019	CAT2, BDir21, WBAm(RSPB)	-
<i>Haematopus ostralegus</i>	Oystercatcher	69	341	2020	CAT2, BDir22, WBAm(RSPB), LI(VC43), UKBAm(RSPB)	includes records of nesting 1.1km from site
<i>Hirundo rustica</i>	Swallow	229	341	2022	CAT2, Bern, WBAm(RSPB)	includes records of nesting within 341m from site (2022)
<i>Hydaticus transversalis</i>	Hydaticus transversalis	13	341	2007	CAT2, RDB2 (UK) - S	includes 4 historic records (1985)
<i>Motacilla cinerea</i>	Grey Wagtail	5	341	2020	CAT2, Bern, WBAm(RSPB), UKBR(RSPB)	-
<i>Phalacrocorax carbo</i>	Cormorant	96	341	2020	CAT2, WBAm(RSPB)	-
<i>Picus viridis</i>	Green Woodpecker	23	341	2020	CAT2, Bern, WBAm(RSPB)	-
<i>Sagittaria sagittifolia</i>	Arrowhead	5	341	2018	CAT2, RDB1 (Wales) - VU, LI(SEWBRc)	-
<i>Turdus viscivorus</i>	Mistle Thrush	164	341	2019	CAT2, BDir22, Bern, WBAm(RSPB), UKBR(RSPB)	-
<i>Cercyon littoralis</i>	<i>Cercyon littoralis</i>	1	345	1997	CAT2, RDB2 (UK) - S	-
<i>Aderus populneus</i>	<i>Aderus populneus</i>	2	425	2020	CAT2, RDB2 (UK) - NB, RDB2 (UK) - S	-
<i>Lasius brunneus</i>	Brown Tree Ant	2	425	2020	CAT2, RDB2 (UK) - NA	-
<i>Vanonus brevicornis</i>	<i>Vanonus brevicornis</i>	2	425	2020	CAT2, RDB1 (UK) - VU, RDB2 (UK) - R	-
<i>Calamagrostis canescens</i>	Purple Small-reed	1	626	1981	CAT2, RDB1 (Wales) - VU	historic record (1981)
<i>Neoscia geniculata</i>	<i>Neoscia geniculata</i>	2	646	1985	CAT2, RDB2 (UK) - N	historic records (1985)
<i>Odacantha melanura</i>	<i>Odacantha melanura</i>	3	646	2019	CAT2, RDB2 (UK) - NB	includes 2 historic records (1985)

<i>Larus fuscus</i>	Lesser Black-backed Gull	20	649	2019	CAT2, BDir22, WBAAm(RSPB), UKBAAm(RSPB)	-
<i>Phylloscopus trochilus</i>	Willow Warbler	6	649	2019	CAT2, WBR(RSPB), , UKBAAm(RSPB)	-
<i>Tadorna tadorna</i>	Shelduck	100	649	2020	CAT2, Bern, WBAAm(RSPB), UKBAAm(RSPB)	-
<i>Tringa totanus</i>	Redshank	49	681	2020	CAT2, BDir22, WBAAm(RSPB), UKBAAm(RSPB)	includes 2 breeding records, nearest 681m; most recent 1996
<i>Beris clavipes</i>	Scarce Orange Legionnaire	3	695	1997	CAT2, RDB2 (UK) - N	-
<i>Odontomyia tigrina</i>	Black Colonel	8	695	2019	CAT2, RDB2 (UK) - N	includes 3 historic records (1985)
<i>Barbus barbus</i>	Barbel	2	723	2015	CAT2, HDir, RDB2 (UK)	-
<i>Oscinella angustipennis</i>	Oscinella angustipennis	1	723	1985	CAT2, RDB2 (UK) - N	historic record (1985)
<i>Helophorus laticollis</i>	New Forest Mud Beetle	2	738	2009	CAT2, RDB1 (UK) - EN	-
<i>Dytiscus circumcinctus</i>	Dytiscus circumcinctus	1	770	2007	CAT2, RDB2 (UK) - S	larva
<i>Colobaea distincta</i>	Colobaea distincta	2	784	1991	CAT2, RDB2 (UK) - N	-
<i>Curruca communis</i>	Whitethroat	11	787	2020	CAT2, WBR(RSPB)	-
<i>Wolffia arrhiza</i>	Rootless Duckweed	5	825	1985	CAT2, RDB1 (UK) - VU, RDB2 (UK) - S, LI(SEWBRc)	historic records (1985)
<i>Anas crecca</i>	Teal	27	880	2020	CAT2, BDir21, CITES, WBAAm(RSPB), LI(VC43), UKBAAm(RSPB)	-
<i>Anthus pratensis</i>	Meadow Pipit	10	880	2020	CAT2, Bern, WBAAm(RSPB), UKBAAm(RSPB)	-
<i>Cypha discoidea</i>	Cypha discoidea	1	880	2019	CAT2, RDB2 (UK) - NB	-
<i>Gallinago gallinago</i>	Snipe	10	880	2019	CAT2, BDir21, WBAAm(RSPB), LI(VC43), UKBAAm(RSPB)	-
<i>Gymnetron beccabungae</i>	Gymnetron beccabungae	1	880	2019	CAT2, RDB2 (UK) - NA	-
<i>Gymnetron villosulum</i>	Gymnetron villosulum	1	880	2019	CAT2, RDB2 (UK) - NB	-
<i>Larus canus</i>	Common Gull	10	880	2020	CAT2, BDir22, WBR(RSPB), UKBAAm(RSPB)	-
<i>Longitarsus lycopi</i>	Longitarsus lycopi	1	880	2019	CAT2, RDB2 (UK) - NB, RDB2 (UK) - S	-
<i>Mareca penelope</i>	Wigeon	18	880	2019	CAT2, BDir21, CITES, WBAAm(RSPB), UKBAAm(RSPB)	-
<i>Pedius longicollis</i>	Pedius longicollis	1	880	2019	CAT2, RDB2 (UK) - NB	-
<i>Peltodytes caesus</i>	Peltodytes caesus	2	880	2019	CAT2, RDB2 (UK) - S	includes 1 historic record (1985)
<i>Plateumaris bradata</i>	Plateumaris bradata	1	880	2019	CAT2, RDB2 (UK) - NA, RDB2 (UK) - S	-
<i>Pterostichus anthracinus</i>	Pterostichus anthracinus	1	880	2019	CAT2, RDB2 (UK) - NB	-
<i>Regulus regulus</i>	Goldcrest	7	880	2019	CAT2, Bern, WBAAm(RSPB)	-
<i>Stenolophus skrimshiranus</i>	Stenolophus skrimshiranus	1	880	2019	CAT2, RDB2 (UK) - NA	-
<i>Calidris alpina</i>	Dunlin	48	895	2020	CAT2, Bern, WBR(RSPB), LI(VC43), UKBAAm(RSPB)	-

<i>Calidris canutus</i>	Knot	18	895	2020	CAT2, BDir22, WBR(RSPB), UKBAm(RSPB)	includes 1 historic record (1955)
<i>Calidris ferruginea</i>	Curlew Sandpiper	8	895	2020	CAT2, Bern, WBAm(RSPB), UKBAm(RSPB)	-
<i>Pluvialis squatarola</i>	Grey Plover	13	895	2020	CAT2, BDir22, WBR(RSPB), UKBAm(RSPB)	-
<i>Spatula clypeata</i>	Shoveler	21	895	2020	CAT2, BDir21, CITES, WBAm(RSPB), UKBAm(RSPB)	-
<i>Arenaria interpres</i>	Turnstone	23	924	2018	CAT2, Bern, WBAm(RSPB), UKBAm(RSPB)	-
<i>Larus marinus</i>	Great Black-backed Gull	12	924	2020	CAT2, BDir22, WBR(RSPB), UKBAm(RSPB)	-
<i>Trifolium squamosum</i>	Sea Clover	2	924	1994	CAT2, RDB2 (UK) - S	-
<i>Oscinella angularis</i>	Oscinella angularis	1	979	1985	CAT2, RDB2 (UK) - N	historic record (1985)
<i>Chlorops planifrons</i>	Chlorops planifrons	1	985	1985	CAT2, RDB2 (UK) - N	historic record (1985)
<i>Corixa affinis</i>	Corixa affinis	2	1005	1985	CAT2, RDB2 (UK) - S	historic records (1985)
<i>Hygrotus parallelogrammus</i>	Hygrotus parallelogrammus	1	1005	1985	CAT2, RDB2 (UK) - NB, RDB2 (UK) - S	historic record (1985)
<i>Actitis hypoleucos</i>	Common Sandpiper	6	1105	2019	CAT2, WBR(RSPB), UKBAm(RSPB)	-
<i>Asio flammeus</i>	Short-eared Owl	3	1105	2016	CAT2, BDir1, Bern, CITES, WBR(RSPB), LI(VC43), UKBAm(RSPB)	-
<i>Asio otus</i>	Long-eared Owl	1	1105	2015	CAT2, Bern, CITES, WBAm(RSPB), LI(VC43)	-
<i>Calidris alba</i>	Sanderling	11	1105	2018	CAT2, Bern, WBAm(RSPB), UKBAm(RSPB)	-
<i>Lymnocyptes minimus</i>	Jack Snipe	1	1105	2008	CAT2, BDir21, WBAm(RSPB)	-
<i>Oenanthe oenanthe</i>	Wheatear	26	1105	2016	CAT2, Bern, WBAm(RSPB)	-
<i>Phoenicurus phoenicurus</i>	Redstart	2	1105	2015	CAT2, Bern, WBAm(RSPB), UKBAm(RSPB)	-
<i>Saxicola rubetra</i>	Whinchat	1	1105	2010	CAT2, Bern, WBR(RSPB), UKBR(RSPB)	-
<i>Stercorarius parasiticus</i>	Arctic Skua	2	1105	2015	CAT2, WBAm(RSPB), UKBR(RSPB)	-
<i>Aythya ferina</i>	Pochard	1	1322	2017	CAT2, BDir21, WBR(RSPB), UKBR(RSPB)	-
<i>Haliplus variegatus</i>	Haliplus variegatus	1	1322	1946	CAT2, RDB1 (UK) - VU	historic record (1946)
<i>Sterna hirundo</i>	Common Tern	1	1322	1991	CAT2, BDir1, Bern, WBAm(RSPB), UKBAm(RSPB)	-
<i>Sterna paradisaea</i>	Arctic Tern	1	1322	1991	CAT2, BDir1, Bern, WBR(RSPB), UKBAm(RSPB)	-
<i>Althaea officinalis</i>	Marsh-mallow	1	1822	2014	CAT2, RDB2 (UK) - S, LBAP (NEW), LI(SEWBRc)	-
<i>Riparia riparia</i>	Sand Martin	1	1822	2018	CAT2, Bern, WBAm(RSPB)	-

TABLE 3: Summary of Aderyn Data Search Results: Locally important species within 2km of Greenmoor Nurseries

Scientific Name	Common Name	Number of Records	Distance of Closest Record (m)	Date of Most Recent Record	Conservation Status	Notes
<i>Berula erecta</i>	Lesser Water-parsnip	13	103	2020	CAT3, LI(VC48, LR)	-
<i>Coenagrion puella</i>	Azure Damselfly	39	103	2019	CAT3, LI(BIS)	-
<i>Ischnura elegans</i>	Blue-tailed Damselfly	125	103	2020	CAT3, LI(BIS)	-
<i>Lemna gibba</i>	Fat Duckweed	13	103	2020	CAT3, LI(SEWBRcC), LI(VC47), LI(VC50, LR), LI(VC51, LR), LI(VC52, LR)	-
<i>Lemna trisulca</i>	Ivy-leaved Duckweed	9	103	2018	CAT3, LI(SEWBRcC), LI(VC43), LI(VC49, LR)	-
<i>Mentha aquatica</i>	Water Mint	6	103	2018	CAT3	-
<i>Phragmites australis</i>	Common Reed	22	103	2020	CAT3, LI(VC43), LI(VC47)	-
<i>Potamogeton crispus</i>	Curled Pondweed	2	103	1991	CAT3, LI(VC47), LI(VC48, LR), LI(VC49, LS)	-
<i>Potamogeton pectinatus</i>	Fennel Pondweed	3	103	1985	CAT3, LI(SEWBRcC), LI(VC43), LI(VC47), LI(VC48, LR), LI(VC49, LR)	-
<i>Ranunculus sceleratus</i>	Celery-leaved Buttercup	10	103	2020	CAT3, LI(VC43), LI(VC48, LS)	-
<i>Spirodela polyrhiza</i>	Greater Duckweed	13	103	2020	CAT3, LI(SEWBRcC), LI(VC47), LI(VC50, LS), LI(VC51, LR)	-
<i>Chaenorhinum minus</i>	Small Toadflax	1	125	2013	CAT3, LI(VC48, LS), LI(VC49, LS), LI(VC50, LS)	-
<i>Pungitius pungitius</i>	Nine-spined Stickleback	6	166	2007	CAT3	-
<i>Hydrocharis morsus-ranae</i>	Frogbit	11	169	2020	CAT3, RDB1 (Wales) - NT, RDB1 (UK) - VU, LI(VC47), LI(VC52, LR)	-
<i>Potamogeton pusillus</i>	Lesser Pondweed	4	169	1991	CAT3, LI(VC43), LI(VC47), LI(VC48, LR), LI(VC50, LR), LI(VC51, LR), LI(VC52)	-
<i>Acrocephalus schoenobaenus</i>	Sedge Warbler	47	341	2020	CAT3, LI(BIS)	-
<i>Aeshna cyanea</i>	Southern Hawker	84	341	2019	CAT3, LI(BIS)	-
<i>Aeshna juncea</i>	Common Hawker	11	341	2019	CAT3, LI(BIS)	-
<i>Anacamptis pyramidalis</i>	Pyramidal Orchid	1	341	2015	CAT3, LI(SEWBRcC), LI(VC47), LI(VC48, LS)	-
<i>Anax imperator</i>	Emperor Dragonfly	28	341	2019	CAT3, LI(BIS)	-
<i>Anser anser</i>	Greylag Goose	37	341	2019	CAT3, BDir21, WCA1.2, Bern, UKBAm(RSPB)	-
<i>Arctium lappa</i>	Greater Burdock	1	341	2018	CAT3, LI(VC47), LI(VC51, LR)	-
<i>Argynnis paphia</i>	Silver-washed Fritillary	3	341	2018	CAT3, LBAP (NEW), LI(SEWBRcC), LI(VC43)	-
<i>Bombus lucorum</i>	White-tailed Bumblebee	3	341	2016	CAT3	-

<i>Buteo buteo</i>	Buzzard	240	341	2020	CAT3, CITES	-
<i>Calopteryx</i>	Demoiselle damselflies	1	341	2015	CAT3, LI(SEWBRcC)	-
<i>Calopteryx splendens</i>	Banded Demoiselle	6	341	2016	CAT3, LI(BIS), LI(SEWBRcC)	-
<i>Calopteryx virgo</i>	Beautiful Demoiselle	5	341	2019	CAT3, LI(BIS), LI(SEWBRcC)	-
<i>Carduelis carduelis</i>	Goldfinch	47	341	2020	CAT3, Bern	-
<i>Carex acutiformis</i>	Lesser Pond-sedge	4	341	2018	CAT3, LI(VC47), LI(VC49, LS)	-
<i>Carex spicata</i>	Spiked Sedge	1	341	2018	CAT3, LI(VC43), LI(VC48, LR), LI(VC49, LS)	-
<i>Certhia familiaris</i>	Treecreeper	11	341	2016	CAT3, Bern	-
<i>Chenopodium ficifolium</i>	Fig-leaved Goosefoot	5	341	2020	CAT3, LI(VC49, LR), LI(VC50, LS)	-
<i>Chenopodium rubrum</i>	Red Goosefoot	1	341	2018	CAT3, LI(VC47), LI(VC49, LS), LI(VC51, LS), LI(VC52, LS)	-
<i>Cyanistes caeruleus</i>	Blue Tit	13	341	2020	CAT3, Bern	-
<i>Cygnus olor</i>	Mute Swan	157	341	2019	CAT3, BDir22, UKBAm(RSPB)	-
<i>Delichon urbicum</i>	House Martin	27	341	2019	CAT3, Bern, UKBAm(RSPB)	-
<i>Dendrocopos major</i>	Great Spotted Woodpecker	8	341	2020	CAT3, Bern	-
<i>Diplotaxis tenuifolia</i>	Perennial Wall-rocket	1	341	2017	CAT3, LI(SEWBRcC), LI(VC47), LI(VC49, LR), LI(VC50), LI(VC51, LS)	-
<i>Egretta garzetta</i>	Little Egret	165	341	2020	CAT3, BDir1, Bern, CITES	-
<i>Enallagma cyathigerum</i>	Common Blue Damselfly	132	341	2022	CAT3, LI(BIS)	-
<i>Epilobium roseum</i>	Pale Willowherb	1	341	2018	CAT3, LI(VC47), LI(VC49, LR)	-
<i>Geranium pusillum</i>	Small-flowered Crane's-bill	1	341	2017	CAT3, LI(SEWBRcC), LI(VC43), LI(VC48, LR), LI(VC49, LS), LI(VC51, LS), LI(VC52, LS)	-
<i>Glyceria maxima</i>	Reed Sweet-grass	16	341	2020	CAT3, LI(VC43), LI(VC49, LR)	-
<i>Hordeum secalinum</i>	Meadow Barley	2	341	2018	CAT3, LI(SEWBRcC), LI(VC43), LI(VC49, LS)	-
<i>Lactuca virosa</i>	Great Lettuce	1	341	2018	CAT3, LI(SEWBRcC), LI(VC50, LR)	-
<i>Lathyrus nissolia</i>	Grass Vetchling	8	341	2019	CAT3, LI(SEWBRcC), LI(VC43), LI(VC49, LR), LI(VC50, LS)	-
<i>Libellula depressa</i>	Broad-bodied Chaser	9	341	2019	CAT3, LI(BIS)	-
<i>Libellula quadrimaculata</i>	Four-spotted Chaser	7	341	2018	CAT3, LI(BIS)	-
<i>Lysimachia vulgaris</i>	Yellow Loosestrife	1	341	2014	CAT3, LI(VC47), LI(VC48, LS), LI(VC49, LS), LI(VC51, LS)	-
<i>Medicago arabica</i>	Spotted Medick	1	341	2018	CAT3, LI(SEWBRcC), LI(VC49, LS), LI(VC50, LR), LI(VC51, LR), LI(VC52, LR)	-
<i>Motacilla</i>	Motacilla	5	341	2011	CAT3	-
<i>Motacilla alba</i>	Pied Wagtail	212	341	2019	CAT3, Bern	-
<i>Motacilla alba yarrellii</i>	Pied Wagtail	3	341	2020	CAT3, Bern	-
<i>Mycelis muralis</i>	Wall Lettuce	3	341	2018	CAT3, LI(VC52, LS)	-

<i>Ophrys apifera</i>	Bee Orchid	6	341	2019	CAT3, CITES, LI(SEWBRcC), LI(VC47), LI(VC48, LR), LI(VC49, LS)	-
<i>Orchis mascula</i>	Early-purple Orchid	4	341	2019	CAT3, LI(VC47), LI(VC48, LS)	-
<i>Orthetrum cancellatum</i>	Black-tailed Skimmer	27	341	2022	CAT3, LI(BIS), LI(SEWBRcC)	-
<i>Periparus ater</i>	Coal Tit	14	341	2017	CAT3, Bern	-
<i>Persicaria bistorta</i>	Common Bistort	1	341	2013	CAT3, LI(VC48, LR), LI(VC49, LR)	-
<i>Phylloscopus collybita</i>	Chiffchaff	17	341	2020	CAT3	-
<i>Potamogeton trichoides</i>	Hairlike Pondweed	3	341	1991	CAT3, LI(VC43), LI(VC50, LR), LI(VC52, LS)	-
<i>Pulicaria dysenterica</i>	Common Fleabane	17	341	2021	CAT3, LI(VC48, LS)	-
<i>Pyrrhosoma nymphula</i>	Large Red Damselfly	13	341	2019	CAT3, LI(BIS)	-
<i>Salix alba</i>	White Willow	3	341	2018	CAT3, LI(VC49, LR)	-
<i>Salix caprea x cinerea = S. x reichardtii</i>	<i>Salix caprea x cinerea = S. x reichardtii</i>	2	341	2020	CAT3, LI(VC52, LR)	-
<i>Salix cinerea x aurita = S. x multinervis</i>	<i>Salix cinerea x aurita = S. x multinervis</i>	1	341	2018	CAT3, LI(VC51, LR)	-
<i>Seriphidium maritimum</i>	Sea Wormwood	1	341	2018	CAT3, LI(SEWBRcC), LI(VC49, LR), LI(VC52, LR)	-
<i>Sison amomum</i>	Stone Parsley	3	341	2018	CAT3, LI(SEWBRcC), LI(VC47), LI(VC49, LS)	-
<i>Stachys palustris</i>	Marsh Woundwort	2	341	2018	CAT3, LI(VC47)	-
<i>Sympetrum striolatum</i>	Common Darter	95	341	2018	CAT3, RDB1 (UK) - DD, LI(BIS)	-
<i>Tachybaptus ruficollis</i>	Little Grebe	15	341	2018	CAT3, LI(BIS), LI(VC43)	-
<i>Turdus merula</i>	Blackbird	21	341	2020	CAT3, BDir22,	-
<i>Ulmus procera</i>	English Elm	2	341	2018	CAT3, LI(VC48, LS)	-
<i>Catabrosa aquatica</i>	Whorl-grass	5	375	2004	CAT3, LI(SEWBRcC), LI(VC43), LI(VC47), LI(VC49, LR), LI(VC51, LR), LI(VC52, LS)	-
<i>Ceratophyllum demersum</i>	Rigid Hornwort	2	375	2013	CAT3, LI(SEWBRcC), LI(VC49, LR), LI(VC50, LR), LI(VC51, LR), LI(VC52, LS)	-
<i>Potamogeton berchtoldii</i>	Small Pondweed	7	375	1991	CAT3, LI(SEWBRcC), LI(VC43), LI(VC47), LI(VC48, LS), LI(VC49, LS), LI(VC51, LS)	-
<i>Juncus inflexus</i>	Hard Rush	11	405	2020	CAT3, LI(VC48, LR)	-
<i>Scrophularia auriculata</i>	Water Figwort	4	405	2014	CAT3, LI(VC48, LR), LI(VC52, LS)	-
<i>Bombus pascuorum</i>	Common Carder Bee	9	425	2021	CAT3	-
<i>Chorthippus albomarginatus</i>	Lesser Marsh Grasshopper	2	425	2020	CAT3	-
<i>Conocephalus dorsalis</i>	Short-winged Cone-head	3	425	2020	CAT3, LI(SEWBRcC)	-
<i>Carex otrubae</i>	False Fox-sedge	10	451	2020	CAT3, LI(VC43), LI(VC47)	-

<i>Coenagrion pulchellum</i>	Variable Damselfly	9	451	2019	CAT3, RDB1 (UK) - NT, LI(BIS), LI(SEWBRcC)	-
<i>Celastrina argiolus britanna</i>	Holly Blue	1	555	2014	CAT3	-
<i>Chara vulgaris</i>	Common Stonewort	1	556	1975	CAT3	Historic record
<i>Chara vulgaris var. vulgaris</i>	Chara vulgaris var. vulgaris	1	556	1975	CAT3	Historic record
<i>Dixella attica</i>	Dixella attica	3	564	2000	CAT3	-
<i>Ranunculus peltatus</i>	Pond Water-crowfoot	1	606	1991	CAT3, LI(VC47), LI(VC48, LS), LI(VC49, LS), LI(VC50, LS), LI(VC51, LS), LI(VC52, LS)	-
<i>Bolboschoenus maritimus</i>	Sea Club-rush	3	626	2014	CAT3, LI(VC47), LI(VC50, LS)	-
<i>Calamagrostis epigejos</i>	Wood Small-reed	1	626	1981	CAT3, LI(VC48, LR), LI(VC49, LR), LI(VC50, LR), LI(VC51, LR)	Historic record
<i>Rumex hydrolapathum</i>	Water Dock	1	626	1981	CAT3, LI(VC43), LI(VC47), LI(VC48, LS), LI(VC49, LR), LI(VC50, LS)	Historic record
<i>Typha angustifolia</i>	Lesser Bulrush	1	626	1981	CAT3, LI(SEWBRcC), LI(VC43), LI(VC48, LR), LI(VC49, LR), LI(VC50, LR), LI(VC52, LS)	Historic record
<i>Ranunculus baudotii</i>	Brackish Water-crowfoot	1	634	2017	CAT3, LI(VC47), LI(VC48, LR), LI(VC49, LR), LI(VC51, LS), LI(VC52, LS)	-
<i>Acrocephalus scirpaceus</i>	Reed Warbler	8	649	2020	CAT3, LI(VC43)	-
<i>Sylvia atricapilla</i>	Blackcap	8	649	2015	CAT3	-
<i>Nuphar lutea</i>	Yellow Water-lily	1	678	2015	CAT3, LI(SEWBRcC), LI(VC49, LR)	-
<i>Aeshna mixta</i>	Migrant Hawker	5	694	2022	CAT3, LI(BIS)	-
<i>Cyprinus carpio</i>	Common Carp	6	714	2016	CAT3, INNS	-
<i>Perca fluviatilis</i>	Perch	1	714	2015	CAT3	-
<i>Rutilus rutilus</i>	Roach	3	714	2015	CAT3	-
<i>Scardinius erythrophthalmus</i>	Rudd	1	714	2015	CAT3	-
<i>Esox lucius</i>	Pike	2	723	2015	CAT3	-
<i>Gasterosteus aculeatus</i>	Three-spined Stickleback	3	738	2009	CAT3	-
<i>Caloplaca aurantia</i>	Caloplaca aurantia	1	756	2009	CAT3, RDB1 (Wales) - LC, LI(VC42, R), LI(VC47, R)	-
<i>Catillaria lenticularis</i>	Catillaria lenticularis	1	756	2009	CAT3, RDB1 (Wales) - LC, LI(VC47, RU)	-
<i>Dirina massiliensis f. sorediata</i>	Dirina massiliensis f. sorediata	1	756	2009	CAT3, LI(VC47, RU)	-
<i>Myriolecis crenulata</i>	Myriolecis crenulata	1	756	2009	CAT3, RDB1 (Wales) - LC, LI(VC47, RU)	-
<i>Opegrapha calcarea</i>	Opegrapha calcarea	1	756	2009	CAT3, RDB1 (Wales) - LC, LI(VC42, RU)	-
<i>Abramis brama</i>	Common Bream	2	764	2015	CAT3	-
<i>Amphibia</i>	Amphibian	1	770	2007	CAT3	-

<i>Carex riparia</i>	Greater Pond-sedge	3	784	2013	CAT3, LI(SEWBRcC), LI(Vc43), LI(Vc47), LI(Vc48, LS), LI(Vc49, LS), LI(Vc50, LS), LI(Vc52)	-
<i>Abrostola tripartita</i>	Spectacle	6	787	2005	CAT3, LI(BIS)	-
<i>Acasis viretata</i>	Yellow-barred Brindle	2	787	2005	CAT3, LI(BIS)	-
<i>Apamea oblonga</i>	Crescent Striped	1	787	2005	CAT3	-
<i>Atolmis rubricollis</i>	Red-necked Footman	2	787	2005	CAT3, LI(BIS)	-
<i>Craniophora ligustri</i>	Coronet	2	787	2005	CAT3	-
<i>Cyclophora punctaria</i>	Maiden's Blush	2	787	2005	CAT3, LI(BIS)	-
<i>Eupithecia inturbata</i>	Maple Pug	2	787	2005	CAT3, LI(BIS)	-
<i>Idaea subsericeata</i>	Satin Wave	2	787	2005	CAT3	-
<i>Idaea trigeminata</i>	Treble Brown Spot	6	787	2005	CAT3	-
<i>Leucania obsoleta</i>	Obscure Wainscot	2	787	2005	CAT3	-
<i>Lithophane ornitopus</i>	Grey Shoulder-knot	2	787	2005	CAT3, LI(BIS)	-
<i>Parus major</i>	Great Tit	11	787	2015	CAT3, Bern	-
<i>Tetheella fluctuosa</i>	Satin Lutestring	2	787	2005	CAT3, LI(BIS)	-
<i>Venusia blomeri</i>	Blomer's Rivulet	1	787	2005	CAT3, LI(BIS)	-
<i>Bombus lapidarius</i>	Red-tailed Bumblebee	5	794	2022	CAT3	-
<i>Bombus pratorum</i>	Early Bumblebee	2	794	2003	CAT3	-
<i>Dipsacus fullonum</i>	Wild Teasel	12	824	2021	CAT3, LI(Vc48, LR)	-
<i>Berosus affinis</i>	Berosus affinis	3	825	1985	CAT3, LBAP (NEW)	Historic records
<i>Bidens tripartita</i>	Trifid Bur-marigold	5	825	1985	CAT3, LI(Vc47), LI(Vc48, LS), LI(Vc49, LR), LI(Vc50, LS), LI(Vc51, LS)	Historic records
<i>Galium mollugo</i>	Hedge Bedstraw	4	825	1985	CAT3, LI(Vc52)	Historic records
<i>Helochares lividus</i>	Helochares lividus	4	825	1985	CAT3, LBAP (NEW)	Historic records
<i>Veronica anagallis-aquatica</i>	Blue Water-speedwell	3	825	1985	CAT3, LI(SEWBRcC), LI(Vc43), LI(Vc47), LI(Vc48, LR), LI(Vc49, LR), LI(Vc50, LR), LI(Vc51, LR)	Historic records
<i>Veronica catenata</i>	Pink Water-speedwell	3	825	1985	CAT3, LI(SEWBRcC), LI(Vc43), LI(Vc47), LI(Vc48, LR), LI(Vc49, LR), LI(Vc50, LR)	Historic records
<i>Zannichellia palustris</i>	Horned Pondweed	6	825	1991	CAT3, LI(SEWBRcC), LI(Vc43), LI(Vc48, LR), LI(Vc49, LR), LI(Vc50, LR)	-
<i>Tetrix subulata</i>	Slender Ground-hopper	2	851	1997	CAT3, LI(SEWBRcC)	-

<i>Rorippa palustris</i>	Marsh Yellow-cress	1	861	2013	CAT3, LI(VC47), LI(VC48, LS), LI(VC49, LR), LI(VC51, LS), LI(VC52, LS)	-
<i>Columba oenas</i>	Stock Dove	4	880	2020	CAT3, BDir22, Bern, UKBA(m)(RSPB)	-
<i>Mareca strepera</i>	Gadwall	2	880	2019	CAT3, BDir21, UKBA(m)(RSPB)	-
<i>Bryum argenteum</i>	Silver-moss	5	895	2020	CAT3, RDB1 (Wales) - LC,	-
<i>Drepanocladus aduncus</i>	Kneiff's Hook-moss	2	895	2001	CAT3, RDB1 (Wales) - LC, LI(VC42, LR), LI(VC43, LR), LI(VC46, LR), LI(VC49, LR), LI(WWBIC)	-
<i>Kindbergia praelonga</i>	Common Feather-moss	6	895	2020	CAT3, RDB1 (Wales) - LC,	-
<i>Podiceps cristatus</i>	Great Crested Grebe	2	895	2018	CAT3, LI(VC43)	-
<i>Celastrina argiolus</i>	Holly Blue	3	915	2020	CAT3	-
<i>Atriplex glabriuscula</i>	Babington's Orache	1	923	2013	CAT3, LI(SEWBRcC), LI(VC48, LR), LI(VC50, LR), LI(VC51, LR)	-
<i>Beta vulgaris subsp. maritima</i>	Sea Beet	2	923	2013	CAT3, LI(VC48, LS)	-
<i>Raphanus raphanistrum subsp. maritimus</i>	Sea Radish	1	923	2013	CAT3, LI(VC48, LR), LI(VC49, LS), LI(VC50, LS), LI(VC52, LS)	-
<i>Agrimonia eupatoria</i>	Agrimony	2	924	2018	CAT3, LI(VC47)	-
<i>Anthus petrosus</i>	Rock Pipit	2	924	2014	CAT3, Bern	-
<i>Aster tripolium</i>	Sea Aster	2	924	2014	CAT3, LI(VC47), LI(VC50, LS)	-
<i>Brassica nigra</i>	Black Mustard	3	924	2014	CAT3, LI(VC48, LR)	-
<i>Festuca rubra subsp. litoralis</i>	Festuca rubra subsp. litoralis	1	924	1987	CAT3, LI(VC49, LR)	-
<i>Jacobaea erucifolia</i>	Hoary Ragwort	4	924	2020	CAT3, LI(VC47), LI(VC48, LR), LI(VC49, LS), LI(VC52, LS)	-
<i>Juncus gerardii</i>	Saltmarsh Rush	2	924	2014	CAT3, LI(VC47), LI(VC50, LR)	-
<i>Leontodon hispidus</i>	Rough Hawkbit	2	924	2015	CAT3, LI(VC52, LS)	-
<i>Matricaria chamomilla</i>	Scented Mayweed	9	924	2020	CAT3, LI(VC48, LS)	-
<i>Odontites vernus</i>	Red Bartsia	2	924	2021	CAT3, LI(VC47)	-
<i>Plantago coronopus</i>	Buck's-horn Plantain	6	924	2020	CAT3, LI(VC43), LI(VC47)	-
<i>Potentilla anglica x reptans = P. x mixta</i>	Hybrid Cinquefoil	1	924	2018	CAT3, LI(VC49, LR)	-
<i>Tripleurospermum inodorum</i>	Scentless Mayweed	6	924	2020	CAT3, LI(VC48, LS)	-
<i>Scutellaria galericulata</i>	Skullcap	2	956	2013	CAT3, LI(VC51, LR)	-
<i>Persicaria lapathifolia</i>	Pale Persicaria	1	958	2007	CAT3, LI(VC48, LS)	-
<i>Agrimonia procera</i>	Fragrant Agrimony	1	962	2020	CAT3, LI(SEWBRcC), LI(VC43), LI(VC47), LI(VC48, LS), LI(VC49, LR), LI(VC50, LR), LI(VC51, LS)	-
<i>Puccinellia distans subsp. distans</i>	Reflexed Saltmarsh-grass	3	962	2020	CAT3, LI(VC52)	-

<i>Spergularia marina</i>	Lesser Sea-spurrey	2	962	2013	CAT3, LI(SEWBRcC), LI(VC49, LS)	-
<i>Chenopodium polyspermum</i>	Many-seeded Goosefoot	2	967	2020	CAT3, LI(VC47), LI(VC49, LR), LI(VC50, LR), LI(VC51, LS), LI(VC52, LR)	-
<i>Carex elata</i>	Tufted-sedge	2	979	1985	CAT3, LI(SEWBRcC), LI(VC49, LR), LI(VC51, LR)	Historic records
<i>Gracilia minuta</i>	Gracilia minuta	1	979	1985	CAT3	Historic record
<i>Aloina ambigua</i>	Tall Aloe-moss	2	980	2020	CAT3, RDB1 (Wales) - LC, LI(VC41, EX), LI(VC44, LR), LI(VC45, LR), LI(VC48, LR), LI(VC49, LR), LI(VC50, LR), LI(VC52, EX), LI(WWBIC)	-
<i>Polypodium interjectum</i>	Intermediate Polypody	1	980	2020	CAT3, LI(VC51, LS)	-
<i>Rumex crispus x obtusifolius = R. x pratensis</i>	Rumex crispus x obtusifolius = R. x pratensis	3	980	2020	CAT3, LI(VC48, LS), LI(VC49, LR)	-
<i>Saxifraga tridactylites</i>	Rue-leaved Saxifrage	1	980	2020	CAT3, LI(VC47)	-
<i>Lysimachia nummularia</i>	Creeping-Jenny	1	984	2020	CAT3, LI(VC49, LS)	-
<i>Ranunculus circinatus</i>	Fan-leaved Water-crowfoot	1	985	1985	CAT3, LI(VC43), LI(VC47), LI(VC51, LR), LI(VC52, LS)	Historic record
<i>Ranunculus trichophyllus</i>	Thread-leaved Water-crowfoot	2	985	2013	CAT3, LI(VC47), LI(VC48, LR), LI(VC49, LS), LI(VC50, LS), LI(VC52, LS)	-
<i>Bombus terrestris</i>	Buff-tailed Bumblebee	3	995	2022	CAT3	-
<i>Puccinellia distans</i>	Reflexed Saltmarsh-grass	2	995	2020	CAT3, LI(SEWBRcC), LI(VC48, LR), LI(VC49, LR), LI(VC51, LS), LI(VC52, LR)	-
<i>Didymodon nicholsonii</i>	Nicholson's Beard-moss	1	1009	2020	CAT3, RDB1 (Wales) - LC, LI(BIS)	-
<i>Petroselinum segetum</i>	Corn Parsley	1	1009	1996	CAT3, LBAP (NEW), LI(SEWBRcC)	-
<i>Accipiter nisus</i>	Sparrowhawk	9	1105	2018	CAT3, CITES	-
<i>Athene noctua</i>	Little Owl	1	1105	2009	CAT3, Bern, CITES, LI(VC43)	-
<i>Branta bernicla</i>	Brent Goose	1	1105	2008	CAT3, BDir22, UKBAm(RSPB)	-
<i>Branta bernicla hrota</i>	Light-bellied Brent Goose	2	1105	2008	CAT3, BDir22, UKBAm(RSPB)	-
<i>Calidris minuta</i>	Little Stint	3	1105	2011	CAT3, Bern	-
<i>Callophrys rubi</i>	Green Hairstreak	1	1105	1979	CAT3	Historic record
<i>Carex distans</i>	Distant Sedge	1	1105	2004	CAT3, LI(VC47), LI(VC48, LS), LI(VC51, LR)	-
<i>Carex extensa</i>	Long-bracted Sedge	1	1105	2004	CAT3, LI(SEWBRcC), LI(VC49, LS), LI(VC50, LS), LI(VC51, LR)	-
<i>Corvus corax</i>	Raven	4	1105	2015	CAT3, LI(BIS)	-
<i>Curruca curruca</i>	Lesser Whitethroat	2	1105	2016	CAT3	-
<i>Leontodon saxatilis</i>	Lesser Hawkbit	1	1105	2018	CAT3, LI(VC47)	-
<i>Motacilla alba alba</i>	White Wagtail	3	1105	2015	CAT3, Bern	-

<i>Saxicola rubicola</i>	Stonechat	11	1105	2016	CAT3, Bern	-
<i>Schoenoplectus tabernaemontani</i>	Grey Club-rush	1	1105	1971	CAT3, LI(SEWBRcC), LI(Vc47), LI(Vc50, LR)	Historic record
<i>Ardea alba</i>	Great White Egret	1	1322	2014	CAT3, Bern, CITES, LI(BIS)	-
<i>Branta leucopsis</i>	Barnacle Goose	1	1322	2017	CAT3, BDir1, WCA9, Bern, UKBA(mRSPB), INNS	-
<i>Callimorpha dominula</i>	Scarlet Tiger	1	1322	2017	CAT3, LI(BIS)	-
<i>Callitriche obtusangula</i>	Blunt-fruited Water-starwort	1	1322	2013	CAT3, LI(SEWBRcC), LI(Vc43), LI(Vc47)	-
<i>Cantharellus cibarius</i>	Chanterelle	1	1322	2013	CAT3	-
<i>Cordulegaster boltonii</i>	Golden-ringed Dragonfly	1	1322	2022	CAT3, LI(BIS), LI(SEWBRcC)	-
<i>Hygrocybe conica</i>	Blackening Waxcap	2	1322	2017	CAT3	-
<i>Hygrocybe virginea</i> var. <i>virginea</i>	Snowy Waxcap	1	1322	2017	CAT3	-
<i>Lestes sponsa</i>	Emerald Damselfly	2	1322	2014	CAT3, LI(SEWBRcC), LI(Vc42), LI(Vc43), LI(Vc47), LI(Vc50)	-
<i>Melanargia galathea</i>	Marbled White	1	1322	2011	CAT3, LI(BIS)	-
<i>Spinus spinus</i>	Siskin	6	1322	2020	CAT3, Bern	-
<i>Sympetrum sanguineum</i>	Ruddy Darter	1	1322	2015	CAT3, LI(SEWBRcC), LI(Vc42), LI(Vc43), LI(Vc47), LI(Vc50)	-
<i>Barbarea vulgaris</i>	Winter-cress	1	1577	2013	CAT3, LI(Vc48, LS)	-
<i>Acer campestre</i>	Field Maple	1	1822	2014	CAT3, LI(Vc48, LS), LI(Vc49, LS)	-
<i>Apium graveolens</i>	Wild Celery	1	1822	2014	CAT3, LI(SEWBRcC), LI(Vc48, LS), LI(Vc49, LR), LI(Vc50), LI(Vc52, LS)	-
<i>Catapodium rigidum</i>	Fern-grass	1	1822	2014	CAT3, LI(Vc47)	-
<i>Cornus sanguinea</i>	Dogwood	1	1822	2014	CAT3, LI(Vc52, LS)	-
<i>Elytrigia atherica</i>	Sea Couch	1	1822	2014	CAT3, LI(Vc48, LR), LI(Vc49, LR), LI(Vc52, LS)	-
<i>Epilobium tetragonum</i>	Square-stalked Willowherb	2	1822	2015	CAT3, LI(Vc47), LI(Vc48, LR), LI(Vc49, LR)	-
<i>Glaux maritima</i>	Sea-milkwort	1	1822	2014	CAT3, LI(Vc47), LI(Vc50, LR)	-
<i>Iris foetidissima</i>	Stinking Iris	2	1822	2015	CAT3, LI(SEWBRcC), LI(Vc51, LS)	-
<i>Melilotus altissimus</i>	Tall Melilot	1	1822	2014	CAT3, LI(Vc49, LR)	-
<i>Plantago maritima</i>	Sea Plantain	1	1822	2014	CAT3, LI(Vc50, LS)	-
<i>Puccinellia maritima</i>	Common Saltmarsh-grass	1	1822	2014	CAT3, LI(Vc47), LI(Vc50, LR)	-
<i>Raphanus raphanistrum</i>	Radish	2	1822	2015	CAT3, LI(Vc50, LS)	-
<i>Spartina anglica</i>	Common Cord-grass	1	1822	2014	CAT3, LI(Vc50, LR), INNS	-
<i>Spergularia media</i>	Greater Sea-spurrey	1	1822	2014	CAT3, LI(SEWBRcC), LI(Vc48, LS), LI(Vc50, LS)	-

<i>Trifolium fragiferum</i>	Strawberry Clover	2	1822	2015	CAT3, LI(SEWBRcC), LI(Vc48, LS), LI(Vc50, LR), LI(Vc51, LS)	-
<i>Triglochin maritimum</i>	Sea Arrowgrass	1	1822	2014	CAT3, LI(Vc47), LI(Vc50, LR)	-
<i>Valerianella locusta</i>	Common Cornsalad	1	1822	2014	CAT3, LI(Vc50, LS)	-
<i>Veronica polita</i>	Grey Field-speedwell	1	1822	2014	CAT3, LI(SEWBRcC)	-
<i>Allium vineale</i>	Wild Onion	1	2013	2015	CAT3, LI(Vc47), LI(Vc48, LR), LI(Vc51, LS)	-
<i>Arum italicum</i>	Italian Lords-and-Ladies	1	2013	2015	CAT3	-
<i>Carex disticha</i>	Brown Sedge	1	2013	2015	CAT3, LI(SEWBRcC), LI(Vc43), LI(Vc48, LR), LI(Vc49, LR), LI(Vc50, LR), LI(Vc51, LS)	-
<i>Carex divulsa</i>	Carex divulsa	1	2013	2015	CAT3, LI(Vc47)	-
<i>Carex flacca</i>	Glaucous Sedge	1	2013	2015	CAT3, LI(Vc47)	-
<i>Carex strigosa</i>	Thin-spiked Wood-sedge	1	2013	2015	CAT3, LI(SEWBRcC), LI(Vc43), LI(Vc47), LI(Vc50, LR), LI(Vc51, LR)	-
<i>Carex sylvatica</i>	Wood-sedge	1	2013	2015	CAT3, LI(Vc47)	-
<i>Cichorium intybus</i>	Chicory	1	2013	2015	CAT3, LI(Vc49, LR), LI(Vc50, LS), LI(Vc51, LS)	-
<i>Lythrum salicaria</i>	Purple-loosestrife	1	2013	2015	CAT3, LI(Vc43), LI(Vc47)	-
<i>Narcissus pseudonarcissus</i> subsp. <i>pseudonarcissus</i>	Daffodil	1	2013	2015	CAT3, LBAP (TRF), LI(SEWBRcC), LI(Vc43)	-
<i>Polystichum setiferum</i>	Soft Shield-fern	1	2013	2015	CAT3, LI(Vc52)	-
<i>Vinca minor</i>	Lesser Periwinkle	1	2013	2015	CAT3, LI(Vc49, LS)	-
<i>Viola odorata</i>	Sweet Violet	1	2013	2015	CAT3, LI(Vc48, LR)	-

TABLE 4: Summary of Aderyn Data Search Results: Invasive Non-Native Species within 1km of Greenmoor Nurseries

Scientific Name	Common Name	Number of Records	Distance of closest record (m)	Date of most recent record	Conservation Status	Notes
<i>Crangonyx pseudogracilis</i>	Crangonyx pseudogracilis	3	132	2018	CAT4, INNS	-
<i>Azolla filiculoides</i>	Water Fern	1	341	2018	CAT4, WCA9, INNS	-
<i>Branta canadensis</i>	Canada Goose	30	341	2020	CAT4, BDir21, WCA9, INNS	-
<i>Harmonia axyridis</i>	Harlequin Ladybird	2	341	2016	CAT4, INNS	-
<i>Lemna minuta</i>	Least Duckweed	5	341	2020	CAT4, INNS	-
<i>Neovison vison</i>	American Mink	2	341	2018	CAT4, WCA9, INNS	-
<i>Parthenocissus quinquefolia</i>	Virginia-creeper	1	341	2018	CAT4, WCA9, INNS	-

<i>Sciurus carolinensis</i>	Eastern Grey Squirrel	4	341	2019	CAT4, WCA9, INNS	-
<i>Symphoricarpos albus</i>	Snowberry	1	341	2018	CAT4, INNS	-
<i>Crangonyx pseudogracilis/floridanus</i>	Crangonyx pseudogracilis/floridanus	6	345	2007	CAT4, INNS	-
<i>Buddleja davidii</i>	Butterfly-bush	2	425	2020	CAT4, INNS	-
<i>Fallopia japonica</i>	Japanese Knotweed	3	693	2018	CAT4, WCA9, INNS	-
<i>Potamopyrgus antipodarum</i>	Jenkins' Spire Snail	1	844	1985	CAT4, INNS	-
<i>Cygnus atratus</i>	Black Swan	1	924	2019	CAT4, WCA9, INNS	-
<i>Rosa rugosa</i>	Japanese Rose	1	924	2018	CAT4, WCA9, INNS	-
<i>Physella acuta</i>	Physella acuta	1	1005	1991	CAT4, INNS	-

Conservation Status Key

AONB: Area of Outstanding Natural Beauty; AW: Ancient Woodland; BAP: UK Biodiversity Action Plan; Local Biodiversity Action Plan; BDir1: EU Birds Directive Annexe 1; BDir2.1: EU Birds Directive Annexe 2.1; BDir2.2: EU Birds Directive Annexe 2.2; Bern: Bern Convention on the Conservation of European Wildlife and Natural Habitats; Bonn: Bonn Convention on the Conservation of Migratory Species of Wild Animals; CAT 1: Priority Species; CAT 2: Species of Conservation Concern; CAT 3: Locally Important Species; CAT 4: Invasive non-native Species; CITES: Convention on International Trade in Endangered Species of Wild Fauna and Flora; EPS: European Protected Species; HDir: EU Habitats Directive; INNS: Invasive Non-native Species; LBAP (NEW): Local Biodiversity Action Plan species Newport; LI: Locally Important within the listed area; VC35: Vice County area Monmot; LNR: Local Nature Reserve; MNR: Marine Nature Reserve; NNR: National Nature Reserve; NRW: Natural Resources Wales Priority Species; PBA: Protection of Badgers Act 1992; RD1(UK): Red Data Book listing for the UK based on IUCN guidelines; RD1(Wales): Red Data Book listing for Wales based on IUCN guidelines; RD2(UK): Red Data Book listing for the UK not based on IUCN guidelines; RIGS: Regionally Important Geodiversity Site; S7: Environment (Wales) Act 2016 (Section 7); SAC: Special Area of Conservation; SINC: Sites of Importance for Nature Conservation; SPA: Special Protection Area; SSSI: Site of Special Scientific Interest; UKBA: RSPB UK Birds Amber List (not based on IUCN criteria); UKBR: RSPB UK Birds Red List (not based on IUCN criteria); WBA: RSPB Welsh Birds Amber List (not based on IUCN criteria); WBR: RSPB Welsh Birds Red List (not based on IUCN criteria); WCA1.1: Wildlife & Countryside Act 1981 Schedule 1.1 (Birds which are protected at all times); WCA1.2: Wildlife & Countryside Act 1981 Schedule 1.2 (Birds which are protected at certain times); WCA5: Wildlife & Countryside Act 1981 Schedule 5 (Animals which are protected from killing and taking, possession, disturbance and sale); WCA8: Wildlife & Countryside Act 1981 Schedule 8 (Plants which are protected); WCA9: Wildlife & Countryside Act 1981 Schedule 9 (Non-native animals and plants which are established in the wild); WS: Wildlife Site; WVP: IUCN Threat Listing of Welsh Vascular Plants

Abbey Sanders Ecology

Chepstow

T: 07962 172453

E: asecology@hotmail.com

Abbey Sanders Chartered Ecologist BSc. MSc. CEcol CEnv MCIEEM