

First Floor Plan

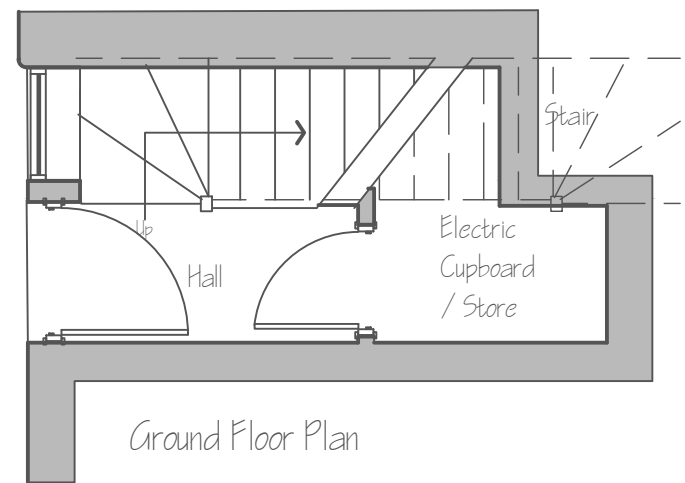

Ground Floor Plan

Description	Date

Project Client Mr G. Thomas Malpas Pharmacy	Project Title Change of Use First Floor, Flat 1 359 Malpas Road, Newport	Drawing Title Layouts as Proposed	THIS DRAWING IS COVERED BY COPYRIGHT WHICH REMAINS WITH HOWARD HICKS DESIGN AND MUST NOT BE REPRODUCED IN ANY FORM WITHOUT THEIR EXPRESS PERMISSION.	Scale 1:50	Date	Drawing No. PL03	Job No. 2219	Howard Hicks Design Architectural Designers. Technologists. Building Surveyors. Project Management 21 East Road, Oakfield, Torfaen, Cwmbran, Torfaen, Wales NP44 3DW Tel 01633 527159, Mob 07984 971763
				Drawn by HH	Checked	Status Planning	Rev.No.	