

This 'As Built' drawing has been produced based on information provided by Norwest Holst Construction Ltd

ATKINS

- Key**
- Existing Trees to be Retained
 - Proposed Grass Areas
 - Proposed Native Wildflower Meadow
 - Proposed Safety Surface Grass Matting
 - Proposed Shrub Planting
 - Proposed Woodland Planting Mix
 - Proposed Tree planting
 - Proposed Native Hedge

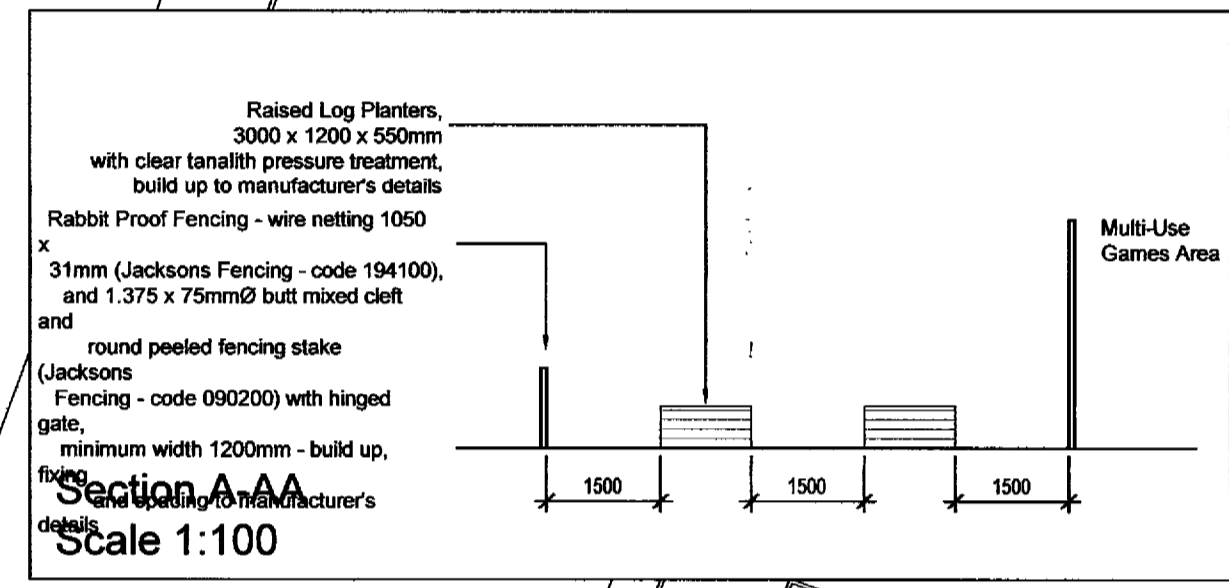
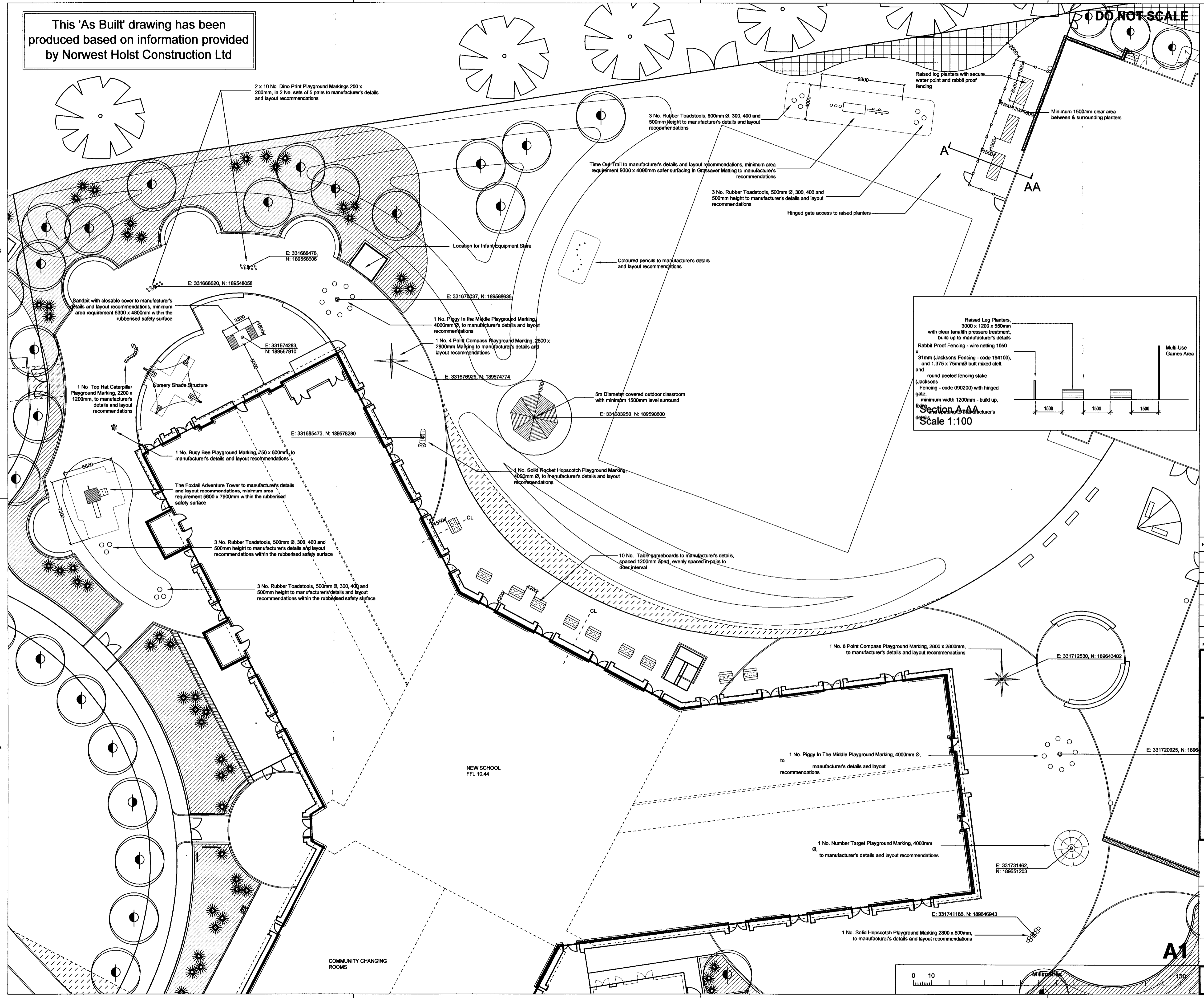

NOTES:
Manufacturer's details and product references as per Authority Change Notice 37 & 38

Rev.	Description	By	Date	CHK	Auth
B	AS BUILT ISSUE				
A	Amendments to as built conditions Busy Bee and Top Hat Caterpillar playground markings moved from nursery to infant play area	AL	28/10/09	NR	NR
A	Playground markings layout and selection updated as per Authority drawing Ref: 4903 RevD ACN Mark Up	AL	23/05/09	MD	MD

Rev.	Purpose of issue	Date	Authorised
B	AS BUILT	28/10/09	NR
A	INFORMATION	23/05/09	MD
O	INFORMATION	22/05/09	MD



WS Atkins Consultants Limited
Design, Environment & Engineering
160 Aztec West, Almondsbury, Bristol BS32 4TU.
Tel. 01454 201400 / Fax. 01454 201588

Project
Glebelands Development
St Julians
Newport

Title
Glan Usk School
AS BUILT
PLAY EQUIPMENT

Original Scale	Drawn	Checked	Authorised
1:200	AHL	MD	MD
	Date 18/08/09	Date 22/05/06	Date 22/05/09

Drawing Number	Rev
5041855 / LA / 4935	B