

This 'As Built' drawing has been produced based on information provided by Norwest Holst Construction Ltd

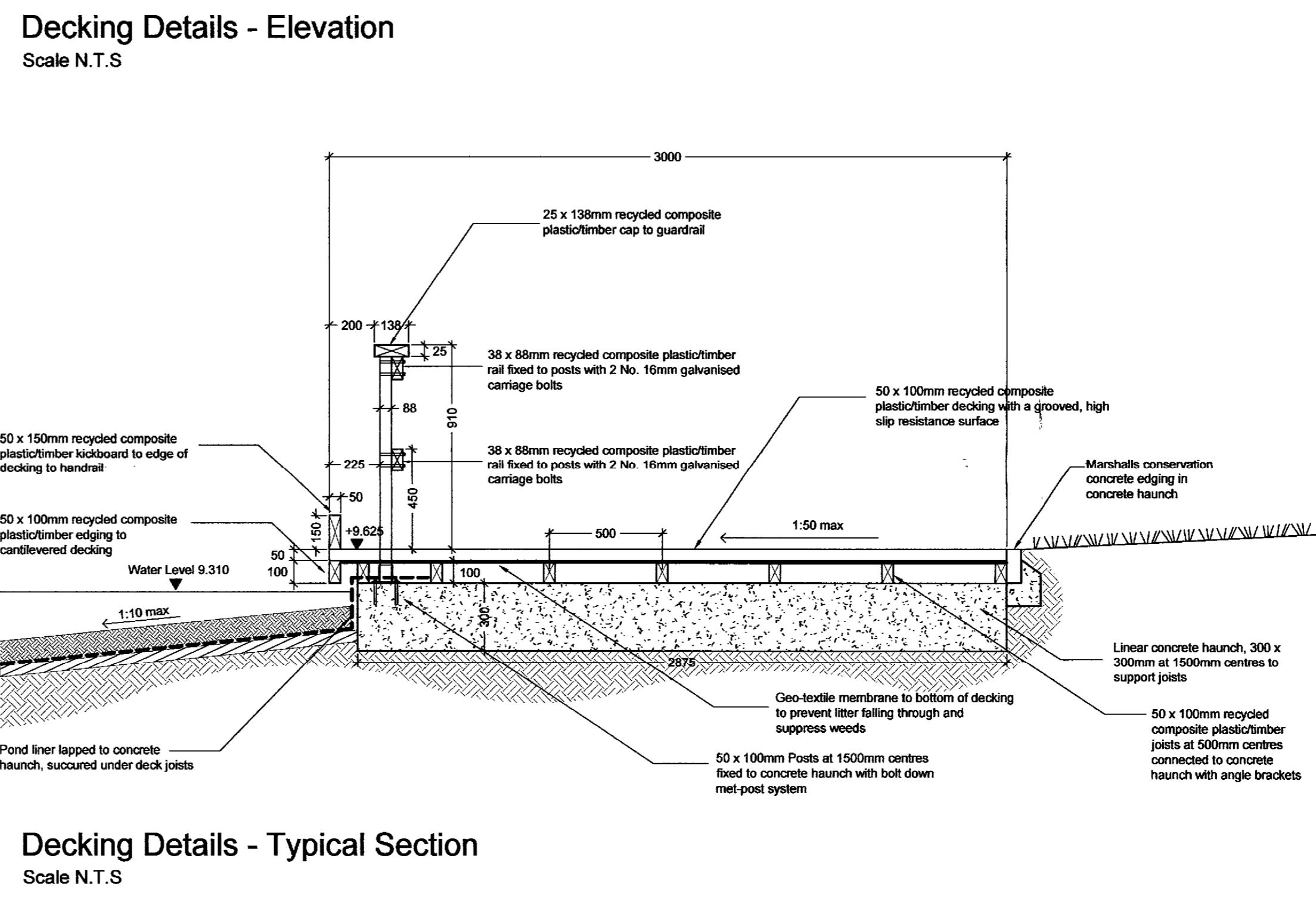
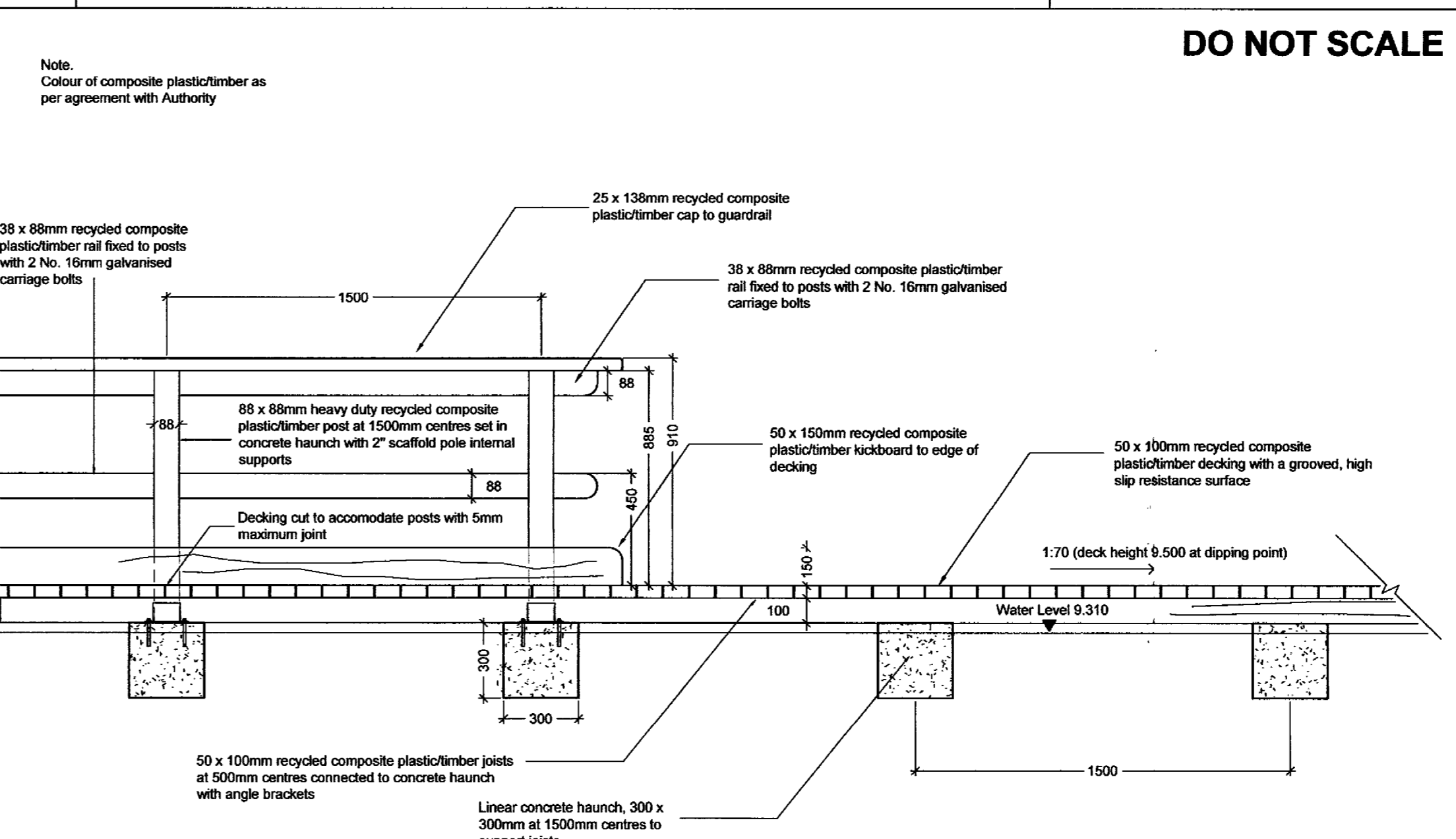
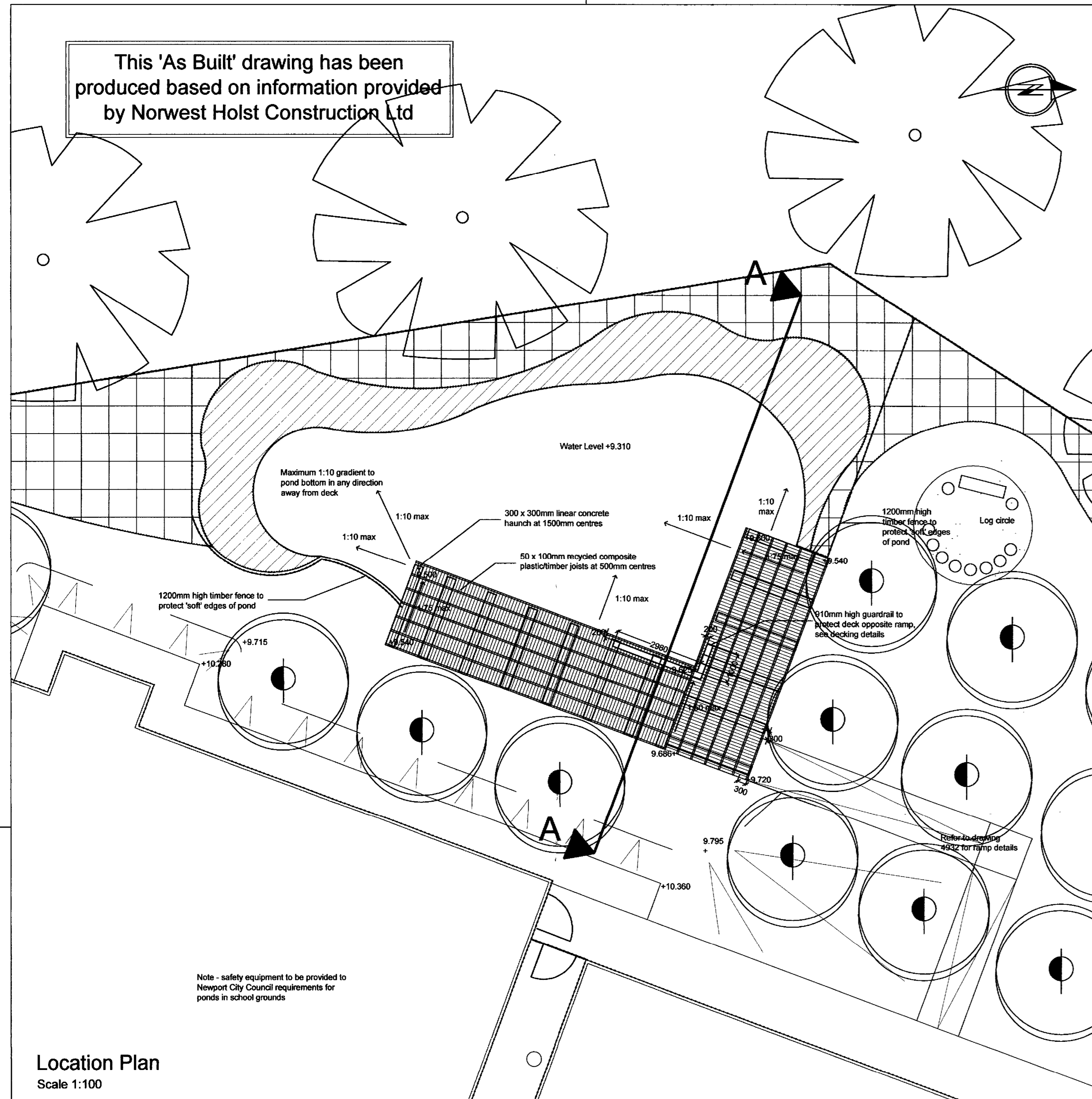

ATKINS

NOTE:
NOT FOR CONSTRUCTION, Plan issued for comment only

Rev	Description	By	Date	CHK'd	Auth
D	AS BUILT ISSUE	AL	28/10/09	NR	NR
C	Handrail details updated to manufacturer recommendations based on sketch provided by contractor.	AL	28/08/09	MD	MD
A	Levels added to decking plan, handrail detail amended, additional joist support added	AL	05/03/09	-	-
D	AS BUILT		28/10/09		NR
C	CONSTRUCTION		28/08/09		MD
B	PLANNING		29/05/09		NR
A	FOR COMMENT		05/03/09		COMMENT
O	FOR COMMENT		09/02/09		MD
Rev	Purpose of Issue	Date	Authorised		

Location Plan
Scale 1:100

Decking Details - Typical Section
Scale N.T.S

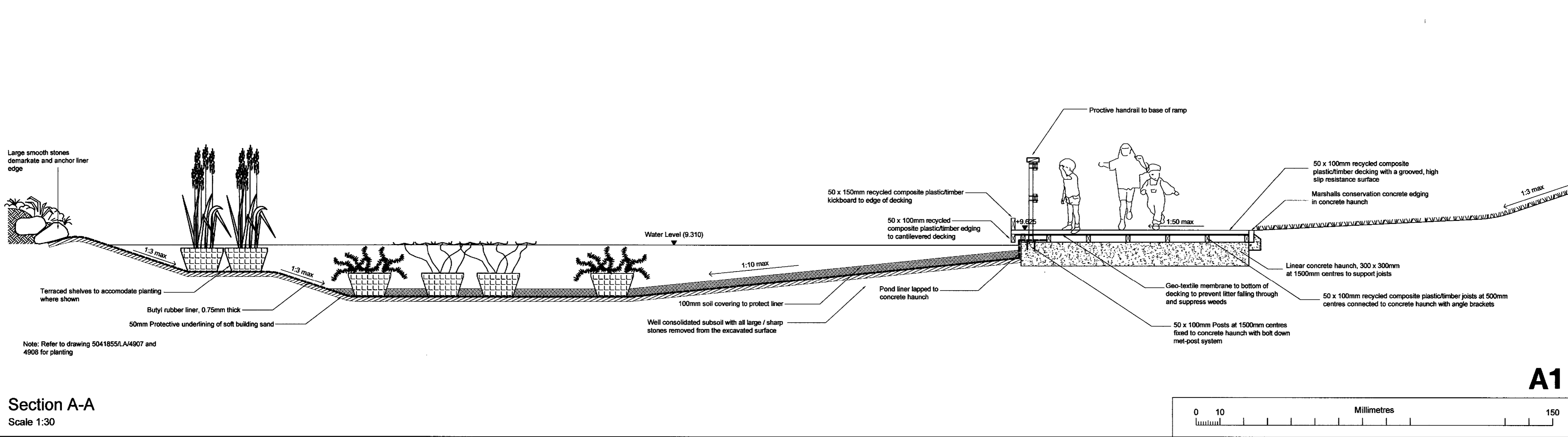

WS Atkins Consultants Limited
Design, Environment & Engineering
180 Aztec West, Almondsbury, Bristol. BS32 4TU.
Tel. 01454 201400 / Fax. 01454 201568

Project
Glebelands Development
St Julians
Newport

Title
Glan Usk School
AS BUILT
Deck Details

Original Scale	Drawn	Checked	Authorised	Rev
Var.	AHL	MD	NR	D
Drawing Number	Date	Date	Date	
5041855 / LA /	12/01/09	09/02/09	29/05/09	
4930				

