

Our Reference Number : 8150029769
 Your Reference Number : CONEX/13/1279



Wales & West House
 Spooner Close
 Celtic Springs
 Coedkemeu
 Newport NP10 8FZ

www.wwutilities.co.uk

FAO:

Garaint N Roberts
 Newport City Council
 Civic Centre
 Newport
 Cardiff
 NP20 4UR

Date : 24.12.2013
 Network Contact : Nic Musker
 Telephone : 02920 278912
 Fax : 0845 072 0852

Dear Garaint N Roberts

Re: Planning Application

Wales & West Utilities acknowledge receipt of your notice received on 23.12.2013, advising us of the planning application and proposals at:

Glan Usk Primary School, Herbert Road, Newport, Gwent, NP19 7HF

We enclose an extract from our mains records of the area covered by your proposals together with a comprehensive list of General Conditions for your guidance. This plan shows only those pipes owned by Wales & West Utilities in its role as a Licensed Gas Transporter (GT). Gas pipes owned by other GT's and also privately owned pipes may be present in this area. Information with regard to such pipes should be obtained from the owners. The information shown on this plan is given without obligation, or warranty and the accuracy thereof cannot be guaranteed. Service pipes, valves, syphons, stub connections, etc., are not shown but their presence should be anticipated. No liability of any kind whatsoever is accepted by Wales & West Utilities, its agents or servants for any error or omission.

Wales & West Utilities have no objections to these proposals, however our apparatus may be at risk during construction works and should the planning application be approved then we require the promoter of these works to contact us directly to discuss our requirements in detail. Should diversion works be required these will be fully chargeable.

If you have any queries please contact Nic Musker on 02920 278912 who will be happy to assist you.

Yours sincerely

Nigel Winnan
 Connections Manager
 Wales & West Utilities

24 hour gas escape number
 Rhif 24 awr os bydd nwy yn gollwng

0800 111 999*

*calls will be recorded and may be monitored
 callf galwadau eu recordio a gellir eu monitro



5SL200

Wales & West Utilities Limited

Registered Office:
 Wales & West House, Spooner Close, Coedkemeu, Newport NP10 8FZ
 Registered in England and Wales: No. 5048791

GENERAL CONDITIONS TO BE OBSERVED FOR THE PROTECTION OF APPARATUS AND THE PREVENTION OF DISRUPTION TO GAS SUPPLIES.

General conditions affecting the design, construction or maintenance of services and/or structures or other works in the vicinity of Wales & West Utilities' plant, pipelines and associated installations:

These general conditions apply only to the gas apparatus and pipes operated by Wales & West Utilities. It is possible that there may be other gas transporters with apparatus in the vicinity and you should ensure that you have made enquiries of them and have complied with their requirements.

1. Graphic Representation of Gas Mains

Any plans supplied or marked up by Wales & West Utilities will indicate the APPROXIMATE location of its apparatus. This information is provided as a general guide only; its accuracy cannot be guaranteed and is given without obligation or warranty. Service pipes are not shown but their presence should be anticipated. No liability whatsoever is accepted by Wales & West Utilities, its agents or servants for any error, omission, discrepancy or deviation.

Should you require assistance on site locating Wales & West Utilities' apparatus, please contact our Plant Protection Team on 02920-278912.

2. Methods of Working

The following methods of work shall not normally be permitted within the limits of distance indicated (relative to the established pipe position). Any variances must have prior consent from Wales & West Utilities:

Mechanical Excavation	3m (1m in respect of low pressure mains)		
Piling / Pile removing / Boring	15m	Hydraulic Testing	8 m
Welding or other hot works involving naked flame*	15m	Explosives	250m

Wales & West Utilities must be consulted prior to carrying out any excavation work within 10m of any above or below ground gas installations or pipeline. No excavation works may commence within 50m of a High Pressure or Very High Pressure Pipeline unless the pipeline has been located by tracing and its precise route identified.

* NOTE: Welding or other hot works involving naked flames shall be carried out at a safe distance to the satisfaction of a Wales & West Utilities Engineer. A check should be made prior to the commencement of works, to ensure a gas free atmosphere exists. It is also necessary to monitor the atmosphere at regular intervals for the duration of the works. In no case shall such activities take place in any Wales & West Utilities Easement without the written consent, and in the presence, of a Wales & West Utilities representative.

No work shall be undertaken near, nor heavy plant or equipment moved over, any gas pipeline or apparatus until all of the following conditions have been complied with.

Where Wales & West Utilities have apparatus in the vicinity of your work, any damage to it could have serious consequences. In view of this and in the interests of safety a meeting should be arranged before the commencement of work on site between Wales & West Utilities representatives, representatives of the promoting authority, the contractors, and any other interested parties. At this meeting the suggested program of site works and plant safety should be discussed. It is essential that this meeting is convened well in advance of commencement on site. Access to Wales & West Utilities' plant and facilities for inspection by Wales & West Utilities staff must not be affected. Where formal consent has been given, A MINIMUM OF SEVEN DAYS NOTICE IS REQUIRED before carrying out work in Wales & West Utilities easements, or the appropriate notice under the New Roads & Street Works Act where existing plant is situated within the public highway.

3. Proximity of Other Plant

A minimum clearance of 600 millimetres (mm) should be allowed between all plant being installed and an existing gas main operating above medium pressure (MP), whether the adjacent plant is parallel to or crossing the gas pipe. For mains operating at MP or below, this distance can be reduced to 300mm. **NO APPARATUS SHOULD BE LAID OVER AND ALONG THE LINE OF A GAS PIPE IRRESPECTIVE OF CLEARANCE.**

No manhole or chamber shall be built over or around a gas pipe and no work should be carried out which results in a reduction of cover or protection over a pipe without consultation with and the agreement of Wales & West Utilities staff.

4. Protection

Where any works cross or run in close proximity to Wales & West Utilities apparatus, periodic visits must be made by a linesman. His requests for protection or support to the apparatus shall be immediately observed.

Suitably designed crossing points are to be constructed to the satisfaction of a Wales & West Utilities Engineer. These crossing points shall be clearly indicated by the erection of buntings and crossings at other places should be prevented.

24 hour gas escape number
Rhif 24 awr os bydd nwy yn gollwng

0800 111 999*

*calls will be recorded and may be monitored
caiff galwadau eu recordio a gellir eu monitro



BSL200

Wales & West Utilities Limited

Registered Office:

Wales & West House, Spooner Close, Coedkernew, Newport NP10 8FZ
Registered in England and Wales: No. 5046791

Backfill material adjacent to Wales & West Utilities apparatus shall be soft fill or sand, containing no stones, bricks, or lumps of concrete etc., placed to a minimum 150mm around the mains and is to be well compacted by hand. No power consolidation shall take place above the main until 300mm of soft fill has been compacted by hand.

5. Damage to Coatings

Where a gas pipe is coated with special wrapping and this is damaged, even to a minor extent, Wales & West Utilities must be notified so that repairs can be made to prevent future corrosion and subsequent leakage. **WHERE MINOR DAMAGE TO COATING IS REPORTED TO WALES & WEST UTILITIES PRIOR TO BACKFILL THE NECESSARY REPAIR WILL BE MADE FREE OF CHARGE.**

6. Cathodic Protection

Where Wales & West Utilities apparatus is cathodically protected either by sacrificial anode or impressed current and where new apparatus is to be laid and is to be similarly protected, Wales & West Utilities will require to carry out interaction tests to determine whether its own system is adversely affected. The cost of any mutually agreed remedial action will be recharged to the authority installing the new apparatus. If any bond wires, test leads etc., used in connection with cathodic protection systems are damaged or found to be in poor condition, broken or disconnected, Wales & West Utilities must be notified prior to backfilling so that a repair can be made.

7. Hot Works

Even when a gas free atmosphere exists care must be taken when carrying out hot works in close proximity to gas plant in order to ensure that no damage occurs. Particular care must be taken to avoid damage by heat or naked flames to plastic gas pipes or to the protective coatings on other pipes.

8. Demolition

Live gas services must be disconnected PRIOR to demolishing any property, arrangements must be made for Wales & West Utilities to check for the presence of any live gas services.

9. Tree Planting

Wales & West Utilities must be contacted prior to all tree-planting works above or near our apparatus. Further information can then be made available.

10. Deep Excavations

Any work involving deep excavations (1.5m or more) will be subject to the "Model Consultative Procedure for Pipeline Construction involving Deep Excavations". This may require the diversion of Wales & West Utilities' apparatus prior to the commencement of your works. Detailed plans and cross sections will be required in order to determine the effect of these works on Wales & West Utilities' apparatus.

11. Leakage From Gas Mains or Services

If damage or leakage is caused or an escape of gas is smelt or suspected the following action should be taken at once:

- Remove all personnel from the immediate vicinity of the escape.
- Inform the Gas Emergency Service on 0800 111 999
- Prevent any approach by the public, prohibit smoking, and extinguish all naked flames or other sources of ignition at least 15 metres from the leakage. Do not operate any electrical switches in the vicinity of the escape.
- Assist gas personnel, Police and/or Fire Services as requested.

**IN THE EVENT OF A LEAK OBSERVE THE ABOVE BUT DO NOT ATTEMPT TO SEAL THE LEAK
REMEMBER - IF IN DOUBT, SEEK ADVICE FROM WALES & WEST UTILITIES.**

12. Building Proximities

There are minimum proximity distances for buildings from Wales & West Utilities' mains depending on both the operating pressure and the material of the main. Advice should be sought from Wales & West Utilities prior to building works taking place to confirm these distances.

Temporary buildings should not be placed above any gas pipe or within 3.0 metres of mains operating above 75mbar (medium, intermediate and high pressure mains) during construction activities and in no circumstances should permanent structures be built over any pipe transporting gas.

13. Site Responsibilities

All costs incurred by Wales & West Utilities for the repair of direct or consequential damage to gas plant will be rechargeable (with the exception of paragraph 5). Wales & West Utilities reserves the right to divert any affected apparatus or alternatively specify suitable protection of its apparatus if proved necessary during the course of site works, the cost of which will be chargeable.

The above requirements do not relieve you of the responsibility of taking all precautions necessary to safeguard the Company's plant and to avoid risk to persons and property. The persons for whom the works are being undertaken, their servants, agents and contractors shall indemnify Wales & West Utilities servants, agents and contractors against any loss, damage, expenses, claims and actions incurred or brought against Wales & West Utilities, its servants, agents and contractors in consequence of the provision of these works and activities associated therewith or ancillary thereto.

KEY TO MAPS

LP	Low Pressure	CI	Cast Iron
MP	Medium Pressure	SI	Spun Iron
IP	Intermediate Pressure	DI	Ductile Iron
HP	High Pressure	PE	Polyethylene
		ST	Steel

24 hour gas escape number
Rhif 24 awr os bydd nwy yn gollwng

0800 111 999*

*calls will be recorded and may be monitored
caiff galwadau eu recordio a gellir eu monitro



BSL200

Wales & West Utilities Limited

Registered Office:
Wales & West House, Spooner Close, Coedkew, Newport NP10 8FZ
Registered in England and Wales: No. 5046791

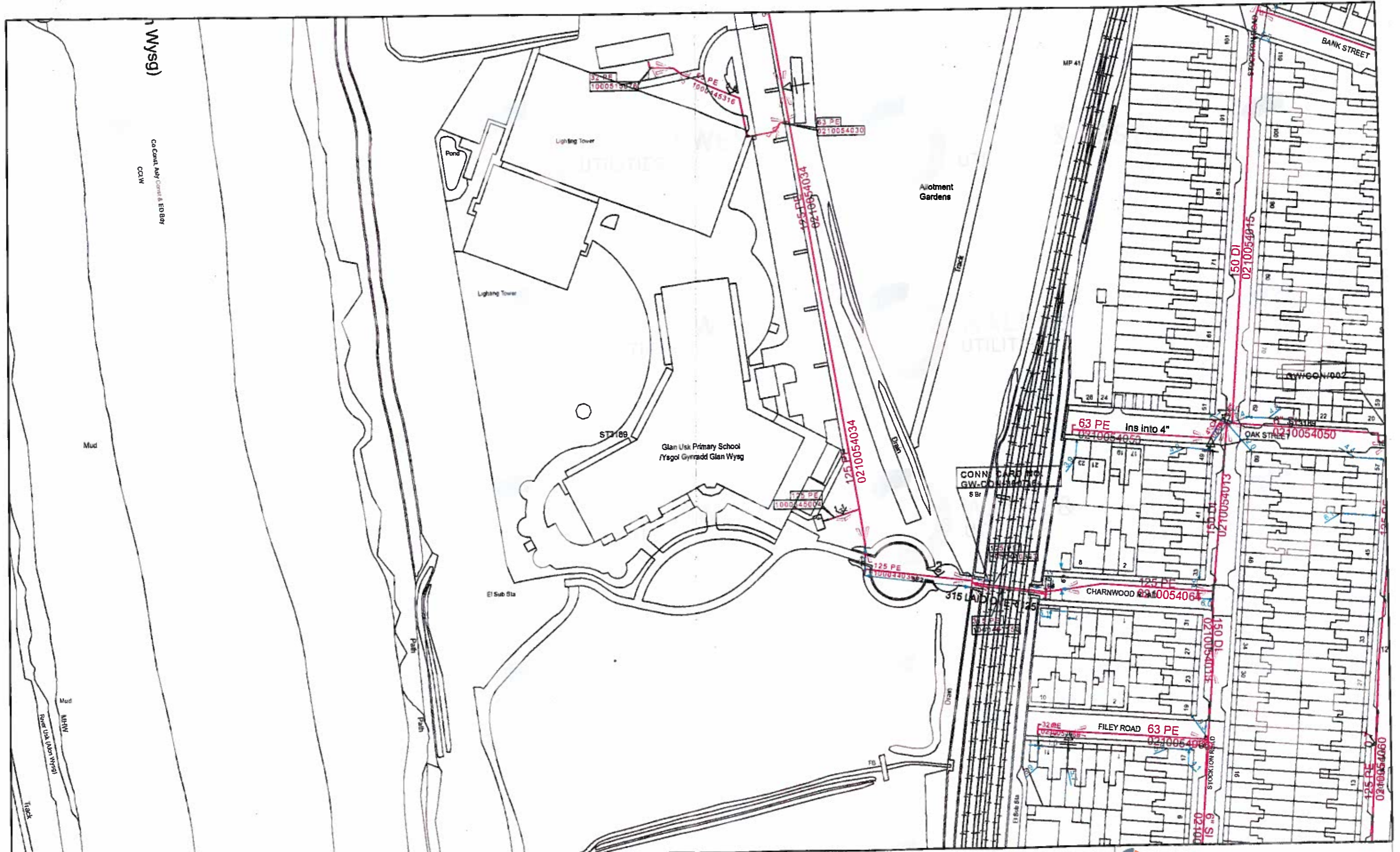

Scale	1 : 1250
User ID	Nic Musker
Date	23/12/2013
Grid Ref:	Eastings: 331724 Northings: 189585
NRSWA Response	

Low Pressure	Medium Pressure	Intermediate Pressure	High Pressure	IGT Other Polygon	Contact Zones	IITS Pipeline
Valve	Seal/Clamp	Syphon	Manhole	Change	Change	Change

TITLE:

The plan shows those pipes owned by Wales & West Utilities (WUU) in its role as a Licensed Gas Transporter (GT). The information shown on this plan is derived from historic information and may have involved re-scaling plans, and the accuracy of it cannot be guaranteed. Service pipes, valves, syphons, stub connections, etc. may not be shown but their presence should be anticipated. No warranties are therefore given in respect of it. WUU its employees and contractors do not accept any liability for any inaccuracy or incompleteness in it.

You must use safe digging practices, in accordance with HS(G)47, to establish the actual position of mains, pipes, services and other apparatus on site before any mechanical plant is used. It is your responsibility to ensure that this information is provided to all persons (either direct labour or contractors) working for you or near gas apparatus. The information shown on this plan should not be used beyond 28 days from the date of issue of this plan as it is subject to updating.

The plan also provides indications of gas pipes owned by other GTs, or otherwise privately owned, which may be present in this area. This information is not information of WUU and WUU is unable to verify this information or to confirm whether it is accurate or complete. It is supplied voluntarily to assist the user in determining whether to make contact with other GTs or others. The user must obtain such information from the other GT or person concerned. WUU, its employees and contractors do not accept any liability for this information or any inaccuracy or incompleteness in it.

WALES & WEST UTILITIES

Wales and West Utilities Ltd., Wales and West House, Spooner Close, Celtic Springs, Coedkemeu, Newport, NP10 6FZ

© All MasterMap data is reproduced by permission of Ordnance Survey on behalf of HMSO. © Crown copyright and database right 2013. All rights reserved. Ordnance Survey Licence number 0100044308.