

This 'As Built' drawing has been produced based on information provided by Norwest Holst Construction Ltd

DO NOT SCALE

ATKINS

NOTES:

- Bench heights as per Authority instruction:
- 260mm high to Nursey Play Area
 - 320mm high to Infant Play Area
 - 360mm high to Junior Play Area
 - 420mm to Covered Student Waiting Point

River Usk (Afon Wysg)

St Julians Glebelands
(Recreation Ground)

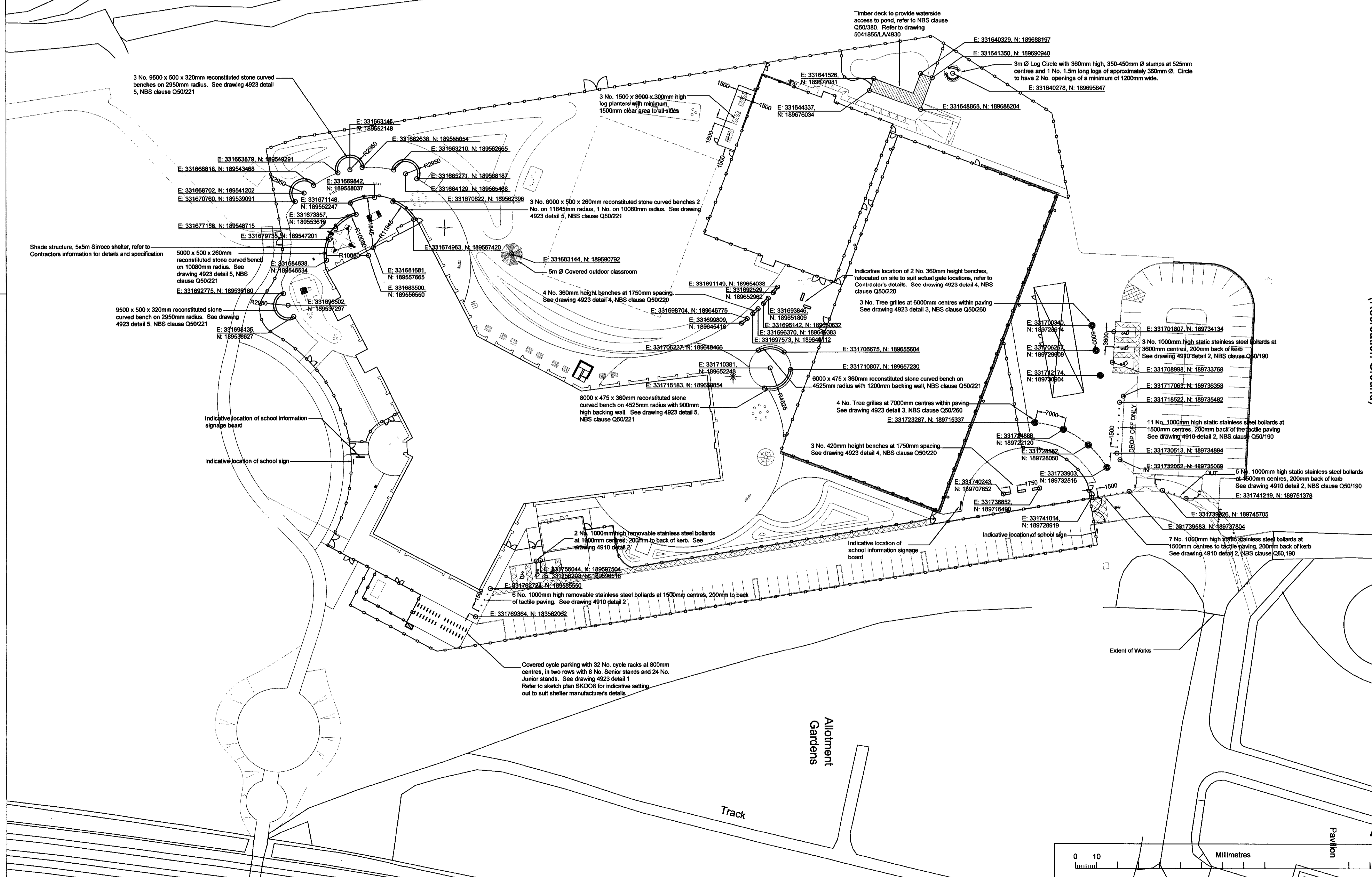

Rev	Description	By	Date	CHK	Auth
F	AS BUILT ISSUE				
E	Amendments to as built conditions: Letter bins removed, refer to Contractor's details for setting out to MUA shelter, seating and cycle racks due to alteration on site	AL	28/10/09	NR	NR
D	Bench to nursery reduced in length. Additional removable bollards added to MEVP access path. Indicative locations of school signage added	AL	31/07/06	MD	MD
C	Benches relocated as per ACN 08 034. Note to bench height added. Log Circle and raised planters added. Covered outdoor classroom relocated. Cycle rack ratio amended to Authority requirements.	AL	22/05/06	MD	MD
B	Recycling units relocated outside of building canopy. Note: bins to be kept clear of emergency vehicle access path.	AL	06/03/05	NR	NR

WS Atkins Consultants Limited
Design, Environment & Engineering
160 Aztec West, Almondsbury, Bristol. BS32 4TU.
Tel. 01454 201400 / Fax. 01454 201568

Project
Glebelands Development
St Julians
Newport

Title
Glan Usk School
AS BUILT
Site Furniture Plan

Original Scale	Drawn	Checked	Authorised
1:500	AHL	VM	VM
	Date 20/08/08	Date 06/09/08	Date 08/09/08
Drawing Number	5041855 / LA /	4922	Rev F