

NOTES

1. Tracking undertaken 15km/h forwards and 8km/h in reverse

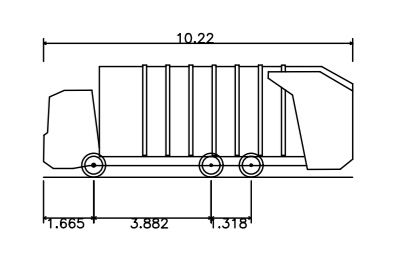

Phoenix 2-17N (with Elite 2 6x2 ML)
 Overall Width 2.30m
 Overall Length 4.20m
 Overall Body Height 2.00m
 Min. Body Ground Clearance 0.20m
 Track Width 1.80m
 Kerb to Kerb Turning Radius 10.55m

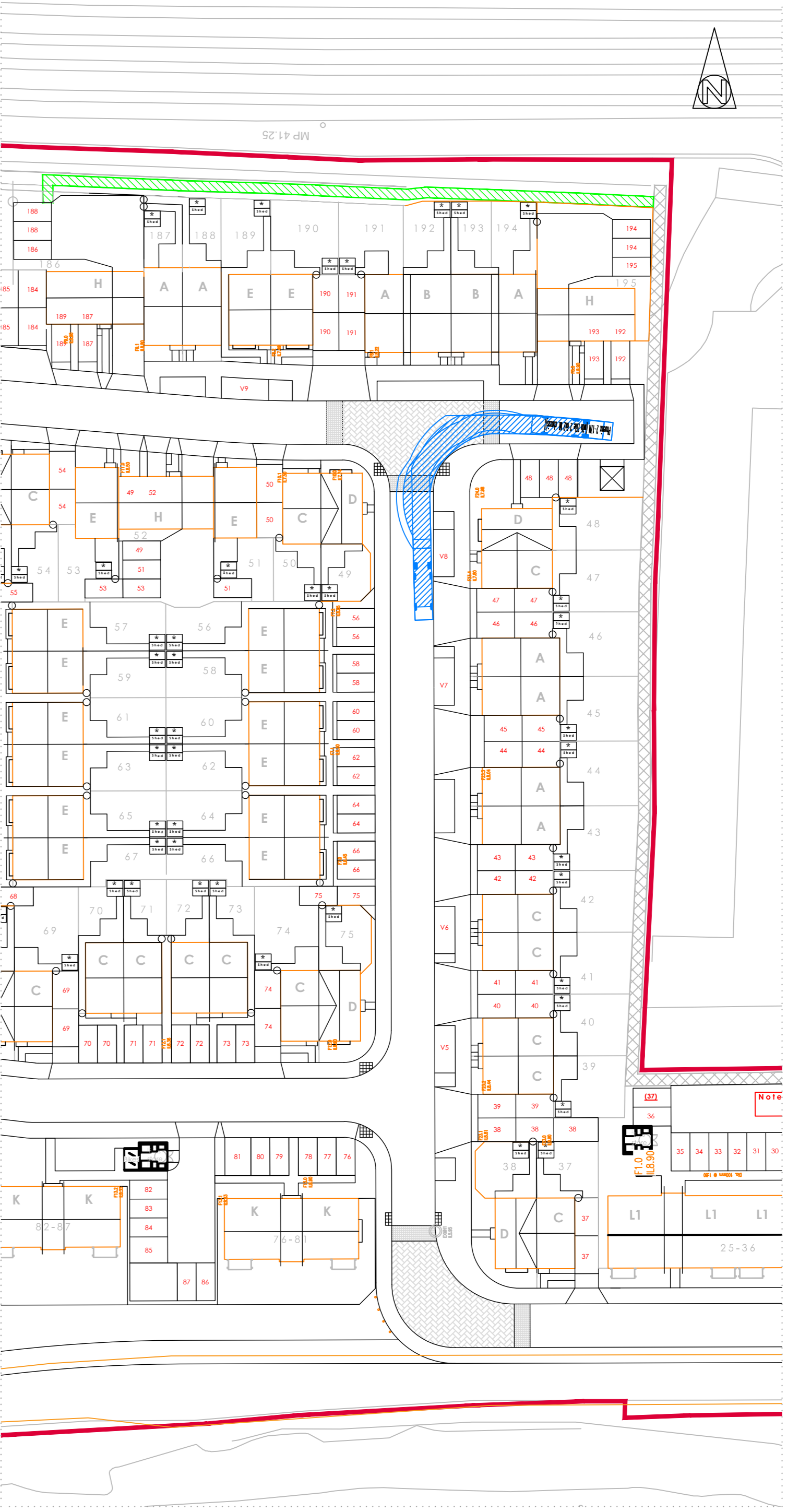
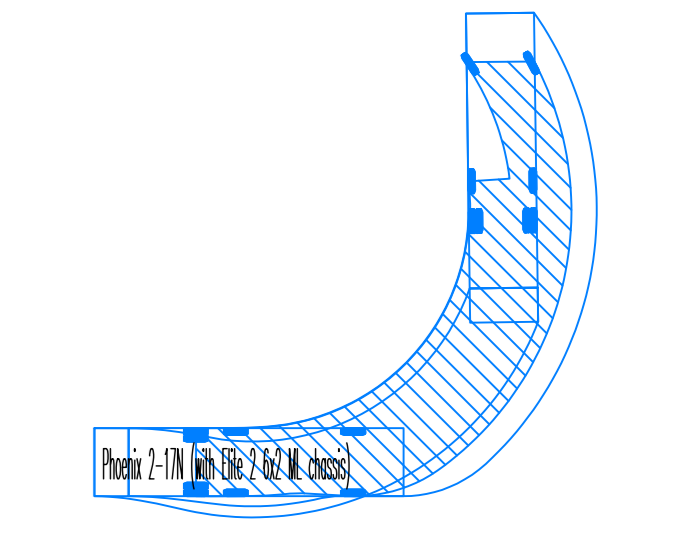

A	Sup 13	Minor Site Layout update following consultation.	CD	SD
Rev	Date	Comments	By	Appr

CLIENT:

phg CONSULTING ENGINEERS
 PHG CONSULTING LTD
 55A ALBERT ROAD
 CAMBRIDGE CB2 3RR
 T: +44(0)1223 302121
 E: info@phgconsulting.co.uk
 W: www.phgconsulting.co.uk

PROJECT: **Pobl Group Herbert Road, Newport**

DRAWING TITLE: **Refuse Vehicle Tracking Sheet 1 of 2**

Drawn	Chk	Status	SCALE
NC	SJD	For Approval	1:500 @ A0
Date	Issue No	Draw No	Rev
July'18	1795	002-1	