

This 'As Built' drawing has been produced based on information provided by Norwest Holst Construction Ltd

DO NOT SCALE

ATKINS

River Usk (Afon Wysg)

Kerbs and Edging Key

- S - Marshalls Standard Precast concrete Kerb 125mm Upstand, Half-battered
- S1 - Straight Kerb 125 x 255 x 915mm
- S2 - Drop Kerb Left or Right Hand Transition 125 x 255 / 150 x 915mm
- S3 - Drop Kerb Centre Straight Kerb 125 x 145 x 915mm
- S4 - 2000mm External Radius Kerb 125 x 255mm
- S5 - 3000mm External Radius Kerb 125 x 255mm
- S6 - Quadrant 305 x 305 x 255mm
- S7 - 6000mm External Radius Kerb 125 x 255
- E - Marshalls Conservation Concrete Edging 63 x 150 x 915mm Silver Grey
- C - Marshalls Conservation Concrete Setts 100 x 100 x 100mm Charcoal
- K - Marshalls Keyblock Concrete Block Paving 100 x 200 x 800mm laid in a soldier course to end of parking bays Buff

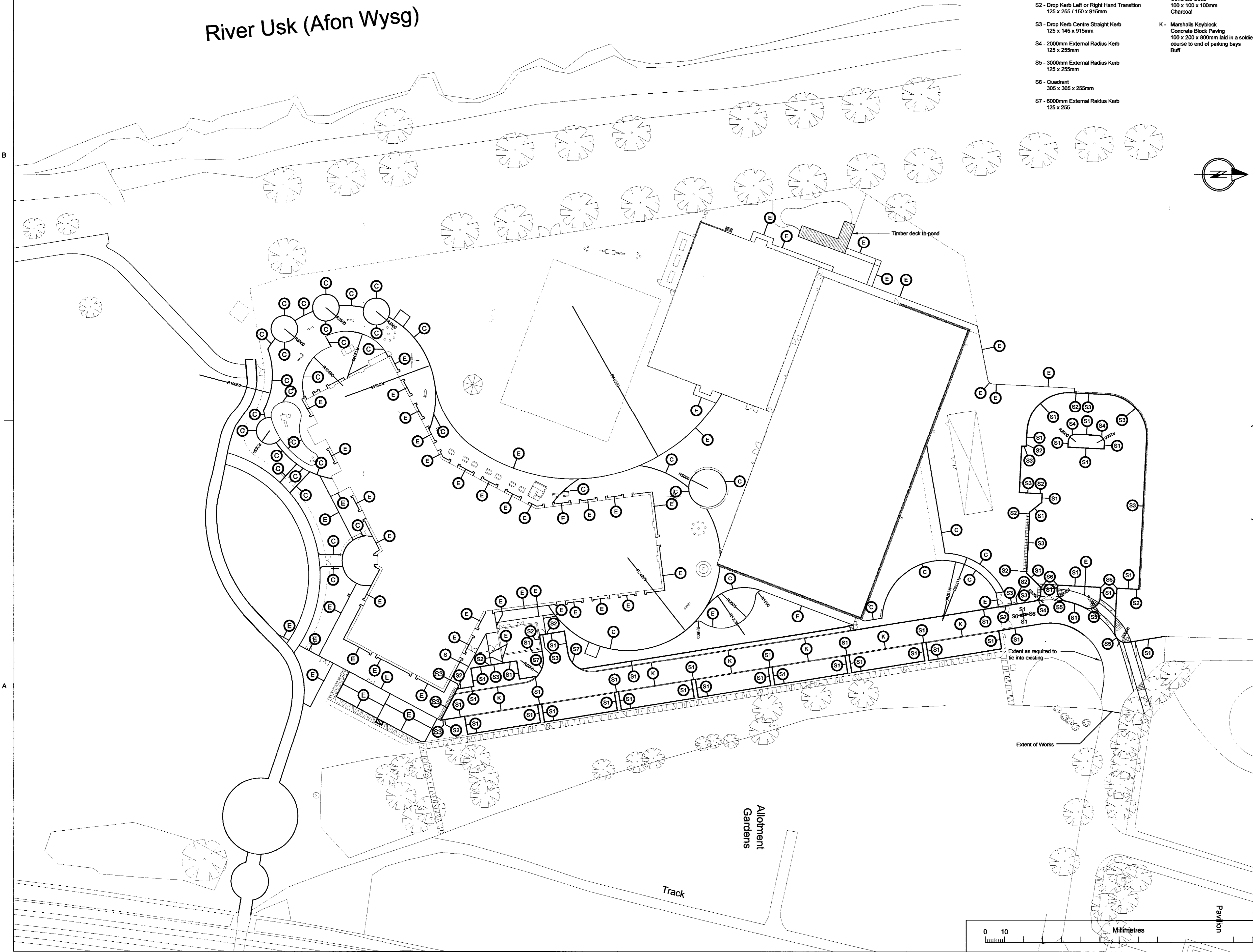

St Julian's Glebelands
(Recreation Ground)

Rev.	Description	By	Date	CHK'd	Auth
H	AS BUILT ISSUE	AL	28/10/09	NR	NR
G	Kerb arrangement amended to MEWP access	AL	04/08/09	MD	MD
E	Kerb to community car park amended to drop kerb	AL	15/05/09	NR	NR
D	Kerblines added to MUGA. Notes updated	AL	25/02/09	NR	NR
C	Kerb details to updated to amended sprinkler building layout	AL	17/11/08	NR	NR
B	Additional kerb and edging detail provided	AL	08/09/08	VM	VM

Rev.	Description	By	Date	CHK'd	Auth
H	AS BUILT		28/10/09		NR
G	CONSTRUCTION		04/08/09		MD
F	PLANNING		23/05/09		NR
E	CONSTRUCTION		15/05/09		NR
D	CONSTRUCTION		25/02/09		NR
C	CONSTRUCTION		17/11/08		NR
B	CONSTRUCTION		08/09/08		VM
A	CONSTRUCTION		06/06/06		NR



WS Atkins Consultants Limited
Design, Environment & Engineering
160 Aztec West, Almondsbury, Bristol. BS32 4TU.
Tel. 01454 201400 / Fax. 01454 201568

Project
Glebelands Development
St Julians
Newport

Title
Glan Usk School
AS BUILT
Kerb Layout and Details

Original Scale	Drawn	Checked	Authorised
1:500	AHL	NR	NR
Date	10/01/06	Date	23/03/06
Drawing Number	5041855 / LA /	4905	Rev H

